

0000

Hardin County, Ohio
Michael T. Bacon, Auditor

INVALID
2023

sale

Eff Rate:-

a/r

| | | |
|------------|---------|------|
| Tax Year | | CAMA |
| Prop Cls | | 511 |
| Acres | | |
| Land100% | 25270 | |
| Bldg100% | 154650 | |
| Totl100% | 179920t | |
| Cauv100% | | |
| Tax Value: | | |
| Land 35% | 8840 | |
| Bldg 35% | 54130 | |
| Totl 35% | 62970t | |
| Hmstd35% | | |
| Owner Oc | | |
| Hmstd RB | | |
| Net Tax | | |

| | | | | | | | | | |
|-----|-----|---|------|-------|---|-------|--|--|--|
| 1 B | F | M | 1548 | | H | *MAIN | | | |
| | F2 | G | 768 | 18430 | I | GRAGE | | | |
| | DK | P | 198 | 2970 | J | PORCH | | | |
| | BAL | P | 240 | 3600 | K | PORCH | | | |
| 1 B | F | A | 1299 | | L | ADDTN | | | |
| | STP | P | 72 | 290 | M | PORCH | | | |
| | OFF | P | 160 | 4800 | N | PORCH | | | |

| | | | | | | | | |
|------|---|------------|---------|-------------------|-----|--------|-------|--------|
| 306 | 1 | 2019-07-26 | JOLLIFF | JARROD J & SHELEY | 1SD | 122693 | 18060 | 94260 |
| 46 | 1 | 2019-02-19 | JOLLIFF | JOHN JAY | 1AF | 0 | 18060 | 94260 |
| 564 | 2 | 2004-12-07 | JOLLIFF | CAROL ANN | 2AF | 0 | 14370 | 149830 |
| 764 | 1 | 1994-08-22 | JOLLIFF | JOHN J & CAROL A | 1SD | 96000 | 0 | 82800 |
| 1144 | 2 | 1992-12-16 | JOLLIFF | JOHN J & CAROL A | 2DD | 0 | 0 | 71630 |

921 BLANCHARD RIVER MAINT XA/2023
500 HARDIN COUNTY LANDFILL XA/2023

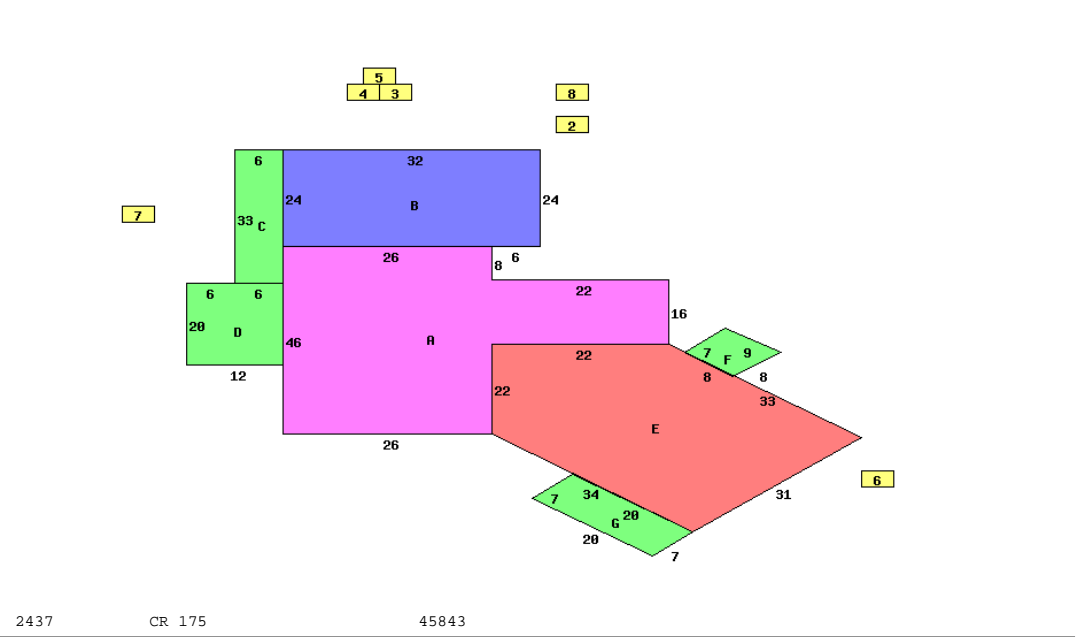

2437 CR 175 45843

| | | | | |
|---------------------------|-----------|------------------------|-------|--------|
| Occupancy 1 Single Family | | *DWELLING COMPUTATIONS | Sq-Ft | Value |
| Story Height 1 | | | | |
| Floor Level | Main | FRAME | 2847 | 181530 |
| | Basement | | 936 | 17480 |
| | Subtotal | | | 199010 |
| Shingle | Roof | GABLE | | |
| | B 1 2 U A | | | |
| Plaster/Drywall | X | Heating | | -3300 |
| Panelled Wall | X | Garages and Carports | | 18430 |
| Floor/Carpet | X | Extra Features | | 13820 |
| Floor/Tile-Lino | X | Total Value | | 227960 |
| Number of Rooms | 3 7 | | | |
| Bedrooms | 2 3 | | | |
| Plumbing | | PUB ELECTRIC | | |
| Standard | 1 | PRIV WATER | | |
| | | PRIV SEWER | | |
| | | PUB PAVED ST/RD | | |
| | | Neighborhood: | | |
| | | Code: | | 100 |
| | | Dwl/Gar/NC% | | 1.2500 |

| Bldg Type | SHB+Cons | DixHt | Area | Unit Rate | Grade | Blt/Renov | Replace | Phy Dpr | Fnc Dpr | True Value |
|--------------|----------|-------|------|-----------|-------|-----------|---------|---------|---------|------------|
| 1 DWELLING | 1 B F | 2847 | | | C+ | 1970AV | 250760 | .40 | .20 | 150460 |
| 2 Shed | | 16X24 | 384 | | D | 1979AV | 3690 | .65 | | 1290 |
| 3 Pole Build | | 20X24 | 480 | | D | OLD/FR | 4610 | .70 | | 1380 |
| 4 P | CAN0 | 6X16 | 96 | | D | 1975FR | 610 | .70 | | 180 |
| 5 Lean-To | | 14X16 | 224 | | D | 1975FR | 1430 | .70 | | 430 |
| 6 Shed | | 14X16 | 224 | | D | 1979AV | 2150 | .65 | | 750 |
| 7 Shed | *PP | 8X10 | 80 | | D | OLD/ | 0 | | | 0 |
| 8 Lean-To | | 6X12 | 72 | | D | 1979AV | 460 | .65 | | 160 |

| Tab # | S O I L | Acres | Mkt/Ac | Market | Au/Ac | Cauv |
|-------|---------|--------|--------|--------|--------|-------|
| 0 | | 1.0000 | | 15000 | 15000 | 15000 |
| 0 | | 2.0540 | | 10270 | 5000 | 10270 |
| | | 3.054 | | 25270 | (100%) | 25270 |
| | | | | 8840 | (35%) | 8840 |

CAUV #