

0000

Hardin County, Ohio
Michael T. Bacon, Auditor

INVALID
2023

sale

Eff Rate:-

a/r

Tax Year	CAMA
Prop Cls	511
Acres	
Land100%	25270
Bldg100%	154650
Totl100%	179920t
Cauv100%	
Tax Value:	
Land 35%	8840
Bldg 35%	54130
Totl 35%	62970t
Hmstd35%	
Owner Oc	
Hmstd RB	
Net Tax	

1 B	F	M	1548		H	*MAIN			
	F2	G	768	18430	I	GRAGE			
	DK	P	198	2970	J	PORCH			
	BAL	P	240	3600	K	PORCH			
1 B	F	A	1299		L	ADDTN			
	STP	P	72	290	M	PORCH			
	OFF	P	160	4800	N	PORCH			

306	1	2019-07-26	JOLLIFF	JARROD J & SHELEY	1SD	*	122693	18060	94260
46	1	2019-02-19	JOLLIFF	JOHN JAY	1AF	*	0	18060	94260
564	2	2004-12-07	JOLLIFF	CAROL ANN	2AF	*	0	149830	
764	1	1994-08-22	JOLLIFF	JOHN J & CAROL A	1SD	*	96000	0	82800
1144	2	1992-12-16	JOLLIFF	JOHN J & CAROL A	2DD	*	0	0	71630

921 BLANCHARD RIVER MAINT XA/2023
500 HARDIN COUNTY LANDFILL XA/2023

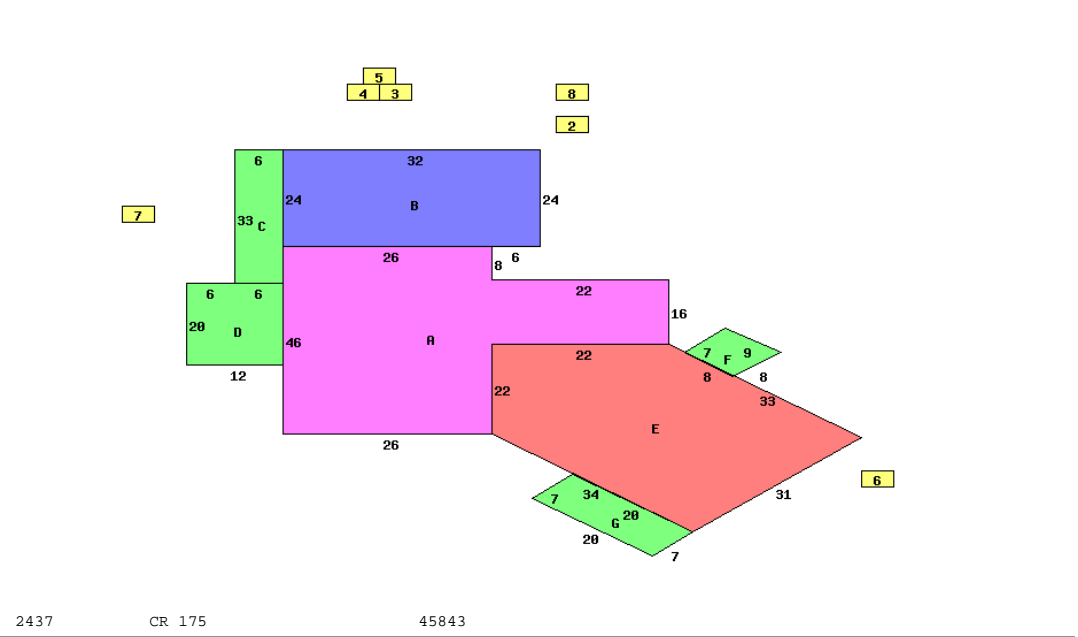

2437 CR 175 45843

Occupancy 1 Single Family	*DWELLING COMPUTATIONS	
Story Height 1	Sq-Ft	Value
Floor Level		
	Main	FRAME
	Basement	
	Subtotal	
Shingle	Roof	GABLE
	B 1 2 U A	
Plaster/Drywall	X	Heating -3300
Panelled Wall	X	Garages and Carports 18430
Floor/Carpet	X	Extra Features 13820
Floor/Tile-Lino	X	Total Value 227960
Number of Rooms	3 7	
Bedrooms	2 3	
Plumbing		PUB ELECTRIC
Standard	1	PRIV WATER
		PRIV SEWER
		PUB PAVED ST/RD
		Neighborhood:
		Code: 100
		Dwl/Gar/NC% 1.2500

Bldg Type	SHB+Cons	DixHt	Area	Unit Rate	Grade	Blt/Renov	Replace	Phy Dpr	Fnc Dpr	True Value
1 DWELLING	1 B F	2847			C+	1970AV	250760	.40	.20	150460
2 Shed		16X24	384		D	1979AV	3690	.65		1290
3 Pole Build		20X24	480		D	OLD/FR	4610	.70		1380
4 P	CAN0	6X16	96		D	1975FR	610	.70		180
5 Lean-To		14X16	224		D	1975FR	1430	.70		430
6 Shed		14X16	224		D	1979AV	2150	.65		750
7 Shed	*PP	8X10	80		D	OLD/	0			0
8 Lean-To		6X12	72		D	1979AV	460	.65		160

Tab #	S O I L	Acres	Mkt/Ac	Market	Au/Ac	Cauv
0		1.0000		15000	15000	15000
0		2.0540		10270	5000	10270
		3.054		25270	(100%)	25270
				8840	(35%)	8840

CAUV #

Call Back:

Sign: PSN Date: 2015-10-20 Lister:

01-090013.0000-v082020R