

MCDONALD USV RHD FIRE DISTRICT

00305

Hardin County, Ohio  
Michael T. Bacon, Auditor

45-340018.0000  
G02

AGR  
2025

sale

Eff Rate:- 44.45 — 40.66 — 39.34 — 39.29 — a/r

2022 ZACK KEITH ETAL	2006-08-10				
2023 ZACK KEITH ETAL	2006-08-10				
2024 ZACK KEITH ETAL	2006-08-10				
2025 ZACK KEITH ETAL	2006-08-10	10010	102.442A		
3205 CR 200	1AF				
BELLE CENTER OH 43310	\$0				

Tax Year	2022	2023	2024	2025	CAMA
Prop Cls	111	111	111	111	111
Acres	102.4400	102.4400	102.4400	102.4400	
Land100%	493490	543570	543570	543570	543570
Bldg100%	55890	73230	73230	73230	73220
Totl100%	549370t	616800t	616800t	616800t	616790t
Cauv100%	92940	204510	204510	204510	204520
Tax Value:					
Land 35%	32530	71580	71580	71580	190250
Bldg 35%	19560	25630	25630	25630	25630
Totl 35%	52090t	97210t	97210t	97210t	215880t
Hmstd35%	19660	26610	26610	26610	
Owner Oc	20.58	23.18	22.02	22.04	
Hmstd RB	343.14	332.92	344.98	356.78	hmstd 6300 l 20310 b
Net Tax	1733.38	3257.92	3135.34	3118.70	
Cauv Sav	5643.96	4411.84	4275.50	4269.64	
Sp-Asmnt	247.71	204.29	335.89	443.40	

SHB+	CONS	TYPE	FACT	SQ-FT	VALUE	a	*MAIN
1H	F	M		448		b	PORCH
	EFP	P		128	5120	c	ADDTN
1	F/C	A		504		d	OTHER
04	F	O		80	960	e	PORCH
	OPF	P		168	5040	f	PORCH
	DK	P		36	540		

TURBINE T-33 4110-C CR 190 ACCESS LANE SCIOTO RIDGE WIND FARM

Sale#	#p	sale date	To	Type/Invalid?	Sale\$	co:land	co:blgd
335	1	2006-08-10	ZACK KEITH ETAL	1AF *	0	195770	54940
135	1	2001-03-29	ZACK KEITH ETAL	1AF *	0	142490	34490
181	1	1995-03-13	SHAFFER WILLIS MELVIN ET	WD	0	71910	24000
180	1	1995-03-13	WATKINS DAVID R TRUSTEE	WD	0	71910	24000
1097	1	1992-11-30		LWD *	3638	0	104910
895	1	1992-09-25		1CT *	0	0	109710

Year	Land	Bldg	Total	Net Tax
2021	32710	19560	52270	1839.66
2020	32710	19560	52270	1865.00

p r o j e c t		ben acres	/ %	factor
902	MAIN DISTRICT CONSERVANCY			XA/2025
147	KILLOUGH #919 SCIOTO RIVER M			XA/2025
324	HARPSTER - SCIOTO RIVER			XA/2025
500	HARDIN COUNTY LANDFILL			XA/2025

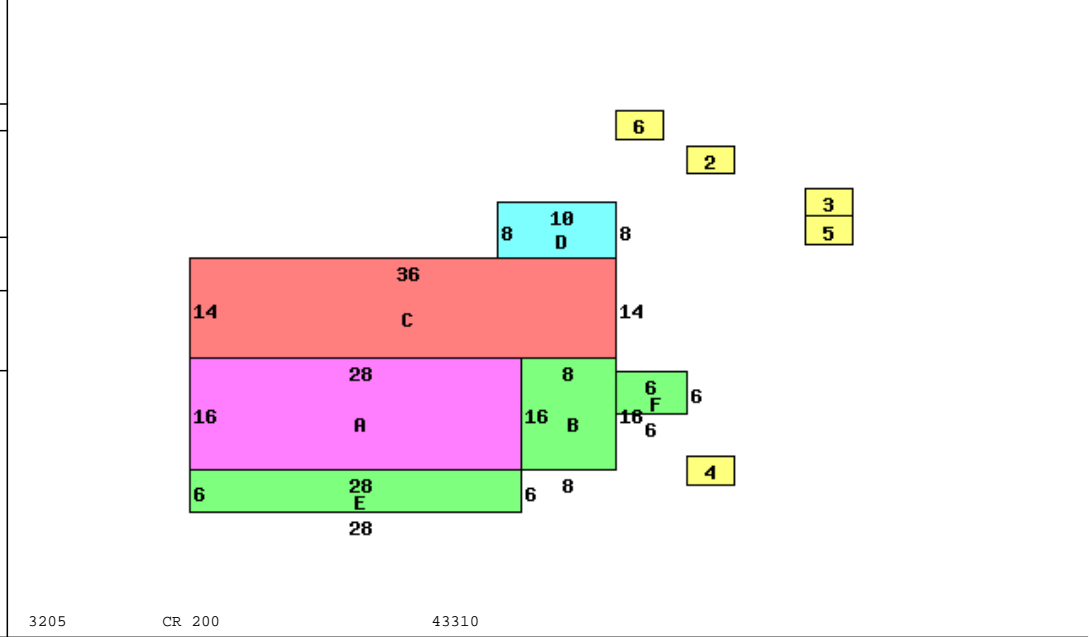

3205 CR 200 43310

Occupancy 1 Single Family		*DWELLING COMPUTATIONS	
Story Height	1H	Sq-Ft	Value
Floor Level	Main	FRAME	952 99940
	Part Upper	FRAME	448 24730
	Subtotal		124670
Metal	Roof	GABLE	
	B 1 2 U A		
Plaster/Drywall	X X	Air Conditioning	2500
Floor/Carpet	X	Extra Features	11660
Floor/Tile-Lino	X X	Total Value	138830
Number of Rooms	4 2		
Bedrooms	1 1	PUB ELECTRIC	
		PRIV WATER	
Central Heat	A	PRIV SEWER	
FORCED AIR		PUB PAVED ST/RD	
Central A/C	A	Topo: ROLLING	
Plumbing		Neighborhood:	
Standard	1	Code:	3100
		Dwl/Gar/NC%	1.1800

Bldg Type	SHB+Cons	DixHt	Area	Unit Rate	Grade	Blt/Renov	Cond	Replace Value	Phy Dpr	Fnc Dpr	True Value
1 DWELLING	1T F	1400	2400		C-	OLD/FR		124950	.65		51600
2 Pole Build		40X60	2400		C	2004AV		28800	.50		14400
3 Crib/Grana	*SV 0	24X62	1200			OLD/PR		600			600
4 Garage		24X27	648		C	1989AV		15550	.65		6420
5 Lean-To	*SV	14X32	0			1900PR		200			200
6 Shed	*PP	8X10	80			OLD/		0			0
7 ABATE2099	*740		0			2022		6000			0
Tab #	S O I L	Acres	Mkt/Ac	Market	Au/Ac	Cauv					
C 1	BOA BLOUNT SILT LOAM 0-	2.7067	6030	16320	2660	7200					
C 2	BOB BLOUNT SILT LOAM, 2	49.3420	5770	284700	2360	116450					
C 4	CA CARLISLE MUCK	1.2045	7410	8930	3140	3780					
C 14	GWB GLYNWOOD SILT LOAM	7.5976	5400	41030	1750	13300					
C 15	GYB2 GLYNWOOD CLAY LOAM	13.9804	5020	70180	1230	17200					
C 16	GYC2 GLYNWOOD CLAY LOAM	4.7462	4750	22540	1050	4980					
C 30	MRD2 MORLEY CLAY LOAM 12	2.7359	4670	12780	350	960					
C 39	PM PEWAMO SILTY CLAY L	3.8314	6490	24870	3560	13640					
C 51	WSTL WASTE LAND	1.0200	120	120	50	50					
W 2	BOB BLOUNT SILT LOAM, 2	8.3075	3130	26000	470	3910					
W 14	GWB GLYNWOOD SILT LOAM	4.4322	2830	12540	750	3320					
W 39	PM PEWAMO SILTY CLAY L	1.0356	5370	5560	1670	1730					
671	HSITE HOMESITE	1.0000	18000	18000	18000	18000					
900	WIND TURBINE LAND	.5000									
		102.44		543570	(100%)	204520	CAUV # 593				
				190250	( 35%)	71580					

Call Back: Sign: PSN Date: 2014-10-27 Lister: 45-340018.0000-v082020R