

MCDONALD USV RHD FIRE DISTRICT

00305

Hardin County, Ohio  
Michael T. Bacon, Auditor

45-291007.0000  
F28

RES  
2025

sale

Eff Rate:- 44.45 — 40.66 — 39.34 — 39.29 — a/r

|                           |                           |
|---------------------------|---------------------------|
| 2022 BUTTERFIELD CLOVIS D | 2016-06-13                |
| 2023 BUTTERFIELD CLOVIS D | 2016-06-13                |
| 2024 BUTTERFIELD CLOVIS D | 2016-06-13                |
| 2025 BUTTERFIELD CLOVIS D | 2016-06-13 S7 PT 13 1.00A |
| 17055 TR 39               | 1AT                       |
| BELLE CENTER OH 43310     | \$0                       |

|            |         |         |         |         |                      |
|------------|---------|---------|---------|---------|----------------------|
| Tax Year   | 2022    | 2023    | 2024    | 2025    | CAMA                 |
| Prop Cls   | 510     | 510     | 510     | 510     | 510                  |
| Acres      | 8800    | 12570   | 12570   | 12570   | 12560                |
| Land100%   | 79630   | 103910  | 103910  | 103910  | 103910               |
| Bldg100%   | 88430t  | 116490t | 116490t | 116490t | 116470t              |
| Totl100%   |         |         |         |         |                      |
| Cauvl00%   |         |         |         |         |                      |
| Tax Value: |         |         |         |         |                      |
| Land 35%   | 3080    | 4400    | 4400    | 4400    | 4400                 |
| Bldg 35%   | 27870   | 36370   | 36370   | 36370   | 36370                |
| Totl 35%   | 30950t  | 40770t  | 40770t  | 40770t  | 40760t               |
| Hmstd35%   |         |         |         | 40510   |                      |
| Owner Oc   | 32.40   | 35.52   | 33.74   | 33.54   | hmstd 4400 l 36110 b |
| Hmstd RB   |         |         |         |         |                      |
| Net Tax    | 1213.64 | 1480.20 | 1435.14 | 1433.32 |                      |
| Sp-Asmnt   | 30.02   | 30.02   | 56.66   | 56.66   |                      |

|      |      |      |      |       |       |   |       |
|------|------|------|------|-------|-------|---|-------|
| SHB+ | CONS | TYPE | FACT | SQ-FT | VALUE | a | *MAIN |
| 1    | F/C  | M    |      | 988   |       | b | ADDTN |
| 1    | F/C  | A    |      | 312   |       | c | PORCH |
|      | DK   | P    |      | 195   | 2930  | d | PORCH |
|      | STP  | P    |      | 80    | 320   | e | PORCH |
|      | RFX  | P    |      | 48    | 480   | f | PORCH |
|      | RFX  | P    |      | 80    | 800   | g | PORCH |
|      | STP  | P    |      | 12    | 50    | h | GRAGE |
|      | F    | G    |      | 848   | 20350 |   |       |

|                               |      |            |                      |               |        |         |         |
|-------------------------------|------|------------|----------------------|---------------|--------|---------|---------|
| #: 26, L/W<br>452910260000    |      |            |                      |               |        |         |         |
| Sale#                         | #p   | sale date  | To                   | Type/Invalid? | Sale\$ | co:land | co:bldg |
| 241                           | 1    | 2016-06-13 | BUTTERFIELD CLOVIS D | 1AT *         | 0      | 7290    | 57540   |
| Year                          | Land | Bldg       | Total                | Net Tax       |        |         |         |
| 2021                          | 3080 | 27870      | 30950                | 1282.64       |        |         |         |
| 2020                          | 3080 | 27870      | 30950                | 1300.26       |        |         |         |
| p r o j e c t                 |      |            |                      | ben acres     | /      | %       | factor  |
| 902 MAIN DISTRICT CONSERVANCY |      |            |                      | XA/2025       |        |         |         |
| 500 HARDIN COUNTY LANDFILL    |      |            |                      | XA/2025       |        |         |         |

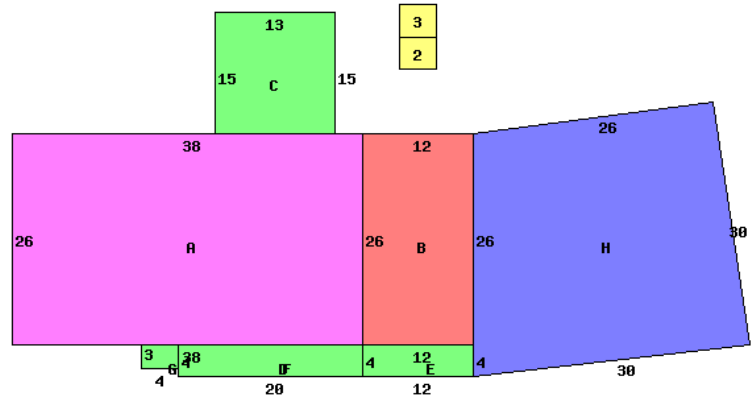

17055 TR 39 43310

|                           |                        |                            |
|---------------------------|------------------------|----------------------------|
| Occupancy 1 Single Family | *DWELLING COMPUTATIONS |                            |
| Story Height 1            | Sq-Ft                  | Value                      |
| Floor Level               | 1300                   | 107470                     |
| Metal                     | Subtotal               | 107470                     |
|                           | B 1 2 U A              | FRAME                      |
|                           |                        | GABLE                      |
| Plaster/Drywall           | X                      | Heating -1520              |
| Floor/Carpet              | X                      | Plumbing 2100              |
| Floor/Tile-Lino           | X                      | Garages and Carperts 20350 |
| Number of Rooms           | 5                      | Extra Features 6100        |
| Bedrooms                  | 3                      | Total Value 134500         |
| Plumbing                  |                        | PUB ELECTRIC               |
| Standard                  | 1                      | PRIV WATER                 |
| Extra 3 Fixture           | 1                      | PRIV SEWER                 |
|                           |                        | PUB PAVED ST/RD            |
|                           |                        | Topo: ROLLING              |
|                           |                        | Neighborhood:              |
|                           |                        | Code: 3100                 |
|                           |                        | Dwl/Gar/NC% 1.1800         |

|            |          |           |        |        |           |           |          |       |        |
|------------|----------|-----------|--------|--------|-----------|-----------|----------|-------|--------|
| Bldg Type  | SHB+Cons | DixHt     | Unit   | Grade  | Blt/Renov | Replace   | Phy      | Fnc   | True   |
| 1 DWELLING | 1 F/C    | 1300      |        | C      | 1973AV    | 134500    | .35      | Dpr   | 103160 |
| 2 Pool     | *PP      |           |        |        | OLD/      | 0         |          |       | 0      |
| 3 P        | DK       | 143       |        | C      | OLD/AV    | 2150      | .65      |       | 750    |
|            | acres/   | effective | depth  | depth  | actual    | effective | extended | true  |        |
| front lot  | frontage | frontage  | factor | factor | rate      | rate      | value    | value |        |
| rear lot   | 152.0000 | 112.00    | 225    | 115    | 60        | 69        | 7730     | 7730  |        |
| front lot  | 74.0000  | 74.00     | 130    | 7      | 20        | 1         | 70       | 70    |        |
| front lot  | 110.0000 | 69.00     | 225    | 115    | 60        | 69        | 4760     | 4760  |        |