

MCDONALD USV RHD FIRE DISTRICT

00305

Hardin County, Ohio
Michael T. Bacon, Auditor

45-290044.0000
F15

RES
2025

sale

Eff Rate:- 44.45 — 40.66 — 39.34 — 39.29 — a/r

| | | | | |
|------|-----------------------|------------|-----------|--------|
| 2022 | PEMBERTON AMBER | 2016-03-07 | | |
| 2023 | PEMBERTON AMBER | 2016-03-07 | | |
| 2024 | PEMBERTON AMBER | 2016-03-07 | | |
| 2025 | PEMBERTON AMBER | 2016-03-07 | 10221 ETC | 2.026A |
| | 16742 TR 39 | | IWD | |
| | BELLE CENTER OH 43310 | \$0 | | |

| | | | | | |
|------------|---------|---------|---------|---------|----------------------|
| Tax Year | 2022 | 2023 | 2024 | 2025 | CAMA |
| Prop Cls | 561 | 561 | 561 | 561 | 561 |
| Acres | 2.0260 | 2.0260 | 2.0260 | 2.0260 | |
| Land100% | 15690 | 23140 | 23140 | 23140 | 23130 |
| Bldg100% | 94430 | 131400 | 131400 | 131400 | 131410 |
| Totl100% | 110110t | 154540t | 154540t | 154540t | 154540t |
| Cauvl00% | | | | | |
| Tax Value: | | | | | |
| Land 35% | 5490 | 8100 | 8100 | 8100 | 8100 |
| Bldg 35% | 33050 | 45990 | 45990 | 45990 | 45990 |
| Totl 35% | 38540t | 54090t | 54090t | 54090t | 54090t |
| Hmstd35% | | 52290 | 52290 | 52290 | |
| Owner Oc | | 45.56 | 43.28 | 43.30 | hmstd 6300 l 45990 b |
| Hmstd RB | | | | | |
| Net Tax | 1551.60 | 1965.38 | 1905.50 | 1902.82 | |
| Sp-Asmnt | 24.59 | 24.59 | 65.90 | 65.90 | |

| | | | | | | | | |
|-------|------|------------|---------------------------|---------------|--------|---------|---------|--|
| SHB+ | CONS | TYPE | FACT | SQ-FT | VALUE | | | |
| 1 | F/C | M | | 1568 | | a | *MAIN | |
| | OFF | P | | 280 | 8400 | b | PORCH | |
| | EFF | P | | 69 | 2760 | c | PORCH | |
| Sale# | #p | sale date | To | Type/Invalid? | Sale\$ | co:land | co:blgd | |
| 93 | 1 | 2016-03-07 | PEMBERTON AMBER | IWD * | 0 | 13600 | 52000 | |
| 477 | 1 | 2015-09-18 | FEDERAL HOME LOAN MORTGAG | 1SD | 43333 | 13600 | 52000 | |
| 322 | 1 | 2007-06-25 | HOPKINS RYAN L | IWD | 90500 | 13000 | 66260 | |
| 235 | 1 | 1999-06-07 | SPRADLIN JERRY KEVIN | IWD * | 0 | 0 | 0 | |

| | | | | |
|------|------|-------|-------|---------|
| Year | Land | Bldg | Total | Net Tax |
| 2021 | 5490 | 23720 | 29210 | 1242.88 |
| 2020 | 5490 | 23720 | 29210 | 1259.98 |

| | | | |
|-------------------------------|-----------|-----|--------|
| project | ben acres | / % | factor |
| 500 HARDIN COUNTY LANDFILL | | | |
| 902 MAIN DISTRICT CONSERVANCY | | | |

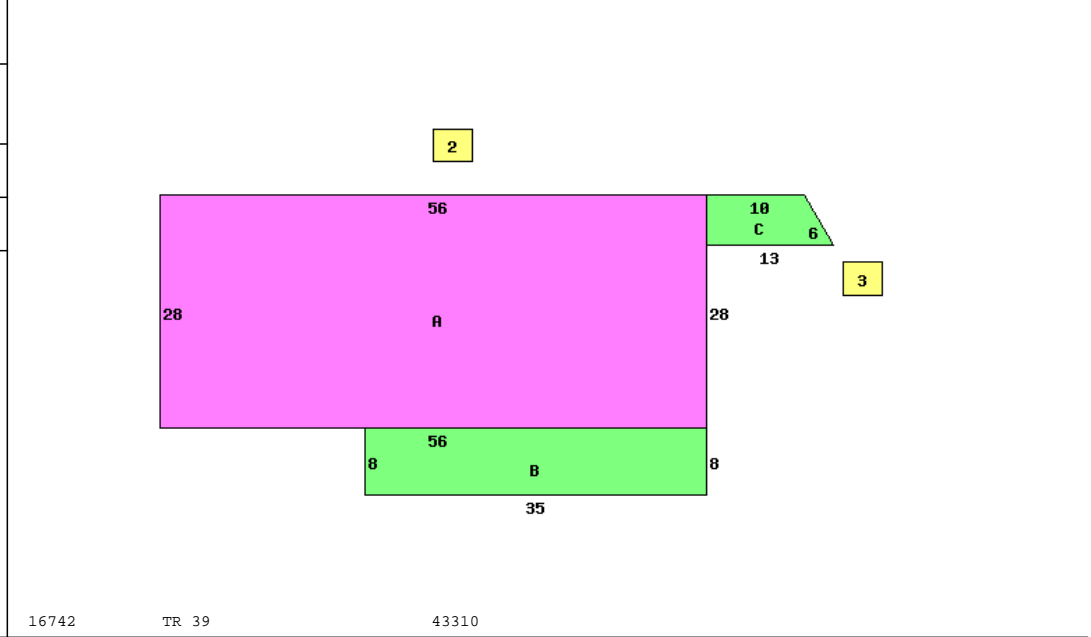

| | | |
|--------------------------------|------------------------|-----------------------|
| Occupancy 4 M/H on Real Estate | *DWELLING COMPUTATIONS | |
| Story Height 1 | Sq-Ft | Value |
| Floor Level | 1568 | 123200 |
| Shingle | Subtotal | 123200 |
| | Roof | |
| Plaster/Drywall | D | Air Conditioning 2780 |
| Floor/Carpet | X | Plumbing 2100 |
| Floor/Tile-Lino | X | Extra Features 11160 |
| Number of Rooms | 8 | Total Value 139240 |
| Bedrooms | 3 | |
| Central Heat | A | PUB ELECTRIC |
| FORCED AIR | | PRIV WATER |
| Central A/C | A | PRIV SEWER |
| Plumbing | | PUB PAVED ST/RD |
| Standard | 1 | Neighborhood: |
| Extra 3 Fixture | 1 | Code: 3100 |
| | | Dwl/Gar/NC% 1.1800 |

| | | | | | | | | | |
|---------------|----------|-----------|-------|--------|-----------|----------|-------|-----|--------|
| Bldg Type | SHB+Cons | DixHt | Unit | Grade | Blt/Renov | Replace | Phy | Fnc | True |
| 1 MH/REAL | 1 F/C | 28X56 | 1568 | MHD | 1999AV | 111390 | .22 | Dpr | 102520 |
| 2 Shed | *PP | 10X10 | 100 | | OLD/ | 0 | | | 0 |
| 3 Garage | | 30X40 | 1200 | C | 2020AV | 28800 | .15 | | 28890 |
| homesite | 1.0000 | effective | depth | actual | effective | extended | true | | |
| small acreage | 1.0260 | frontage | depth | rate | rate | value | value | | |
| | | | | 5000 | 5000 | 5130 | 5130 | | |

Call Back: Sign: PSN Date: 2014-11-05 Lister: 45-290044.0000-v082020R