

WASHINGTON TWP  
NORTHERN SD

00400

Hardin County, Ohio  
Michael T. Bacon, Auditor

43-370017.0000  
KK01

RES  
2025

sale

Eff Rate:- 49.61 — 39.31 — 39.59 — 39.44 — a/r

|                              |            |                          |
|------------------------------|------------|--------------------------|
| 2022 SOUDER JEROME S & NAN   | 2015-10-07 |                          |
| 2023 SOUDER JEROME S & NAN   | 2015-10-07 |                          |
| 2024 SOUDER JEROME S & NAN   | 2015-10-07 |                          |
| 2025 SOUDER JEROME S & NANCY | 2015-10-07 | PT NE 1/4 SE 1/4 15 .25A |
| 9806 SR 81                   | LWD        |                          |
| DOLA OH 45835                | \$75,000   |                          |

|            |         |        |        |        |        |        |
|------------|---------|--------|--------|--------|--------|--------|
| Tax Year   | 2022    | 2023   | 2024   | 2025   | 2025   | CAMA   |
| Prop Cls   | 511     | 511    | 511    | 511    | 511    | 511    |
| Acres      | .2500   | .2500  | .2500  | .2500  | .2500  |        |
| Land100%   | 3000    | 4340   | 4340   | 4340   | 4340   | 4340   |
| Bldg100%   | 68110   | 67770  | 67770  | 67770  | 67770  | 67780  |
| Totl100%   | 71110t  | 72110t | 72110t | 72110t | 72110t | 72120t |
| Cauv100%   |         |        |        |        |        |        |
| Tax Value: |         |        |        |        |        |        |
| Land 35%   | 1050    | 1520   | 1520   | 1520   | 1520   | 1520   |
| Bldg 35%   | 23840   | 23720  | 23720  | 23720  | 23720  | 23720  |
| Totl 35%   | 24890t  | 25240t | 25240t | 25240t | 25240t | 25240t |
| Hmstd35%   |         |        |        |        |        |        |
| Owner Oc   |         |        |        |        |        |        |
| Hmstd RB   |         |        |        |        |        |        |
| Net Tax    | 1117.74 | 897.82 | 905.40 | 901.88 | 901.88 |        |
| Sp-Asmnt   | 27.00   | 27.00  | 24.00  | 27.00  |        |        |

|      |      |      |      |       |       |         |
|------|------|------|------|-------|-------|---------|
| SHB+ | CONS | TYPE | FACT | SQ-FT | VALUE |         |
| 2 B  | CB   | M    |      | 660   |       | a *MAIN |
| 1 B  | F    | A    |      | 140   |       | b ADDTN |
|      | F2   | G    |      | 572   | 13730 | c GRAGE |
| B    | OP   | P    |      | 50    | 1500  | d PORCH |
| B    | EMP  | P    |      | 100   | 4500  | e PORCH |
|      | PAT  | P    |      | 112   | 340   | f PORCH |

| Sale# | #p | sale date  | To                      | Type/Invalid? | Sale\$ | co:land | co:bldg |
|-------|----|------------|-------------------------|---------------|--------|---------|---------|
| 525   | 1  | 2015-10-07 | SOUDER JEROME S & NANCY | L LWD         | 75000  | 5770    | 62800   |
| 657   | 1  | 2007-12-04 | OBENOUR GORDON I        | LWD           | 19250  | 5460    | 54340   |
| 394   | 1  | 2007-10-05 | OBENOUR KEITH ETAL      | LCT *         | 0      | 5460    | 54340   |
| 393   | 1  | 2007-10-05 | OBENOUR GORDON ETAL     | LCT *         | 0      | 5460    | 54340   |
| 392   | 1  | 2007-10-05 | OBENOUR GORDON & PAUL   | LAF *         | 0      | 5460    | 54340   |

| Year | Land | Bldg  | Total | Net Tax |
|------|------|-------|-------|---------|
| 2021 | 1050 | 23840 | 24890 | 1123.52 |
| 2020 | 1050 | 23840 | 24890 | 1128.00 |

| project                          | ben acres | / % | factor  |
|----------------------------------|-----------|-----|---------|
| 110 HOG CREEK MAINLINE - HOG CR. |           |     | XA/2025 |
| 115 IRETON - HOG CREEK           |           |     | XA/2025 |
| 500 HARDIN COUNTY LANDFILL       |           |     | XA/2025 |
| 116 JACOBS - HOG CREEK           |           |     | XA/2025 |
| 577 OTTAWA RIVER PROJECT MAINT   |           |     | XA/2021 |

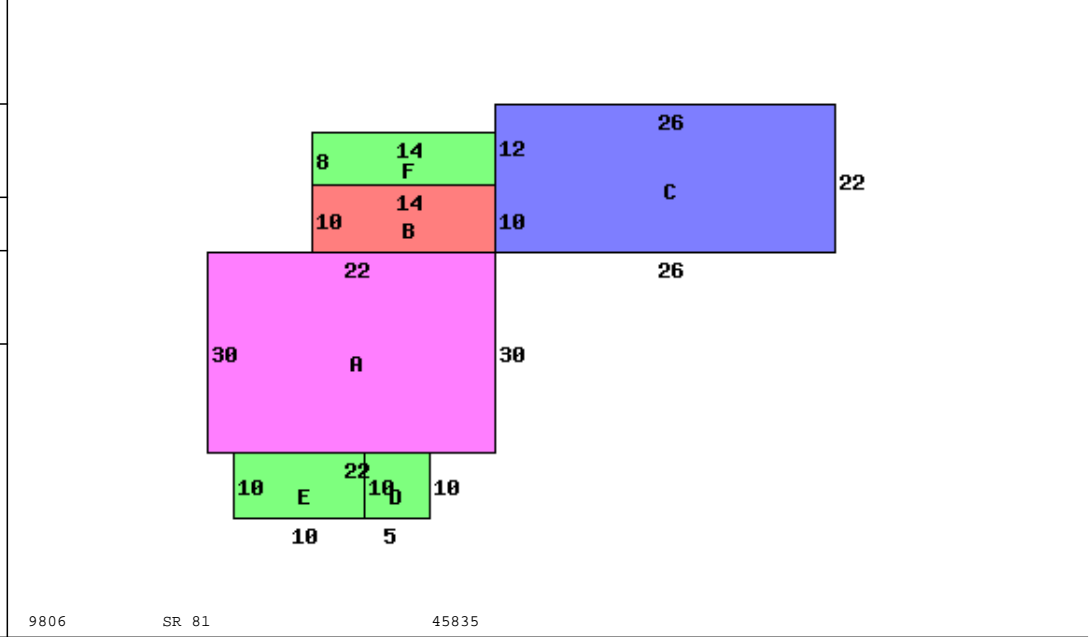

|                           |                        |                      |           |
|---------------------------|------------------------|----------------------|-----------|
| Occupancy 1 Single Family | *DWELLING COMPUTATIONS | Sq-Ft                | Value     |
| Story Height 2            |                        |                      |           |
| Floor Level               | Main                   | FRAME                | 800 97750 |
|                           | Full Upper             | FRAME                | 660 51320 |
|                           | Basement               |                      | 950 17740 |
|                           | Subtotal               |                      | 166810    |
| Metal                     | Roof                   | HIP                  |           |
|                           | B 1 2 U A              |                      |           |
| Plaster/Drywall           | X X                    | Plumbing             | 1400      |
| Panelled Wall             | P                      | Garages and Carports | 13730     |
| Unfinished Wall           | X                      | Extra Features       | 6340      |
| Floor/Pine                | X                      | Total Value          | 188280    |
| Floor/Carpet              | X                      |                      |           |
| Number of Rooms           | 1 4 4                  | PUB ELECTRIC         |           |
| Bedrooms                  | 4                      | PRIV WATER           |           |
|                           |                        | PRIV SEWER           |           |
| Central Heat              | A                      | PUB PAVED ST/RD      |           |
| ELECTRIC                  |                        |                      |           |
| Plumbing:                 |                        | Neighborhood:        |           |
| Standard                  | 1                      | Code:                | 4310      |
| Extra 2 Fixture           | 1                      | Dwl/Gar/NC%          | .8000     |

|            |          |           |        |        |        |           |          |       |      |       |
|------------|----------|-----------|--------|--------|--------|-----------|----------|-------|------|-------|
| Bldg Type  | SHB+Cons | DixHt     | Area   | Unit   | Grade  | Blt/Renov | Replace  | Phy   | Fnc  | True  |
| 1 DWELLING | 1 B F    |           | 1460   |        | C      | 1925AV    | 188280   | .55   |      | 67780 |
| front lot  | acres/   | effective | depth  | depth  | actual | effective | extended | value | true | value |
|            | frontage | frontage  | factor | factor | rate   | rate      | value    | 4340  | 4340 |       |
|            |          | 70.00     | 160    | 103    | 60     | 62        |          |       |      |       |

Call Back:

Sign: PSN Date: 2015-09-20 Lister:

43-370017.0000-v082020R