

WASHINGTON TWP
NORTHERN SD

00400

Hardin County, Ohio
Michael T. Bacon, Auditor

43-360018.0000
X08.01

RES
2025

sale

Eff Rate:- 49.61 — 39.31 — 39.59 — 39.44 — a/r

| | | | |
|------|-------------------------|------------|----------------------|
| 2022 | MCBRIDE JASON LUCAS & | 2015-12-21 | |
| 2023 | MCBRIDE JASON LUCAS & | 2015-12-21 | |
| 2024 | MCBRIDE JASON LUCAS & | 2015-12-21 | |
| 2025 | MCBRIDE JASON LUCAS & C | 2015-12-21 | PT NE4 NW4 S36 3.00A |
| | 11402 CR 60 | 1WD | |
| | DOLA OH 45835 | \$0 | |

| | | | | | |
|----------|---------|---------|---------|---------|---------|
| Tax Year | 2022 | 2023 | 2024 | 2025 | |
| Prop Cls | 511 | 511 | 511 | 511 | CAMA |
| Acres | 3.0000 | 3.0000 | 3.0000 | 3.0000 | 511 |
| Land100% | 18600 | 25000 | 25000 | 25000 | 25000 |
| Bldg100% | 107000 | 155230 | 155230 | 206140 | 206140 |
| Totl100% | 125600t | 180230t | 180230t | 231140t | 231140t |
| Cauvl00% | | | | | |

Orig Tax Year 2016
Parent: 43-360012.0000

| | | | | | |
|------------|---------|---------|---------|---------|----------------------|
| Tax Value: | | | | | |
| Land 35% | 6510 | 8750 | 8750 | 8750 | 8750 |
| Bldg 35% | 37450 | 54330 | 54330 | 72150 | 72150 |
| Totl 35% | 43960t | 63080t | 63080t | 80900t | 80900t |
| Hmstd35% | 41860 | 59580 | 59580 | 59580 | |
| Owner Oc | 49.24 | 55.68 | 55.48 | 55.26 | |
| Hmstd RB | | | | | hmstd 5250 l 54330 b |
| Net Tax | 1924.88 | 2188.18 | 2207.32 | 2835.44 | |
| Sp-Asmnt | 18.00 | 22.00 | 18.00 | 18.00 | |

| SHB+ | CONS | TYPE | FACT | SQ-FT | VALUE | | |
|------|------|------|------|-------|-------|---|-------|
| 1 | F/C | M | | 1400 | | a | *MAIN |
| | F2 | G | | 528 | 12670 | b | GRAGE |
| | F | G | | 484 | 11620 | c | GRAGE |
| 1 | F/C | A | | 668 | | d | ADDTN |
| | RFX | P | | 60 | 600 | e | PORCH |
| | OFFP | P | | 400 | 12000 | f | PORCH |
| | PAT | P | | 60 | 180 | g | PORCH |
| | PAT | P | | 480 | 1440 | h | PORCH |

| Sale# | #p | sale date | To | Type/Invalid? | Sale\$ | co:land | co:blgd |
|-------|----|------------|---------------------------|---------------|--------|---------|---------|
| 501 | 1 | 2015-12-21 | MCBRIDE JASON LUCAS & COR | 1WD * | 0 | 0 | 0 |

| Year | Land | Bldg | Total | Net Tax |
|------|------|-------|-------|---------|
| 2021 | 6510 | 37450 | 43960 | 1934.84 |
| 2020 | 6510 | 37450 | 43960 | 1942.60 |

Project
500 HARDIN COUNTY LANDFILL XA/2025
921 BLANCHARD RIVER MAINT XA/2023
ben acres / % factor

3
2
4

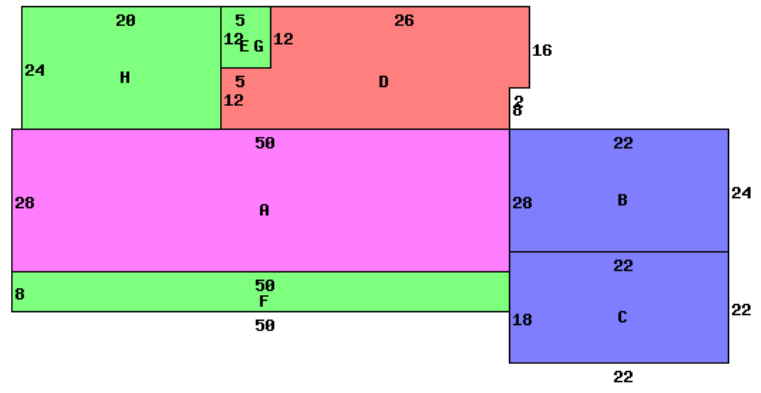

11402 CR 60 45835

| | | |
|---------------------------|-----------|----------------------------|
| Occupancy 1 Single Family | | *DWELLING COMPUTATIONS |
| Story Height 1 | | Sq-Ft Value |
| Floor Level | Main | FRAME 2068 140850 |
| | Subtotal | 140850 |
| Metal | Roof | HIP |
| | B 1 2 U A | |
| Plaster/Drywall | X | Air Conditioning 3680 |
| Floor/Carpet | X | Plumbing 2100 |
| Floor/Tile-Lino | X | Garages and Carports 24290 |
| Number of Rooms | 8 | Extra Features 14220 |
| Bedrooms | 2 | Total Value 185140 |
| Central Heat | A | PUB PAVED ST/RD |
| FORCED AIR | | |
| Heat Pump | X | Neighborhood: |
| Central A/C | A | Code: 4300 |
| Plumbing | | Dwl/Gar/NC% 1.2100 |
| Standard | 1 | |
| Extra 3 Fixture | 1 | |

| Bldg Type | SHB+Cons | DixHt | Unit | Blt/Renov | Replace | Phy | Fnc | True |
|---------------|----------|-----------|--------|-----------|-----------|----------|-------|-------|
| 1 DWELLING | 1 F/C | 2068 | Rate | Grade | Cond | Value | Dpr | Value |
| 2 Pole Build | | 48X72 | 3456 | C | 2024AV | 41470 | .05 | 39400 |
| 3 P | CAN | 16X72 | 1152 | C | 2024AV | 9220 | .05 | 8760 |
| 4 P | OFF | 8X12 | 96 | C | 2024AV | 2880 | .05 | 2740 |
| homesite | 1.0000 | effective | depth | actual | effective | extended | true | value |
| small acreage | 2.0000 | frontage | depth | rate | rate | value | value | value |
| | | frontage | factor | 15000 | 15000 | 15000 | 15000 | 15000 |
| | | | | 5000 | 5000 | 10000 | 10000 | 10000 |