

WASHINGTON TWP
NORTHERN SD

00400

Hardin County, Ohio
Michael T. Bacon, Auditor

43-240010.0000
JJ02

RES
2025

sale

Eff Rate:- 49.61 — 39.31 — 39.59 — 39.44 — a/r

| | | |
|--------------------|-----------------------------|-------|
| 2022 BASH DANIEL V | 2021-03-10 | |
| 2023 BASH DANIEL V | 2021-03-10 | |
| 2024 BASH DANIEL V | 2021-03-10 | |
| 2025 BASH DANIEL V | 2021-03-10 SW 1/4 NW 1/4 24 | 1.30A |
| 3336 TR 125 | 1AF | |
| DOLA OH 45835 | \$0 | |

| | | | | | | |
|------------|---------|---------|---------|---------|---------|----------------------|
| Tax Year | 2022 | 2023 | 2024 | 2025 | 2025 | |
| Prop Cls | 511 | 511 | 511 | 511 | 511 | CAMA |
| Acres | 1.3000 | 1.3000 | 1.3000 | 1.3000 | 1.3000 | 511 |
| Land100% | 13510 | 16510 | 16510 | 16510 | 16510 | 16500 |
| Bldg100% | 64890 | 82030 | 82030 | 82030 | 82030 | 82030 |
| Totl100% | 78400t | 98540t | 98540t | 98540t | 98540t | 98530t |
| Cauv100% | | | | | | |
| Tax Value: | | | | | | |
| Land 35% | 4730 | 5780 | 5780 | 5780 | 5780 | 5780 |
| Bldg 35% | 22710 | 28710 | 28710 | 28710 | 28710 | 28710 |
| Totl 35% | 27440t | 34490t | 34490t | 34490t | 34490t | 34490t |
| Hmstd35% | 27120 | 33960 | 33960 | 33960 | 33960 | |
| Owner Oc | 31.90 | 31.74 | 31.62 | 31.50 | 31.50 | hmstd 5250 l 28710 b |
| Hmstd RB | | | | | | |
| Net Tax | 1200.36 | 1195.12 | 1205.60 | 1200.90 | 1200.90 | |
| Sp-Asmnt | 24.00 | 32.00 | 24.00 | 24.00 | | |

| | | | | | | |
|------|------|------|------|-------|-------|---------|
| SHB+ | CONS | TYPE | FACT | SQ-FT | VALUE | |
| 1HB | F | M | | 504 | | a *MAIN |
| 1 | F/C | A | | 96 | | b ADDTN |
| 1 BA | F | A | | 256 | | c ADDTN |
| | OP | P | | 96 | 2880 | d PORCH |
| | RFP | P | | 28 | 1120 | e PORCH |
| | DK | P | | 252 | 3780 | f PORCH |

#: 11, L/W
43240010000 .80a

| Sale# | #p | sale date | To | Type/Invalid? | Sale\$ | co:land | co:bldg |
|-------|----|------------|-------------------------|---------------|--------|---------|---------|
| 98 | 1 | 2021-03-10 | BASH DANIEL V | 1AF * | 0 | 13510 | 64890 |
| 267 | 1 | 2017-06-14 | BASH DANIEL V & LINDA L | 1SD * | 0 | 11400 | 46940 |

| Year | Land | Bldg | Total | Net Tax |
|------|------|-------|-------|---------|
| 2021 | 4730 | 22710 | 27440 | 1206.56 |
| 2020 | 4730 | 22710 | 27440 | 1211.38 |

| Project | ben acres | % | factor |
|----------------------------------|-----------|---|---------|
| 592 EAGLE CREEK MAINT HANCOCK CO | | | XA/2018 |
| 125 HYDRAULIC - BLANCHARD | | | XA/2025 |
| 500 HARDIN COUNTY LANDFILL | | | XA/2025 |
| 921 BLANCHARD RIVER MAINT | | | XA/2023 |

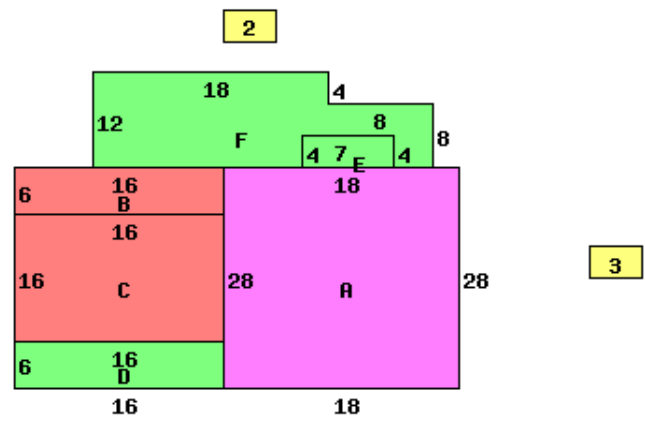

3336 TR 125 45835

| | | |
|---------------------------|------------------------|-----------------------------|
| Occupancy 1 Single Family | *DWELLING COMPUTATIONS | |
| Story Height 1H | Sq-Ft | Value |
| Floor Level | Main | FRAME 856 97570 |
| | Part Upper | FRAME 504 26320 |
| | Qtr Story | FRAME 256 1210 |
| | Basement | 760 14220 |
| | Subtotal | 139320 |
| Metal | Roof | GABLE |
| Plaster/Drywall | X X X | 256 sq ft Attic Finish 4740 |
| Unfinished Wall | X | Heating -950 |
| Floor/Pine | X X X | Air Conditioning 1560 |
| Number of Rooms | 1 4 2 1 | Extra Features 7780 |
| Bedrooms | 1 3 | Total Value 152450 |
| Central Heat | X | PUB ELECTRIC |
| FORCED AIR | | PRIV WATER |
| Central A/C | X | PRIV SEWER |
| Plumbing | | PUB PAVED ST/RD |
| Standard | 1 | |
| | | Neighborhood: |
| | | Code: 4300 |
| | | Dwl/Gar/NC% 1.2100 |

| Bldg Type | SHB+Cons | DixHt | Area | Unit Rate | Grade | Blt/Renov Cond | Replace Value | Phy Dpr | Fnc Dpr | True Value |
|---------------|----------|-----------|-------|-----------|-----------|----------------|---------------|---------|---------|------------|
| 1 DWELLING | 1HB F | 24X30 | 1616 | | C- | OLD/AV | 137210 | .55 | | 74710 |
| 2 Garage | | 12X10 | 720 | | C | 1965AV | 17280 | .65 | | 7320 |
| 3 Shed | *PP 0 | 12X10 | 120 | | | OLD/ | 0 | | | 0 |
| homesite | 1.0000 | effective | depth | actual | effective | extended | true | | | |
| small acreage | .3000 | frontage | depth | rate | rate | value | value | | | |
| | | | | 15000 | 15000 | 15000 | 15000 | | | |
| | | | | 5000 | 5000 | 1500 | 1500 | | | |