

WASHINGTON TWP  
NORTHERN SD

00400

Hardin County, Ohio  
Michael T. Bacon, Auditor

43-130037.0000  
Y08

RES  
2025

sale

2022 MOTTER MARK E & NANCY	
2023 MOTTER MARK E & NANCY	
2024 MOTTER MARK E & NANCY	
2025 MOTTER MARK E & NANCY K	
11430 SR 81	PT E1/2 SW1/4 S13 1.00A
DOLA OH 45835	\$0

Eff Rate:-	49.61	39.31	39.59	39.44	a/r
Tax Year	2022	2023	2024	2025	CAMA
Prop Cls	511	511	511	511	511
Acres	1.0000	1.0000	1.0000	1.0000	15000
Land100%	12600	15000	15000	15000	159920
Bldg100%	135200t	159910t	159910t	159910t	174920t
Totl100%	147800t	174910t	174910t	174910t	
Cauv100%					
Tax Value:					
Land 35%	4410	5250	5250	5250	5250
Bldg 35%	47320	55970	55970	55970	55970
Totl 35%	51730t	61220t	61220t	61220t	61220t
Hmstd35%	51370	60680	60680	60680	
Owner Oc	60.42	56.72	56.52	56.28	hmstd 5250 l 55430 b
Hmstd RB					
Net Tax	2262.62	2120.98	2139.54	2131.22	
Sp-Asmnt	21.00	25.00	21.00	24.00	

SHB+	CONS	TYPE	FACT	SQ-FT	VALUE	a	*MAIN
1	F/C	M		1560			GRAGE
	F2	G		576	13820		PORCH
1	RFX	P		480	4800		ADDTN
	F/C	A		560			PORCH
	DK	P		480	7200		PORCH
	PAT	P		276	830		PORCH

Year	Land	Bldg	Total	Net Tax
2021	4410	47320	51730	2274.34
2020	4410	47320	51730	2283.44

project	ben acres	/ %	factor
235 KELLOGG #983 - BLANCHARD			XA/2025
921 BLANCHARD RIVER MAINT			XA/2023
500 HARDIN COUNTY LANDFILL			XA/2025
305 LEASE #1037 - BLANCHARD			XA/2025

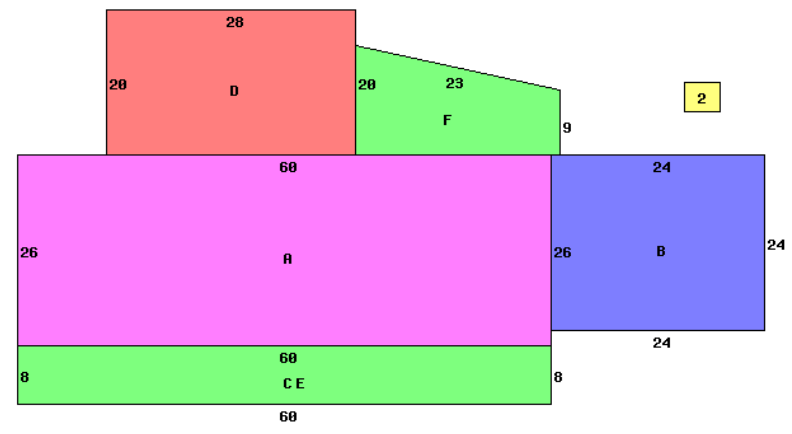

Occupancy 1 Single Family		*DWELLING COMPUTATIONS
Story Height 1		Sq-Ft Value
Floor Level	Main	FRAME 2120 143480
	Subtotal	143480
Metal	Roof	GABLE
Plaster/Drywall	X	Plumbing 2100
Floor/Carpet	X	Garages and Carports 13820
Number of Rooms	5	Extra Features 12830
Bedrooms	3	Total Value 172230
Central Heat	A	PUB ELECTRIC
ELECTRIC		PRIV WATER
Plumbing		PRIV SEWER
Standard	1	PUB PAVED ST/RD
Extra 3 Fixture	1	
		Neighborhood:
		Code: 4300
		Dwl/Gar/NC% 1.2100

Bldg Type	SHB+Cons	DixHt	Unit	Blt/Renov	Replace	Phy Dpr	Fnc Dpr	True Value
1 DWELLING	1 F/C	20X20	2120	C	1991GD	172230	.24	158380
2 Shed	F 0	400		D	1994AV	3840	.60	1540
homesite	1.0000	effective frontage	depth	actual rate	effective rate	extended value	true value	