

WASHINGTON TWP
NORTHERN SD

00400

Hardin County, Ohio
Michael T. Bacon, Auditor

43-120010.0000
L11

AGR
2025

sale

Eff Rate:- 49.61 — 39.31 — 39.59 — 39.44 — a/r

| | | |
|------|-----------------------|-----------------------------------|
| 2022 | FREDERICK NORMA | 1998-01-30 |
| 2023 | FREDERICK NORMA | 1998-01-30 |
| 2024 | FREDERICK NORMA | 1998-01-30 |
| 2025 | MILLS DEBORAH TRUSTEE | 2024-01-31 S2 W2 E2 SW4 12 20.00A |
| | 11271 CR 30 | 3QC SEE PCL 43-120010.01 FOR |
| | DUNKIRK OH 45836 | \$0 REST OF SPECIALS |

| | | | | | |
|------------|---------|---------|---------|---------|---------|
| Tax Year | 2022 | 2023 | 2024 | 2025 | CAMA |
| Prop Cls | 111 | 111 | 111 | 111 | 111 |
| Acres | 20.0000 | 20.0000 | 20.0000 | 20.0000 | |
| Land100% | 116460 | 128460 | 128460 | 128460 | 128450 |
| Bldg100% | 19540 | 20140 | 20140 | 20140 | 20130 |
| Totl100% | 136000t | 148600t | 148600t | 148600t | 148580t |
| Cauv100% | 40140 | 68430 | 68430 | 68430 | 68440 |
| Tax Value: | | | | | |
| Land 35% | 14050 | 23950 | 23950 | 23950 | 44960 |
| Bldg 35% | 6840 | 7050 | 7050 | 7050 | 7050 |
| Totl 35% | 20890t | 31000t | 31000t | 31000t | 52000t |
| Hmstd35% | | | | | |
| Owner Oc | | | | | |
| Hmstd RB | | | | | |
| Net Tax | 938.12 | 1102.72 | 1112.04 | 1107.68 | |
| Cauv Sav | 1199.44 | 747.36 | 753.66 | 750.72 | |
| Sp-Asmnt | 40.20 | 52.47 | 48.47 | 65.39 | |

| | | | | | | | |
|------|------|------|------|-------|-------|---|-------|
| SHB+ | CONS | TYPE | FACT | SQ-FT | VALUE | a | *MAIN |
| 1 | F/C | M | | 624 | | b | PORCH |
| | EFP | P | | 84 | 3360 | c | PORCH |
| | CAN | A | | 55 | 440 | d | ADDTN |
| 1 Q | F/C | P | | 252 | | e | PORCH |
| | DK | O | | 55 | 830 | f | OTHER |
| 04 | B | O | | 160 | 1920 | | |

| | | | | | | | |
|-------|-------|------------|-----------------|---------------|--------|---------|---------|
| Sale# | #p | sale date | To | Type/Invalid? | Sale\$ | co:land | co:bldg |
| 48 | 2 | 1998-01-30 | FREDERICK NORMA | 2AF * | 0 | 26660 | 5000 |
| Year | Land | Bldg | Total | Net Tax | | | |
| 2021 | 14050 | 6840 | 20890 | 942.96 | | | |
| 2020 | 14050 | 6840 | 20890 | 946.72 | | | |

| | | | | |
|----------------------------------|-----------|---|---|---------|
| project | ben acres | / | % | factor |
| 592 EAGLE CREEK MAINT HANCOCK CO | | | | XA/2018 |
| 125 HYDRAULIC - BLANCHARD | | | | XA/2025 |
| 235 KELLOGG #983 - BLANCHARD | | | | XA/2025 |
| 500 HARDIN COUNTY LANDFILL | | | | XA/2025 |
| 921 BLANCHARD RIVER MAINT | | | | XA/2023 |
| 305 LEASE #1037 - BLANCHARD | | | | XA/2025 |

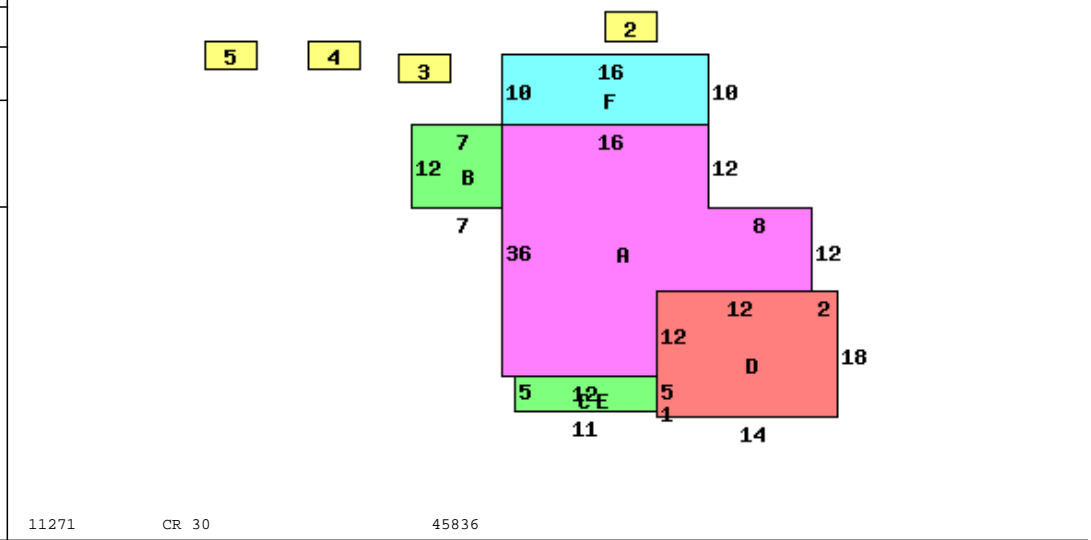

11271 CR 30 45836

| | | |
|-----------------|-----------------|------------------------------|
| Occupancy | 1 Single Family | *DWELLING COMPUTATIONS |
| Story Height | 1Q | Sq-Ft Value |
| Floor Level | Main | FRAME 876 99850 |
| | Qtr Story | FRAME 252 1190 |
| | Subtotal | 101040 |
| Shingle | Roof | GABLE |
| Plaster/Drywall | X | X 252 sq ft Attc Finish 4660 |
| Floor/Pine | X | X Heating -1270 |
| Number of Rooms | 6 | 1 Extra Features 6550 |
| Bedrooms | 3 | Total Value 110980 |
| Plumbing | | PUB ELECTRIC |
| Standard | 1 | PRIV WATER |
| | | PRIV SEWER |
| | | PUB PAVED ST/RD |
| | | Neighborhood: |
| | | Code: 4300 |
| | | Dwl/Gar/NC% 1.2100 |

| | | | | | | | | |
|-------------|-------------------------|--------|--------|-----------|--------------|-------|--------|-------|
| Bldg Type | SHB+Cons | DixHt | Unit | Blt/Renov | Replace | Phy | Fnc | True |
| 1 DWELLING | 1Q F/C | Area | Rate | Grade | Value | Dpr | Dpr | Value |
| 2 SMOKE HSE | *NV 0 | 7X8 | 56 | D+ | 1910PR 94330 | .75 | .35 | 18550 |
| 3 STORAGE | *NV 0 | 10X14 | 140 | | OLD/VP 0 | | | 0 |
| 4 Shed | | 12X18 | 216 | D | OLD/FR 0 | | | 0 |
| 5 Shed | | 12X20 | 240 | E | OLD/AV 2070 | .65 | | 720 |
| | | | | | 1440 | .40 | | 860 |
| Tab # | S O I L | Acres | Mkt/Ac | Market | Au/Ac | Cauv | | |
| C 1 | BOA BLOUNT SILT LOAM 0- | 7.7247 | 6030 | 46580 | 2660 | 20550 | | |
| C 2 | BOB BLOUNT SILT LOAM, 2 | 4.7112 | 5770 | 27180 | 2360 | 11120 | | |
| C 39 | PM PEWAMO SILTY CLAY L | 2.1190 | 6490 | 13750 | 3560 | 7540 | | |
| C 52 | PKA PEWAMO SICL 0-1% SL | 3.9972 | 6490 | 25940 | 3560 | 14230 | | |
| 670 | HSITE HOMESITE | 1.0000 | 15000 | 15000 | 15000 | 15000 | | |
| 980 | ROAD ROAD | .4479 | | | | | | |
| | | 20 | | 128450 | (100%) | 68440 | CAUV # | 4588 |
| | | | | 44960 | (35%) | 23950 | | |

Call Back:

Sign: PSN Date: 2015-09-16 Lister:

43-120010.0000-v082020R