

WASHINGTON TWP  
NORTHERN SD

00400

Hardin County, Ohio  
Michael T. Bacon, Auditor

43-080016.0000  
H05

RES  
2025

sale

Eff Rate:- 49.61 — 39.31 — 39.59 — 39.44 — a/r

|                              |                                |
|------------------------------|--------------------------------|
| 2022 WHITAKER COURTNEY J &   | 2013-11-13                     |
| 2023 WHITAKER COURTNEY J &   | 2013-11-13                     |
| 2024 WHITAKER COURTNEY J &   | 2013-11-13                     |
| 2025 WHITAKER COURTNEY J & A | 2013-11-13 PT NE4 NW4 S8 8.06A |
| 7306 CR 14                   | 1SD                            |
| ADA OH 45810                 | \$200,000                      |

|          |         |         |         |         |         |
|----------|---------|---------|---------|---------|---------|
| Tax Year | 2022    | 2023    | 2024    | 2025    | CAMA    |
| Prop Cls | 511     | 511     | 511     | 511     | 511     |
| Acres    | 8.0600  | 8.0600  | 8.0600  | 8.0600  | 37870   |
| Land100% | 26310   | 37860   | 37860   | 37860   | 212610  |
| Bldg100% | 182090  | 212600  | 212600  | 212600  | 250480t |
| Totl100% | 208400t | 250460t | 250460t | 250460t |         |
| Cauvl00% |         |         |         |         |         |

Orig Tax Year 2002  
Parent: 43-080014.0000

|            |         |         |         |         |                      |
|------------|---------|---------|---------|---------|----------------------|
| Tax Value: | 9210    | 13250   | 13250   | 13250   | 13250                |
| Land 35%   | 63730   | 74410   | 74410   | 74410   | 74410                |
| Bldg 35%   | 72940t  | 87660t  | 87660t  | 87660t  | 87670t               |
| Totl 35%   | 65500   | 76620   | 76620   | 76620   |                      |
| Hmstd35%   | 77.04   | 71.60   | 71.36   | 71.06   |                      |
| Owner Oc   |         |         |         |         | hmstd 5250 l 71370 b |
| Hmstd RB   |         |         |         |         |                      |
| Net Tax    | 3198.48 | 3046.60 | 3073.16 | 3061.20 |                      |
| Sp-Asmnt   | 37.85   | 33.64   | 30.64   | 33.90   |                      |

|          |        |        |      |            |       |         |
|----------|--------|--------|------|------------|-------|---------|
| SHB+ 1 B | CONS F | TYPE M | FACT | SQ-FT 1600 | VALUE | a *MAIN |
|          | OPF F  | P      |      | 208        | 6240  | b PORCH |
|          | OPF F  | G      |      | 702        | 16850 | c GRAGE |
|          | PAT P  | P      |      | 280        | 8400  | d PORCH |
|          |        |        |      | 420        | 1260  | e PORCH |

|       |    |            |                           |               |        |         |         |
|-------|----|------------|---------------------------|---------------|--------|---------|---------|
| Sale# | #p | sale date  | To                        | Type/Invalid? | Sale\$ | co:land | co:bldg |
| 555   | 1  | 2013-11-13 | WHITAKER COURTNEY J & ANG | 1SD           | 200000 | 24200   | 147940  |
| 358   | 1  | 2010-09-17 | REAMS TERRI L             | 1CT *         | 0      | 24200   | 135890  |
| 340   | 1  | 2001-07-11 | REAMS NORMAN H JR & TERR  | 1WD           | 24000  | 0       | 0       |

|      |      |       |       |         |
|------|------|-------|-------|---------|
| Year | Land | Bldg  | Total | Net Tax |
| 2021 | 9210 | 63730 | 72940 | 3215.04 |
| 2020 | 9210 | 63730 | 72940 | 3227.90 |

|               |                              |           |     |         |
|---------------|------------------------------|-----------|-----|---------|
| p r o j e c t |                              | ben acres | / % | factor  |
| 110           | HOG CREEK MAINLINE - HOG CR. |           |     | XA/2025 |
| 119           | DITCH 28 - HOG CREEK         |           |     | XA/2025 |
| 500           | HARDIN COUNTY LANDFILL       |           |     | XA/2025 |
| 577           | OTTAWA RIVER PROJECT MAINT   |           |     | XA/2021 |

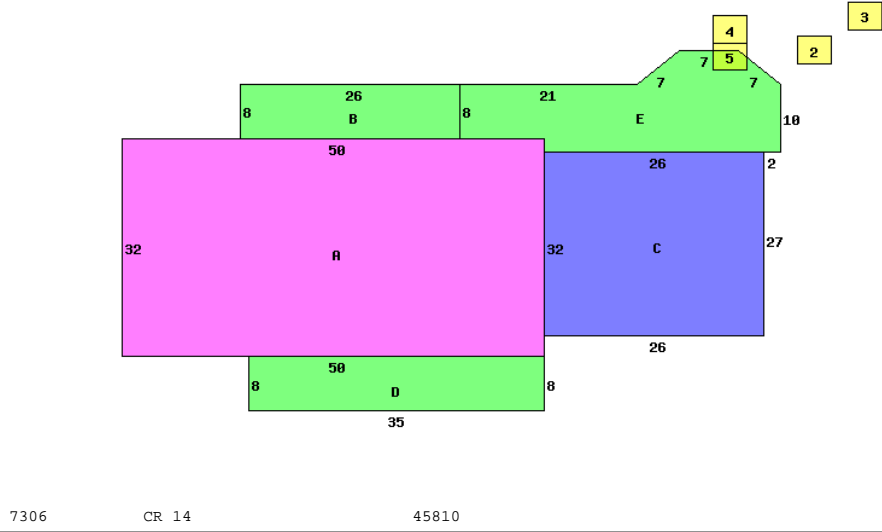

|                           |                        |                             |
|---------------------------|------------------------|-----------------------------|
| Occupancy 1 Single Family | *DWELLING COMPUTATIONS |                             |
| Story Height 1            | Sq-Ft                  | Value                       |
| Floor Level               |                        |                             |
| Main                      | FRAME                  | 1600 125710                 |
| Basement                  |                        | 1600 29600                  |
| Subtotal                  |                        | 155310                      |
| Metal Roof                | GABLE                  |                             |
| B 1 2 U A                 |                        |                             |
| Plaster/Drywall           | D                      | 800 sq ft 8660              |
| Unfinished Wall           | X                      | Air Conditioning 2830       |
| Floor/Hardwood            | X                      | Plumbing 3500               |
| Floor/Carpet              | X                      | Garages and Carpports 16850 |
| Floor/Concrete            | X                      | Extra Features 15900        |
| Floor/Tile-Lino           | X                      | Total Value 203050          |
| Number of Rooms           | 2 5                    |                             |
| Bedrooms                  | 1 2                    |                             |
| Central Heat              | A                      | PUB ELECTRIC                |
| FORCED AIR                |                        | PRIV WATER                  |
| Central A/C               | A                      | PRIV SEWER                  |
| Plumbing                  |                        | PUB PAVED ST/RD             |
| Standard                  | 1                      | Neighborhood:               |
| Extra 3 Fixture           | 1                      | Code: 4300                  |
| Extra 2 Fixture           | 1                      | Dwl/Gar/NC% 1.2100          |

|                 |           |        |        |           |           |          |       |        |
|-----------------|-----------|--------|--------|-----------|-----------|----------|-------|--------|
| Bldg Type       | SHB+Cons  | DixHt  | Unit   | Blt/Renov | Replace   | Phy      | Fnc   | True   |
| 1 DWELLING      | 1 B F     | 2400   |        | C         | 2003GD    | 203050   | .17   | 203920 |
| 2 Pole Build    | M         | 30X40  | 1200   | C         | 2001AV    | 14400    | .55   | 6480   |
| 3 Shed          | *NV       | 10X16  | 140    |           | OLD/      | 0        |       | 0      |
| 4 Shed          |           | 14X30  | 420    | D         | 2005AV    | 4030     | .50   | 2020   |
| 5 Lean-To       |           | 10X6   | 60     | D         | 2005AV    | 380      | .50   | 190    |
| homesite        |           | 1.0000 |        |           |           |          |       |        |
| small acreage   |           | 7.0600 |        |           |           |          |       |        |
| Total Value     |           |        |        |           |           |          |       |        |
| acres/ frontage | effective | depth  | depth  | actual    | effective | extended | true  |        |
|                 | frontage  | depth  | factor | rate      | rate      | value    | value |        |
|                 |           |        |        | 15000     | 15000     | 15000    | 15000 |        |
|                 |           |        |        | 5000      | 3240      | 22870    | 22870 |        |

Call Back:

Sign: PSN Date: 2015-09-15 Lister:

43-080016.0000-v082020R