

WASHINGTON TWP  
NORTHERN SD

00400

Hardin County, Ohio  
Michael T. Bacon, Auditor

43-010009.0000  
A10

RES  
2025

sale

Eff Rate:- 49.61 — 39.31 — 39.59 — 39.44 — a/r

2022 ROSE MICHELE L	2007-02-23
2023 ROSE MICHELE L	2007-02-23
2024 ROSE MICHELE L	2007-02-23
2025 ROSE MICHELE L	2007-02-23 W 1/2 SE 1/4 1 6.69A
11732 CR 14	LWD
DUNKIRK OH 45836	\$23,500

Tax Year	2022	2023	2024	2025	CAMA
Prop Cls	511	511	511	511	511
Acres	6.6900	6.6900	6.6900	6.6900	
Land100%	24830	35370	35370	35370	35370
Bldg100%	259860	300490	300490	300490	300490
Totl100%	284690t	335860t	335860t	335860t	335860t
Cauv100%					
Tax Value:					
Land 35%	8690	12380	12380	12380	12380
Bldg 35%	90950	105170	105170	105170	105170
Totl 35%	99640t	117550t	117550t	117550t	117550t
Hmstd35%				106260	
Owner Oc				98.56	
Hmstd RB					
Net Tax	4474.54	4181.46	4216.74	4101.72	
Sp-Asmnt	21.00	25.61	21.61	42.61	

SHB+ 1 B	CONS F	TYPE M	FACT P	SQ-FT 2159	VALUE 3600	a *MAIN
	OFF F		G	616	14780	b PORCH
	DK F		P	416	6240	c GRAGE
						d PORCH

Sale#	#p	sale date	To	Type/Invalid?	Sale\$	co:land	co:bldg
75	1	2007-02-23	ROSE MICHELE L	LWD	23500	13340	0
316	12	2005-08-24	BRUNER LAND CO INC	12 *	0	132540	0
275	1	2005-05-04	BRUNER LAND CO INC	LWD	162500	132540	0
320	1	2002-07-30	BECKER MARCELLA A TRUSTE	1QC *	0	119710	0

Year	Land	Bldg	Total	Net Tax
2021	8690	90950	99640	4497.74
2020	8690	90950	99640	4515.62

Project	ben acres	/	%	factor
592 EAGLE CREEK MAINT HANCOCK CO				XA/2018
125 HYDRAULIC - BLANCHARD				XA/2025
921 BLANCHARD RIVER MAINT				XA/2023
500 HARDIN COUNTY LANDFILL				XA/2025
615 BEACH MAINT-HANCOCK COUNTY				XA/2025

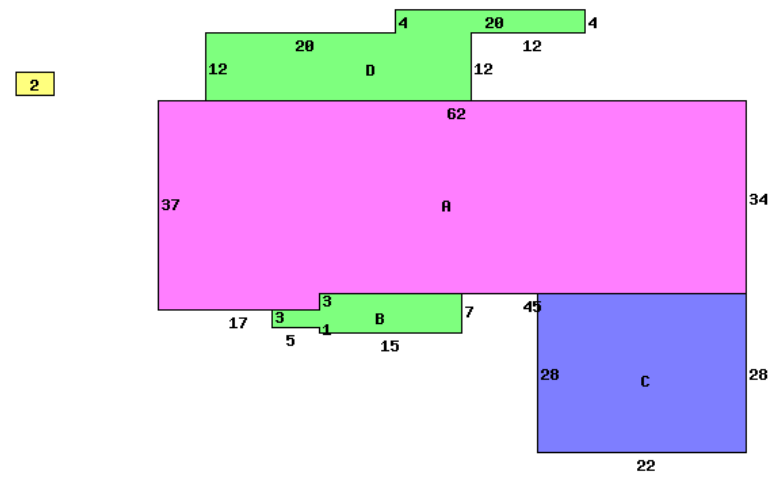

11732 CR 14 45836

Occupancy 1 Single Family	*DWELLING COMPUTATIONS
Story Height 1	Sq-Ft Value
Floor Level	2159 145780
Main	2159 39790
Basement	Subtotal 185570
Shingle	Roof GABLE
Plaster/Drywall	D Air Conditioning 3760
Unfinished Wall	X Plumbing 2100
Floor/Hardwood	X Garages and Carports 14780
Floor/Carpet	X Extra Features 9840
Floor/Tile-Lino	T Total Value 216050
Number of Rooms	6
Bedrooms	3
Central Heat	A PUB ELECTRIC
FORCED AIR	PRIV WATER
Central A/C	A PUB PAVED ST/RD
Plumbing	Neighborhood:
Standard	1 Code: 4300
Extra 3 Fixture	1 Dwl/Gar/NC% 1.2100

Bldg Type	SHB+Cons	DixHt	Unit	Blt/Renov	Replace	Phy	Fnc	True
1 DWELLING	1 B F	2159		B-	2014AV	.08		288610
2 Pole Build	M	30X48	1440	C	2007AV	.45		11880
homesite	acres/	effective	depth	actual	effective	extended	true	
small acreage	1.0000	frontage	depth	rate	rate	value	value	
	5.6900	frontage	depth	5000	3580	20370	20370	

Call Back:	Sign: PSN Date: 2015-09-14	Lister:	43-010009.0000-v082020R
------------	----------------------------	---------	-------------------------