

TAYLOR CREEK TWP  
BENJAMIN LOGAN SD

00390

Hardin County, Ohio  
Michael T. Bacon, Auditor

42-040023.0000  
C39

RES  
2025

sale

Eff Rate:- 43.71 — 40.66 — 41.04 — 39.77 — a/r

|                            |                 |       |  |
|----------------------------|-----------------|-------|--|
| 2022 CHAPPELL ANNETTA L &  | 2020-05-19      |       |  |
| 2023 CHAPPELL ANNETTA LYNN | 2022-08-02      |       |  |
| 2024 CHAPPELL ANNETTA LYNN | 2022-08-02      |       |  |
| 2025 CHAPPELL ANNETTA LYNN | 2022-08-02 9999 | 3.00A |  |
| 8494 TR 210                | 4CT             |       |  |
| BELLE CENTER OH 43310      | \$0             |       |  |

|            |         |         |         |         |         |
|------------|---------|---------|---------|---------|---------|
| Tax Year   | 2022    | 2023    | 2024    | 2025    | CAMA    |
| Prop Cls   | 511     | 511     | 511     | 511     | 511     |
| Acres      | 3.0000  | 3.0000  | 3.0000  | 3.0000  |         |
| Land100%   | 18600   | 25000   | 25000   | 25000   | 25000   |
| Bldg100%   | 89660   | 105230  | 105230  | 105230  | 105220  |
| Totl100%   | 108260t | 130230t | 130230t | 130230t | 130220t |
| Cauv100%   |         |         |         |         |         |
| Tax Value: |         |         |         |         |         |
| Land 35%   | 6510    | 8750    | 8750    | 8750    | 8750    |
| Bldg 35%   | 31380   | 36830   | 36830   | 36830   | 36830   |
| Totl 35%   | 37890t  | 45580t  | 45580t  | 45580t  | 45580t  |
| Hmstd35%   |         |         |         |         |         |
| Owner Oc   |         |         |         |         |         |
| Hmstd RB   |         |         |         |         |         |
| Net Tax    | 1509.52 | 1687.86 | 1704.96 | 1651.02 |         |
| Sp-Asmnt   | 21.37   | 21.37   | 21.37   | 21.37   |         |

| SHB+ | CONS | TYPE | FACT | SQ-FT | VALUE |   |       |  |
|------|------|------|------|-------|-------|---|-------|--|
| 1    | F/C  | M    |      | 1296  |       | a | *MAIN |  |
|      | PAT  | P    |      | 352   | 1060  | b | PORCH |  |
|      | OFF  | P    |      | 70    | 2100  | c | PORCH |  |
|      | OFF  | P    |      | 144   | 4320  | d | PORCH |  |

| Sale# | #p | sale date  | To                        | Type/Invalid? | Sale\$ | co:land | co:bldg |
|-------|----|------------|---------------------------|---------------|--------|---------|---------|
| 344   | 4  | 2022-08-02 | CHAPPELL ANNETTA LYNN     | 4CT *         | 0      | 18600   | 89660   |
| 213   | 2  | 2020-05-19 | CHAPPELL ANNETTA L & FERL | 2AF *         | 0      | 18000   | 74910   |
| 121   | 1  | 2020-03-19 | SHEELEY CHARLES E         | 1CT *         | 0      | 18000   | 74910   |

| Year | Land | Bldg  | Total | Net Tax |
|------|------|-------|-------|---------|
| 2021 | 6510 | 31380 | 37890 | 1551.18 |
| 2020 | 6510 | 31380 | 37890 | 1415.18 |

| p r o j e c t |                            | ben acres |  | / % factor |  |
|---------------|----------------------------|-----------|--|------------|--|
| 548           | SOUTHFORK MAINT - LOGAN CO |           |  |            |  |
| 500           | HARDIN COUNTY LANDFILL     |           |  |            |  |
| 458           | LIGGETT DITCH - LOGAN CO.  |           |  |            |  |

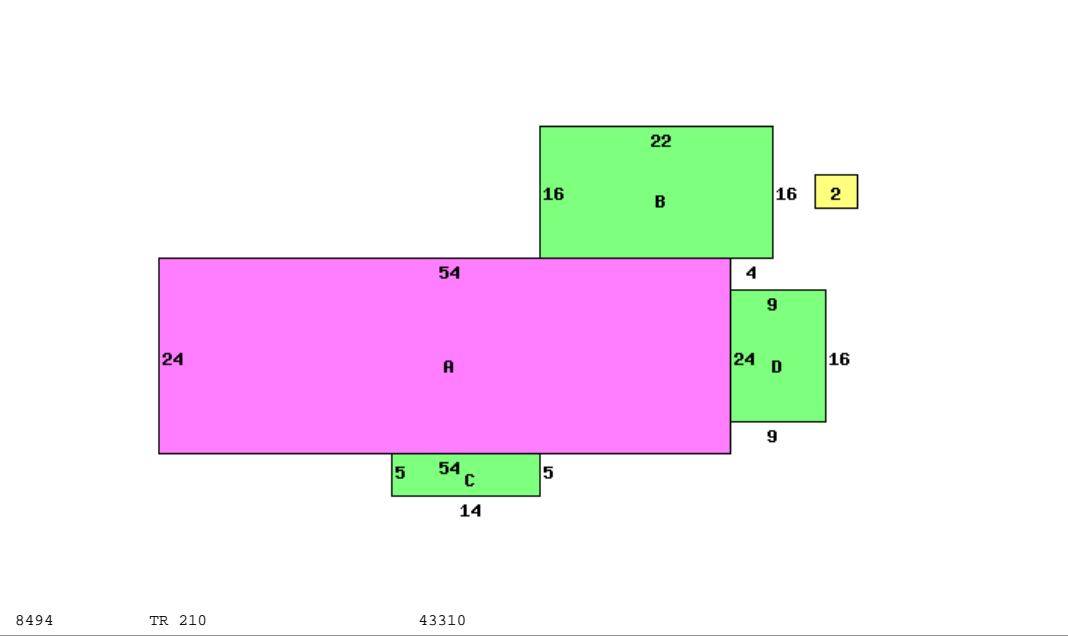

|                           |                        |                 |        |
|---------------------------|------------------------|-----------------|--------|
| Occupancy 1 Single Family | *DWELLING COMPUTATIONS |                 |        |
| Story Height 1            | Sq-Ft                  | Value           |        |
| Floor Level               | 1296                   | 107140          |        |
| Shingle                   | Subtotal               | 107140          |        |
|                           | Main                   | FRAME           |        |
|                           | Roof                   | GABLE           |        |
| Plaster/Drywall           | X                      | Plumbing        | 1400   |
| Floor/Pine                | X                      | Extra Features  | 7480   |
| Floor/Carpet              | X                      | Total Value     | 116020 |
| Number of Rooms           | 6                      |                 |        |
| Bedrooms                  | 3                      | PUB ELECTRIC    |        |
| Central Heat              | A                      | PRIV WATER      |        |
| ELECTRIC                  |                        | PRIV SEWER      |        |
| Plumbing                  |                        | PUB PAVED ST/RD |        |
| Standard                  | 1                      | Neighborhood:   |        |
| Extra 2 Fixture           | 1                      | Code:           | 3900   |
|                           |                        | Dwl/Gar/NC%     | 1.2300 |

| Bldg Type     | SHB+Cons | DixHt     | Area  | Unit   | Blt/Renov | Replace  | Phy    | Fnc | True  |
|---------------|----------|-----------|-------|--------|-----------|----------|--------|-----|-------|
| 1 DWELLING    | 1 F/C    | 1296      | 1296  |        | C-        | 1981GD   | 104420 | .28 | 92470 |
| 2 Garage      |          | 30X45     | 1350  |        | D         | 1984GD   | 25920  | .60 | 12750 |
| homesite      | acres/   | effective | depth | actual | effective | extended | true   |     |       |
| small acreage | frontage | frontage  | depth | rate   | rate      | value    | value  |     |       |
|               | 1.0000   | 15000     | 15000 | 5000   | 5000      | 10000    | 10000  |     |       |
|               | 2.0000   | 5000      | 5000  |        |           |          |        |     |       |

Call Back:

Sign: PSN Date: 2014-11-14 Lister:

42-040023.0000-v082020R