

TAYLOR CREEK TWP
BENJAMIN LOGAN SD

00390

Hardin County, Ohio
Michael T. Bacon, Auditor

42-010029.0000
F77

RES
2025

sale

Eff Rate:- 43.71 — 40.66 — 41.04 — 39.77 — a/r

| | | | | |
|------------------------------|------------|-------------|--------|--|
| 2022 CARMER FRED S & DONNA | 2006-09-26 | | | |
| 2023 CARMER FRED S & DONNA | 2006-09-26 | | | |
| 2024 CARMER FRED S & DONNA | 2006-09-26 | | | |
| 2025 CARMER FRED S & DONNA M | 2006-09-26 | 15477-15962 | 9.038A | |
| 8166 TR 190 | LWD | | | |
| KENTON OH 43326 | \$42,000 | | | |

| | | | | | |
|------------|---------|---------|---------|---------|---------|
| Tax Year | 2022 | 2023 | 2024 | 2025 | CAMA |
| Prop Cls | 511 | 511 | 511 | 511 | 511 |
| Acres | 9.0380 | 9.0380 | 9.0380 | 9.0380 | |
| Land100% | 26600 | 38370 | 38370 | 38370 | 38360 |
| Bldg100% | 451860 | 521460 | 521460 | 521460 | 521450 |
| Totl100% | 478460t | 559830t | 559830t | 559830t | 559810t |
| Cauv100% | 33490 | 33490 | 33490 | 33490 | |
| Tax Value: | | | | | |
| Land 35% | 9310 | 13430 | 13430 | 13430 | 13430 |
| Bldg 35% | 158150 | 182510 | 182510 | 182510 | 182510 |
| Totl 35% | 167460t | 195940t | 195940t | 195940t | 195930t |
| Hmstd35% | 157520 | 181710 | 181710 | 179490 | |
| Owner Oc | 152.26 | 165.06 | 164.88 | 159.08 | |
| Hmstd RB | | | | | |
| Net Tax | 6519.32 | 7090.74 | 7164.40 | 6938.32 | |
| Sp-Asmnt | 46.15 | 62.49 | 62.49 | 62.49 | |

Orig Tax Year 1995
Parent: 42-010029.0000

hmstd 5250 l 174240 b

| SHB+ | CONS | TYPE | FACT | SQ-FT | VALUE | | |
|------|------|------|------|-------|-------|---|-------|
| 2 B | F | M | | 1475 | | a | *MAIN |
| 1 B | F | A | | 210 | | b | ADDTN |
| | OFF | P | | 1082 | 32460 | c | PORCH |
| 1 | F | A | | 18 | | d | ADDTN |
| 1 B | F | A | | 182 | | e | ADDTN |
| 1 B+ | F | A | | 845 | | f | ADDTN |
| + | F | F | G | 528 | 15330 | g | GRAGE |

| Sale# | #p | sale date | To | Type/Invalid? | Sale\$ | co:land | co:bldg |
|-------|----|------------|-------------------------|---------------|--------|---------|---------|
| 589 | 1 | 2006-09-26 | CARMER FRED S & DONNA M | LWD | 42000 | 14860 | 0 |
| 157 | 1 | 2005-03-15 | BECHTEL SHAUN A & AMY M | LWD | 19000 | 14860 | 0 |

| Year | Land | Bldg | Total | Net Tax |
|------|------|--------|--------|---------|
| 2021 | 9310 | 158150 | 167460 | 6701.76 |
| 2020 | 9310 | 158150 | 167460 | 6255.18 |

| Project | ben acres | / % | factor |
|------------------------------|-----------|-----|---------|
| 100 CAMPBELL - LITTLE MIAMI | | | XA/2025 |
| 102 SHICK - LITTLE MIAMI | | | XA/2025 |
| 227 REED #979 - LITTLE MIAMI | | | XA/2025 |
| 500 HARDIN COUNTY LANDFILL | | | XA/2025 |

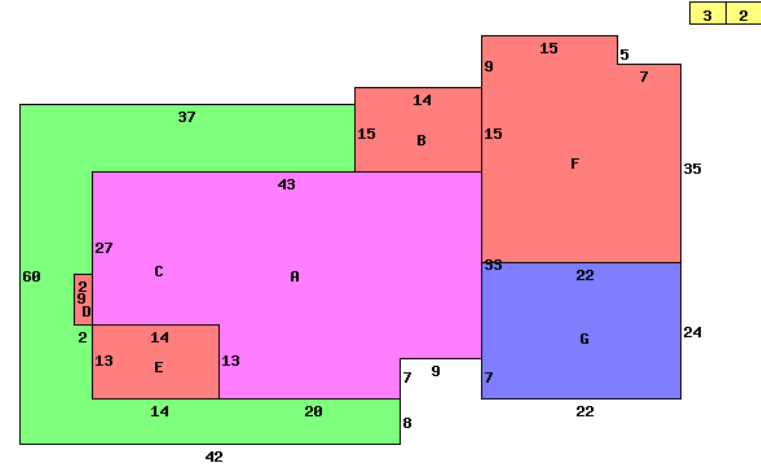

8166 TR 190 43326

| Occupancy 1 Single Family | | *DWELLING COMPUTATIONS | |
|---------------------------|------------|------------------------|-------------|
| Story Height | 2 | Sq-Ft | Value |
| Floor Level | Main | FRAME | 2730 175920 |
| | Full Upper | FRAME | 1475 69650 |
| | Qtr Story | FRAME | 1373 5190 |
| | Basement | | 2712 49870 |
| | Subtotal | | 300630 |
| Shingle | Roof | GABLE | |
| | B 1 2 U A | | |
| Plaster/Drywall | D D | Air Conditioning | 7300 |
| Unfinished Wall | X | Plumbing | 6300 |
| Floor/Carpet | X X | Garages and Carports | 15330 |
| Floor/Concrete | X | Extra Features | 32460 |
| Floor/Tile-Lino | X X | Total Value | 362020 |
| Number of Rooms | 1 6 3 | | |
| Bedrooms | 2 3 | | |
| Central Heat | A | PUB ELECTRIC | |
| F/A GEO | | PRIV WATER | |
| Central A/C | A | PRIV SEWER | |
| Plumbing | | PUB PAVED ST/RD | |
| Standard | 1 | Topo: ROLLING | |
| Extra 3 Fixture | 3 | | |
| | | Neighborhood: | |
| | | Code: | 3900 |
| | | Dwl/Gar/NC% | 1.2300 |

| Bldg Type | SHB+Cons | DixHt | Area | Unit Rate | Grade | Blt/Renov | Cond | Replace Value | Phy Dpr | Fnc Dpr | True Value |
|--------------|----------|-------|------|-----------|-------|-----------|------|---------------|---------|---------|------------|
| 1 DWELLING | 2 B+F | | 4205 | | B | 2007GD | | 470630 | .14 | | 497830 |
| 2 Pole Build | | 40X60 | 2400 | | C | 2009AV | | 28800 | .40 | | 17280 |
| 3 P | OFFP | 11X32 | 352 | | C | 2009AV | | 10560 | .40 | | 6340 |

| homesite | effective | depth | actual | effective | extended | true |
|---------------|-----------|----------|--------|-----------|----------|-------|
| small acreage | 1.0000 | frontage | rate | rate | value | value |
| road | 7.4380 | depth | factor | 15000 | 15000 | 15000 |
| | .6000 | | | 5000 | 3140 | 23360 |

Call Back:

Sign: PSN Date: 2014-11-11 Lister:

42-010029.0000-v082020R