

TAYLOR CREEK TWP-RIDGEMONT SD BM
RIDGEMONT SD/BMRT AMBULNCE

00385

Hardin County, Ohio
Michael T. Bacon, Auditor

41-120010.0000
D5.01

RES
2025

sale

Eff Rate:- 47.22 — 39.76 — 40.14 — 39.56 — a/r

| | |
|-----------------------------|------------------------|
| 2022 JARVIS MICHELE D & | 2015-10-07 |
| 2023 JARVIS MICHELLE E ETA | 2022-07-27 |
| 2024 JARVIS MICHELLE E ETA | 2022-07-27 |
| 2025 JARVIS MICHELLE E ETAL | 2022-07-27 10014 2.00A |
| 18577 US 68 | 1QC |
| KENTON OH 43326 | \$0 |

| | | | | | |
|------------|---------|---------|---------|---------|---------|
| Tax Year | 2022 | 2023 | 2024 | 2025 | CAMA |
| Prop Cls | 511 | 511 | 511 | 511 | 511 |
| Acres | 2.0000 | 2.0000 | 2.0000 | 2.0000 | 20000 |
| Land100% | 15600 | 20000 | 20000 | 20000 | 110310 |
| Bldg100% | 81230 | 110310 | 110310 | 110310 | 130310t |
| Totl100% | 96830t | 130310t | 130310t | 130310t | |
| Cauv100% | | | | | |
| Tax Value: | | | | | |
| Land 35% | 5460 | 7000 | 7000 | 7000 | 7000 |
| Bldg 35% | 28430 | 38610 | 38610 | 38610 | 38610 |
| Totl 35% | 33890t | 45610t | 45610t | 45610t | 45610t |
| Hmstd35% | | | | | |
| Owner Oc | | | | | |
| Hmstd RB | | | | | |
| Net Tax | 1457.26 | 1651.98 | 1669.18 | 1643.54 | |
| Sp-Asmnt | 23.86 | 23.86 | 32.58 | 35.58 | |

Orig Tax Year 2012
Parent: 41-120009.0000

| | | | | | | | |
|------|------|------|------|-------|-------|---|-------|
| SHB+ | CONS | TYPE | FACT | SQ-FT | VALUE | a | *MAIN |
| 2 B | F | M | | 880 | | b | ADDTN |
| 1 | F/C | A | | 144 | | c | ADDTN |
| 1 | F/C | A | | 66 | | d | PORCH |
| | OFF | P | | 210 | 6300 | e | PORCH |
| | CAN | P | | 12 | 100 | f | PORCH |
| | PAT | P | | 108 | 320 | | |

| Sale# | #p | sale date | To | Type/Invalid? | Sale\$ | co:land | co:bldg |
|-------|----|------------|------------------------|---------------|--------|---------|---------|
| 324 | 1 | 2022-07-27 | JARVIS MICHELLE E ETAL | TR 1QC * | 0 | 15600 | 81230 |
| 522 | 1 | 2015-10-07 | JARVIS MICHELE D & | 1WD | 27000 | 13510 | 61830 |
| 49 | 1 | 2015-01-29 | WELLS FARGO BANK NA | 1SH | 56000 | 13510 | 61830 |
| 498 | 1 | 2012-10-26 | FRIEND DONALD R | 1WD | 85000 | 11630 | 59200 |

| Year | Land | Bldg | Total | Net Tax |
|------|------|-------|-------|---------|
| 2021 | 5460 | 28430 | 33890 | 1506.16 |
| 2020 | 5460 | 28430 | 33890 | 1403.84 |

| Project | ben acres | % | factor |
|---------------------------------|-----------|---|---------|
| 500 HARDIN COUNTY LANDFILL | | | XA/2025 |
| 279 SILVER CREEK - SCIOTO RIVER | | | XA/2025 |
| 902 MAIN DISTRICT CONSERVANCY | | | XA/2025 |
| 364 LOWE-SCIOTO RIVER | | | XA/2025 |

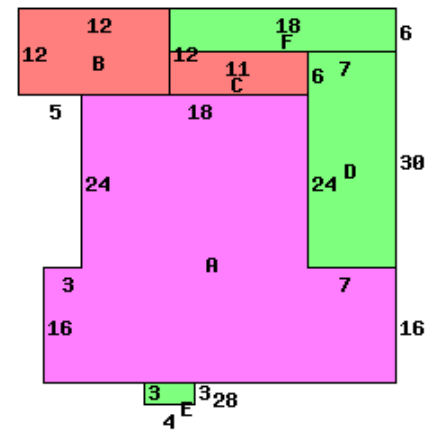

18577 US 68 43326

| | |
|---------------------------|----------------------------|
| Occupancy 1 Single Family | *DWELLING COMPUTATIONS |
| Story Height 2 | Sq-Ft Value |
| Floor Level | Main FRAME 1090 104860 |
| | Full Upper FRAME 880 60090 |
| | Basement 660 12500 |
| | Subtotal 177450 |
| Shingle | Roof HIP |
| Plaster/Drywall | P P Air Conditioning 3620 |
| Unfinished Wall | X Extra Features 6720 |
| Floor/Hardwood | X Total Value 187790 |
| Floor/Carpet | X |
| Floor/Concrete | X PUB ELECTRIC |
| Number of Rooms 1 4 4 | PRIV WATER |
| Bedrooms 1 4 | PRIV SEWER |
| Central Heat | A PUB PAVED ST/RD |
| FORCED AIR | Topo: ROLLING |
| Central A/C | A Neighborhood: |
| Plumbing | Code: 3900 |
| Standard 1 | Dwl/Gar/NC% 1.2300 |

| Bldg Type | SHB+Cons | DixHt | Area | Unit Rate | Grade | Blt/Renov | Cond | Replace Value | Phy Dpr | Fnc Dpr | True Value |
|---------------|----------|--------------------|-------|--------------|-------------|----------------|----------------|---------------|---------|---------|------------|
| 1 DWELLING | 2 B F | | 1970 | | C | OLD/AV | | 187790 | .55 | | 103940 |
| 2 Shed | *SV | 10X18 | 180 | | | OLD/FR | | 200 | | | 200 |
| 3 Shed | *SV | 18X36 | 0 | | | OLD/FR | | 500 | | | 500 |
| 4 Garage | | 22X22 | 484 | | C | 1965AV | | 11620 | .65 | | 5000 |
| 5 Shed | | 10X16 | 160 | | C | 1965AV | | 1920 | .65 | | 670 |
| homesite | 1.0000 | effective frontage | depth | depth factor | actual rate | effective rate | extended value | true value | | | |
| small acreage | 1.0000 | | | | 15000 | 15000 | 15000 | 15000 | | | |
| | | | | | 5000 | 5000 | 5000 | 5000 | | | |