

TAYLOR CREEK TWP-RIDGEMONT SD BM
RIDGEMONT SD/BMRT AMBULNCE

00385

Hardin County, Ohio
Michael T. Bacon, Auditor

41-110009.0000
G61

RES
2025

sale

Eff Rate:- 47.22 — 39.76 — 40.14 — 39.56 — a/r

2022 WEBB APRIL ACTON	2014-11-26
2023 WEBB APRIL ACTON	2014-11-26
2024 WEBB APRIL ACTON	2014-11-26
2025 WEBB APRIL ACTON	2014-11-26 SILVER CREEK ST PT 6-7
16722 TR 119	LWD 10214 1.26A
KENTON OH 43326	\$103,000

Tax Year	2022	2023	2024	2025	CAMA
Prop Cls	511	511	511	511	511
Acres	1.2600	1.2600	1.2600	1.2600	16300
Land100%	13370	16310	16310	16310	124500
Bldg100%	108540	124510	124510	124510	140800t
Totl100%	121910t	140830t	140830t	140830t	
Cauvl00%					
Tax Value:					
Land 35%	4680	5710	5710	5710	5710
Bldg 35%	37990	43580	43580	43580	43580
Totl 35%	42670t	49290t	49290t	49290t	49280t
Hmstd35%	40680	46500	46500	46500	
Owner Oc	42.90	41.18	41.14	40.96	hmstd 5250 l 41250 b
Hmstd RB					
Net Tax	1791.88	1744.10	1762.70	1735.18	
Sp-Asmnt	33.42	33.42	41.22	50.22	

SHB+	CONS	TYPE	FACT	SQ-FT	VALUE	a	*MAIN
1 B	B	M		1272		b	GRAGE
	B	G		551	15430	c	PORCH
	PAT	P		150	450	d	PORCH
	DK	P		140	2100		

#: 10 19 L/W
 #4 & #5 LESS THAN 50% AS OF 1-1-15
 411100100000 .50a
 411100190000 .09a

Sale#	#p	sale date	To	Type/Invalid?	Sale\$	co:land	co:bldg
531	1	2014-11-26	WEBB APRIL ACTON	LWD	103000	11290	40370
78	1	2012-03-02	WIELINSKI KLAUS & MARY LO	LQC *	0	11290	38630
389	1	2007-10-02	WIELINSKI KLAUS	LWD *	0	10690	35510
43	1	2005-02-15	WIELINSKI IRMA	LCT *	0	8770	30910

Year	Land	Bldg	Total	Net Tax
2021	4680	37990	42670	1852.68
2020	4680	37990	42670	1723.80

Project	ben acres	%	factor
902 MAIN DISTRICT CONSERVANCY			XA/2025
279 SILVER CREEK - SCIOTO RIVER			XA/2025
500 HARDIN COUNTY LANDFILL			XA/2025
364 LOWE-SCIOTO RIVER			XA/2025

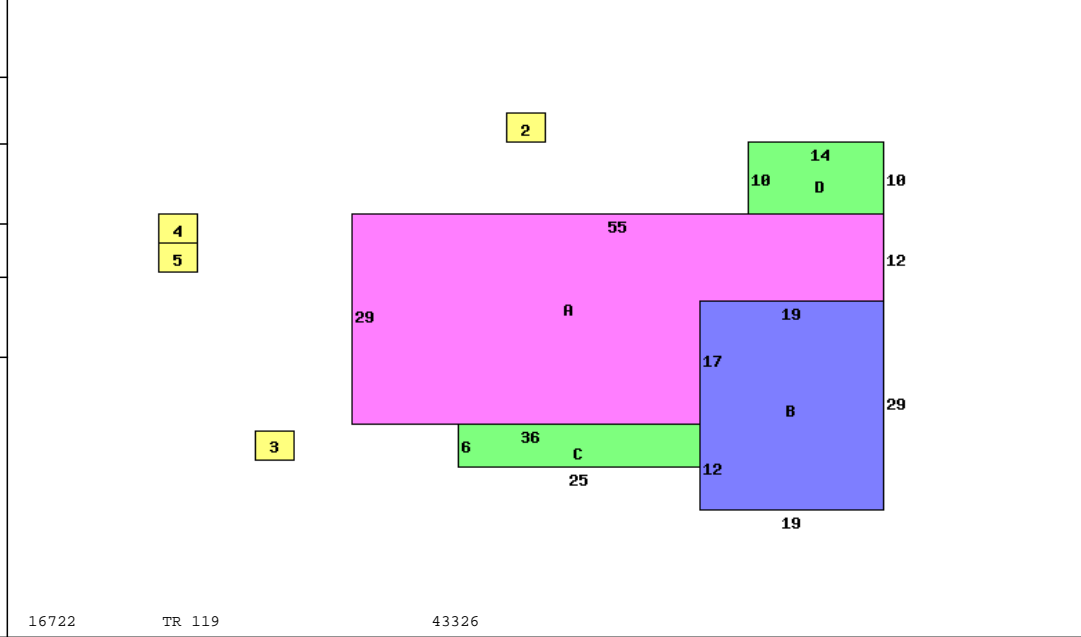

Occupancy 1 Single Family		*DWELLING COMPUTATIONS	
Story Height	1	Sq-Ft	Value
Floor Level	Main	BRICK	1272 115820
	Basement		1272 23550
	Subtotal		139370
Shingle	Roof	GABLE	
B 1 2 U A			
Panelled Wall	X	Air Conditioning	2290
Unfinished Wall	X	Plumbing	1400
Floor/Hardwood	X	Garages and Carports	15430
Floor/Carpet	X	Extra Features	2550
Number of Rooms	5	Total Value	161040
Bedrooms	3		
Central Heat	A	PUB ELECTRIC	
FORCED AIR		PRIV WATER	
Central A/C	A	PRIV SEWER	
Plumbing		Neighborhood:	
Standard	1	Code:	3900
Extra 2 Fixture	1	Dwl/Gar/NC%	1.2300

Bldg Type	SHB+Cons	DixHt	Unit	Grade	Blt/Renov	Replace	Phy	Fnc	True
1 DWELLING	1 B B	1272		D+	1979AV	136880	.30	Dpr	117850
2 Shed	*SV 0	12X16	192		OLD/FR	200			200
3 Shed	*PP		0		OLD/	0			0
4 Pole Build		24X24	576	C	2014AV	6910	.30		4840
5 P	CAN0	12X24	288	C	2014AV	2300	.30		1610
homesite	1.0000	effective	depth	actual	effective	extended	true		
small acreage	.2600	frontage	depth	rate	rate	value	value		
				15000	15000	15000	15000		
				5000	5000	1300	1300		

Call Back:

Sign: PSN Date: 2016-01-28 Lister:

41-110009.0000-v082020R