

TAYLOR CREEK TWP-RIDGEMONT SD BM
RIDGEMONT SD/BMRT AMBULNCE

00385

Hardin County, Ohio
Michael T. Bacon, Auditor

41-100028.0000
G53

RES
2025

sale

2022 BUCK EMILY	2020-11-04
2023 BUCK EMILY	2020-11-04
2024 BUCK EMILY	2020-11-04
2025 BUCK EMILY	2020-11-04 10024 ETC 7.895A
11384 CR 190	LWD
KENTON OH 43326	\$300,000

Eff Rate:-	47.22	39.76	40.14	39.56	a/r
Tax Year	2022	2023	2024	2025	2025
Prop Cls	511	511	511	511	511
Acres	7.8950	7.8950	7.8950	7.8950	7.8950
Land100%	26200	37630	37630	37630	37630
Bldg100%	207460	230200	230200	230200	230200
Totl100%	233660t	267830t	267830t	267830t	267830t
Cauvl00%					

Orig Tax Year 1996
Parent: 41-100009.0000

Tax Value:	9170	13170	13170	13170	13170	13170
Land 35%	72610	80570	80570	80570	80570	80570
Bldg 35%	81780t	93740t	93740t	93740t	93740t	93740t
Totl 35%	75270	83800	83800	83800	83800	83800
Hmstd35%	79.36	74.22	74.14	73.84	73.84	73.84
Owner Oc						
Hmstd RB						
Net Tax	3437.12	3321.02	3356.42	3304.02	3304.02	
Sp-Asmnt	25.81	25.81	42.63	42.74		

SHB+	CONS	TYPE	FACT	SQ-FT	VALUE	a	*MAIN
1 B	F	M		1144		b	ADDTN
1 B	F	A		324		c	OTHER
	VAULT	X		324		d	PORCH
	OFF	P		144	4320	e	ADDTN
	F	F		777		f	GRAGE
	DK	P		400	11620	g	PORCH
	OFF	P		392	5880	h	PORCH
	PAT	P		120	3600	i	PORCH
				120	360		

Sale#	#p	sale date	To	Type/Invalid?	Sale\$	co:land	co:bldg
514	1	2020-11-04	BUCK EMILY	LWD	300000	25570	174340
44	1	2019-02-19	HARP KAREN S	LQC *	0	25570	174340
224	1	1995-03-31	HARP DAVID L & KAREN S	LWD	24500	0	0

Year	Land	Bldg	Total	Net Tax
2021	9170	72610	81780	3553.68
2020	9170	72610	81780	2953.68

project	ben acres	/ %	factor
279 SILVER CREEK - SCIOTO RIVER			XA/2025
500 HARDIN COUNTY LANDFILL			XA/2025
902 MAIN DISTRICT CONSERVANCY			XA/2025

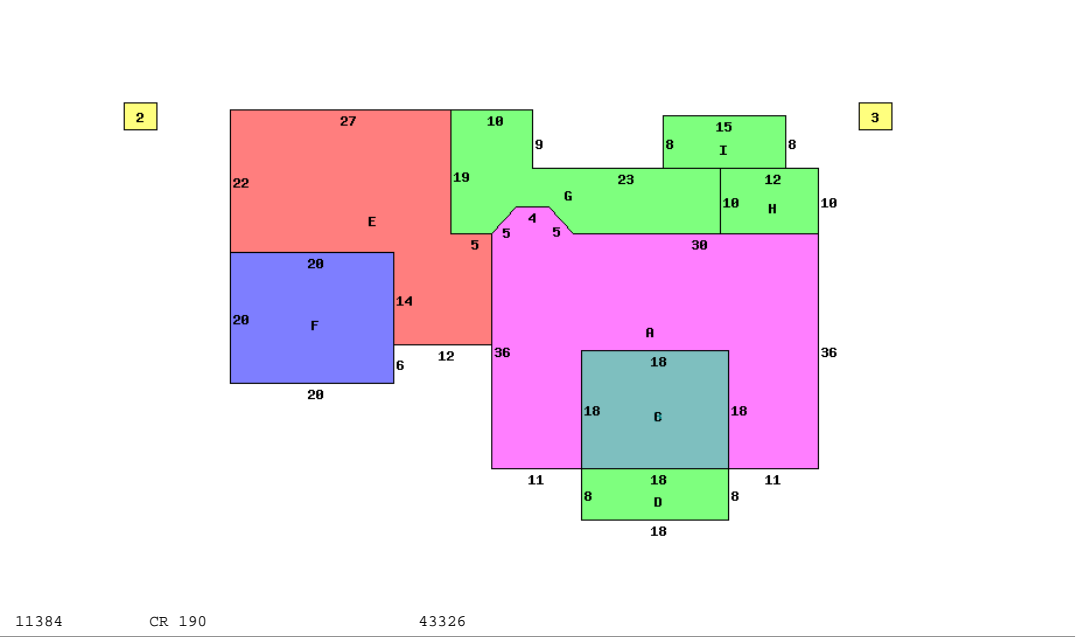

11384 CR 190 43326

Occupancy 1 Single Family	*DWELLING COMPUTATIONS
Story Height 1	Sq-Ft Value
Floor Level	Main FRAME 2245 150300
	Basement 1468 27160
	Subtotal 177460
Shingle	Roof GABLE
Plaster/Drywall	D Fireplaces 2000
Unfinished Wall	X Air Conditioning 3930
Floor/Carpet	X Plumbing 3500
Floor/Concrete	X Garages and Carports 11620
Number of Rooms	2 8 Extra Features 14160
Bedrooms	3 Total Value 212670
Fireplace	PUB ELECTRIC
Openings	1 PRIV WATER
Stacks	1 PRIV SEWER
Central Heat	A PUB PAVED ST/RD
FORCED AIR	Topo: LEVEL
Central A/C	A
Plumbing	Neighborhood: S
Standard	1
Extra 3 Fixture	1 Code: 3900
Extra 2 Fixture	1 Dwl/Gar/NC% 1.2300

Bldg Type	SHB+Cons	DixHt	Area	Unit	Grade	Blt/Renov	Replace	Phy	Fnc	True
1 DWELLING	1 B F	2245	2245		C+	1997GD	233940	.22		224440
2 Pole Build	M	24X40	960		C	2005AV	11520	.50		5760
3 Shed	*PP	10X14	140			1997AV	0			0
homesite	1.0000	effective	depth	actual	effective	extended	true			
small acreage	6.8950	frontage	depth	rate	rate	value	value			
				15000	15000	15000	15000			
				5000	3280	22620	22620			

Neighborhood:	S
Code:	3900
Dwl/Gar/NC%	1.2300