

TAYLOR CREEK TWP
RIDGEMONT SD/SE AMBULANCE

00380

Hardin County, Ohio
Michael T. Bacon, Auditor

40-190042.0000
A36.01

AGR
2025

sale

2023 GLICK MILO P & LOVINA
2024 GLICK MILO P ETAL
2025 GLICK MILO P ETAL
14351 TR 206
RIDGEWAY OH 43345

2023-04-28
2023-04-28 10500 50.937A
1SD
\$0

Orig Tax Year 2024
Parent: 40-190010.0000

Eff Rate:-	37.83	38.20	37.43	a/r
Tax Year	2023	2024	2025	CAMA
Prop Cls	111	111	111	111
Acres		50.9370	50.9370	
Land100%		308600	308600	311320
Bldg100%		103770	103770	103780
Totl100%		412370t	412370t	415100t
Cauv100%	144090	149710	149710	149720
Tax Value:				
Land 35%	50430	52400	52400	108960
Bldg 35%		36320	36320	36320
Totl 35%	50430t	88720t	88720t	145290t
Hmstd35%		30630	30630	
Owner Oc			26.84	hmstd 3220 l 27410 b
Hmstd RB				
Net Tax	1728.96	3075.40	2982.86	
		1927.68	1886.48	
Sp-Asmnt	2.00	35.58	35.58	

SHB+ 1	CONS F/S	TYPE M	FACT	SQ-FT 1248	VALUE	a	*MAIN
Sale# 172	#p 1	sale date 2023-04-28	To GLICK MILO P ETAL	Type/Invalid? 1SD *	Sale\$ 0	co:land 0	co:bldg 0
p r o j e c t				ben acres	/	%	factor
902 MAIN DISTRICT CONSERVANCY				XA/2025			
500 HARDIN COUNTY LANDFILL				XA/2025			

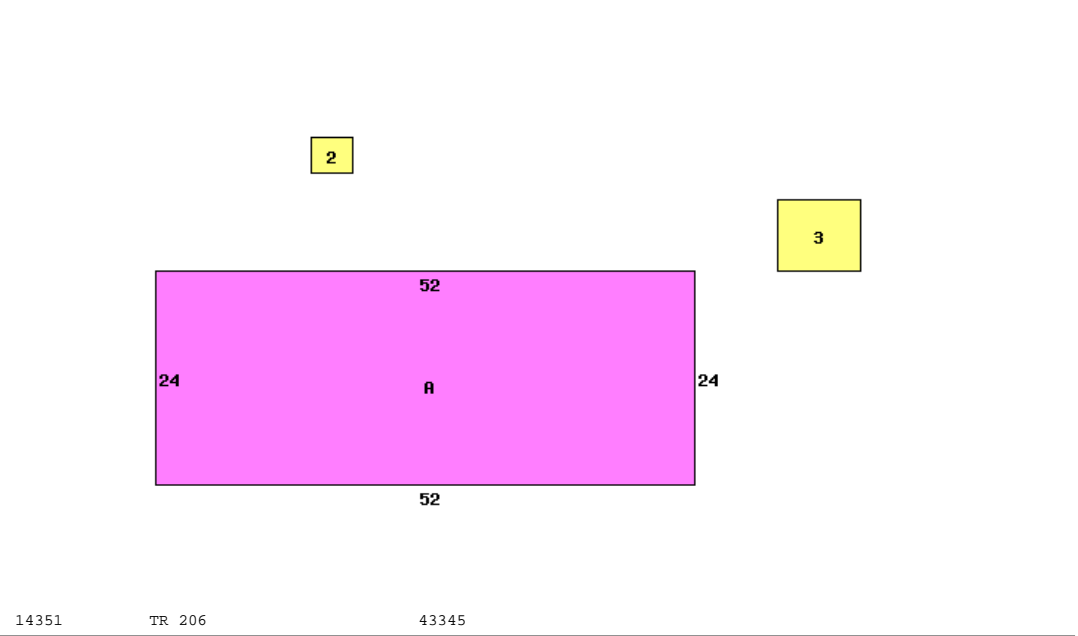

Occupancy 1 Single Family	*DWELLING COMPUTATIONS
Story Height 1	Sq-Ft Value
Floor Level	Main FRAME 1248 106850
	Subtotal 106850
B 1 2 U A	
Heating	-1520
Plumbing	-3800
Total Value	101530
Neighborhood:	
Code:	3900
Dwl/Gar/NC%	1.2300

Bldg Type	SHB+Cons	DixHt	Unit	Grade	Blt/Renov	Replace	Phy	Fnc	True
1 DWELLING	1 F/S	1248		D	2023AV	81220	.02	.20	78320
2 Shed		24X12 288		D	2023AV	2770	.05	.20	2110
3 Flat Barn		40X80 3200		D	2023AV	30720	.05	.20	23350
Tab #	S O I L	Acres	Mkt/Ac	Market	Au/Ac	Cauv			
C 1	BOA BLOUNT SILT LOAM 0-	4.8207	6030	29070	2660	12820			
C 2	BOB BLOUNT SILT LOAM, 2	27.4289	5770	158260	2360	64730			
C 39	PM PEWAMO SILTY CLAY L	17.6874	6490	114790	3560	62970			
680	HSITE HOMESITE - AMISH DW	1.0000	9200	9200	9200	9200			
		50.937		311320	(100%)	149720			CAUV # 4536
				108960	(35%)	52400			