

TAYLOR CREEK TWP
RIDGEMONT SD/SE AMBULANCE

00380

Hardin County, Ohio
Michael T. Bacon, Auditor

40-190031.0000
A22

RES
2025

sale

Eff Rate:- 45.31 — 37.83 — 38.20 — 37.43 — a/r

| | | | | | |
|------|------------------------|------------|-------|-------|--|
| 2022 | MAGANN ANGELA & DARRY | 2020-01-13 | | | |
| 2023 | MAGANN ANGELA & DARRY | 2020-01-13 | | | |
| 2024 | MAGANN ANGELA & DARRY | 2020-01-13 | | | |
| 2025 | MAGANN ANGELA & DARRYL | 2020-01-13 | 10050 | 6.09A | |
| | 14254 CR 200 | | 1WD | | |
| | RIDGEWAY OH 43345 | | \$0 | | |

| | | | | | |
|----------|---------|---------|---------|---------|---------|
| Tax Year | 2022 | 2023 | 2024 | 2025 | CAMA |
| Prop Cls | 511 | 511 | 511 | 511 | 511 |
| Acres | 6.0900 | 6.0900 | 6.0900 | 6.0900 | |
| Land100% | 24000 | 34000 | 34000 | 34000 | 33990 |
| Bldg100% | 177090 | 210110 | 210110 | 210110 | 210120 |
| Totl100% | 201090t | 244110t | 244110t | 244110t | 244110t |

Orig Tax Year 2000
Parent: 40-190005.0000

| | | | | | |
|------------|---------|---------|---------|---------|----------------------|
| Tax Value: | | | | | |
| Land 35% | 8400 | 11900 | 11900 | 11900 | 11900 |
| Bldg 35% | 61980 | 73540 | 73540 | 73540 | 73540 |
| Totl 35% | 70380t | 85440t | 85440t | 85440t | 85440t |
| Hmstd35% | 60350 | 69100 | 69100 | 69100 | |
| Owner Oc | 63.72 | 61.18 | 61.12 | 60.54 | hmstd 5250 l 63850 b |
| Hmstd RB | | | | | |
| Net Tax | 2828.06 | 2868.04 | 2900.58 | 2837.88 | |
| Sp-Asmnt | 21.49 | 21.49 | 33.29 | 33.29 | |

| | | | | | | | |
|------|------|------|------|-------|-------|---|-------|
| SHB+ | CONS | TYPE | FACT | SQ-FT | VALUE | a | *MAIN |
| 1 B | F | M | | 242 | | b | ADDTN |
| 1 | F/C | A | | 936 | | c | PORCH |
| | OFF | P | | 290 | 8700 | d | ADDTN |
| 1 | F/C | A | | 568 | | e | PORCH |
| | OFF | P | | 270 | 8100 | f | ADDTN |
| 1 + | F/C | A | | 240 | | | |

| Sale# | #p | sale date | To | Type/Invalid? | Sale\$ | co:land | co:bldg |
|-------|----|------------|-------------------------|---------------|--------|---------|---------|
| 16 | 1 | 2020-01-13 | MAGANN ANGELA & DARRYL | WH LWD * | 0 | 23370 | 151800 |
| 115 | 1 | 2005-02-22 | MAGANN ANGELA R | LWD | 157000 | 24800 | 141540 |
| 343 | 1 | 2001-07-12 | FOX CHARLES & KATHY | LWD | 58000 | 48170 | 1690 |
| 157 | 1 | 1999-03-31 | SCHWARTZ JOSEPH & IRENE | LSD | 49185 | 0 | 0 |

| Year | Land | Bldg | Total | Net Tax |
|------|------|-------|-------|---------|
| 2021 | 8400 | 61980 | 70380 | 2845.34 |
| 2020 | 8400 | 61980 | 70380 | 2850.12 |

| Project | ben acres | % | factor |
|-------------------------------|-----------|---|---------|
| 500 HARDIN COUNTY LANDFILL | | | XA/2025 |
| 902 MAIN DISTRICT CONSERVANCY | | | XA/2025 |

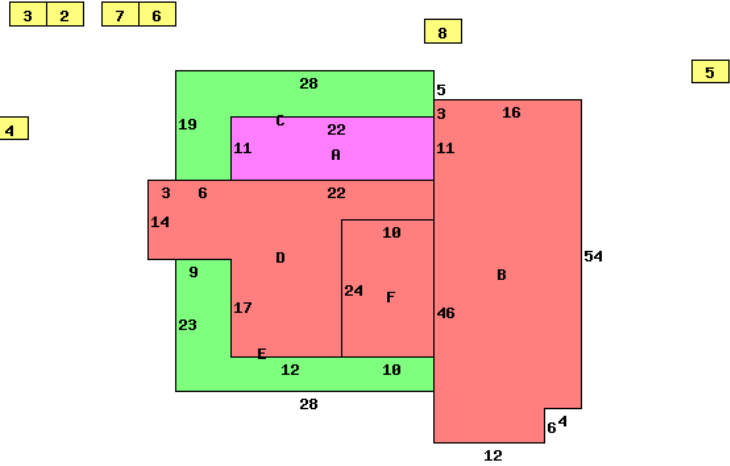

14254 CR 200 43345

| | |
|---------------------------|-------------------------|
| Occupancy 1 Single Family | *DWELLING COMPUTATIONS |
| Story Height 1 | Sq-Ft Value |
| Floor Level | 1986 136900 |
| Main | FRAME |
| Qtr Story | FRAME 240 1060 |
| Basement | 242 4960 |
| Subtotal | 142920 |
| Shingle | Roof GABLE |
| Plaster/Drywall | D Air Conditioning 3520 |
| Unfinished Wall | X Plumbing 2100 |
| Floor/Carpet | X Extra Features 16800 |
| Floor/Concrete | X Total Value 165340 |
| Number of Rooms | 1 6 |
| Bedrooms | 3 |
| Central Heat | A PUB ELECTRIC |
| FORCED AIR | PRIV WATER |
| Central A/C | A PRIV SEWER |
| Plumbing | PUB PAVED ST/RD |
| Standard | 1 Neighborhood: |
| Extra 3 Fixture | 1 Code: 3900 |
| | Dwl/Gar/NC% 1.2300 |

| Bldg Type | SHB+Cons | DixHt | Unit | Grade | Blt/Renov | Replace | Phy | Fnc | True |
|---------------|----------|-----------|-------|--------|-----------|----------|-------|-----|--------|
| 1 DWELLING | 1 B F | 1986 | | C | 2001GD | 165340 | .19 | | 164730 |
| 2 Shed | | 24X40 | 960 | D | OLD/PR | 9220 | .75 | .50 | 1150 |
| 3 P | CAN | 16X40 | 640 | D | OLD/PR | 4100 | .75 | | 1030 |
| 4 Garage | F | 30X40 | 1200 | C | 2006AV | 28800 | .50 | | 17710 |
| 5 POND | *.45A | | 0 | | OLD/ | 0 | | | 0 |
| 6 Pole Build | | 40X50 | 2000 | C | 2017AV | 24000 | .20 | | 19200 |
| 7 P | OFF | 8X16 | 128 | C | 2017AV | 3840 | .20 | | 3070 |
| 8 Shed | | 30X32 | 960 | D | 1900AV | 9220 | .65 | | 3230 |
| | acres/ | effective | depth | actual | effective | extended | true | | |
| homesite | frontage | frontage | depth | rate | rate | value | value | | |
| small acreage | 5.0900 | | | 15000 | 15000 | 15000 | 15000 | | |
| | | | | 5000 | 3730 | 18990 | 18990 | | |