

ROUNDHEAD TWP
UPPER SCIOTO SD

00360

Hardin County, Ohio
Michael T. Bacon, Auditor

37-290055.0000
A10.02

RES
2025

sale

Eff Rate:- 45.43 — 41.39 — 40.07 — 40.02 — a/r

| | | | | |
|----------------------|------------|-------|--------|--|
| 2022 GRATZ BLAKE A | 2019-12-12 | | | |
| 2023 GRATZ BLAKE A | 2019-12-12 | | | |
| 2024 GRATZ BLAKE A | 2019-12-12 | | | |
| 2025 GRATZ BLAKE A | 2019-12-12 | 10009 | 5.588A | |
| 1732 SR 385 | 1FD | | | |
| WAYNESFIELD OH 45896 | \$200,000 | | | |

| | | | | | |
|----------|---------|---------|---------|---------|---------|
| Tax Year | 2022 | 2023 | 2024 | 2025 | CAMA |
| Prop Cls | 511 | 511 | 511 | 511 | 511 |
| Acres | 5.5880 | 5.5880 | 5.5880 | 5.5880 | |
| Land100% | 23200 | 32710 | 32710 | 32710 | 32710 |
| Bldg100% | 213060 | 243140 | 243140 | 243140 | 243450 |
| Totl100% | 236260t | 275860t | 275860t | 275860t | 276160t |
| Cauv100% | | | | | |

Orig Tax Year 2020
Parent: 37-290051.0000

| | | | | | |
|------------|---------|---------|---------|---------|--------|
| Tax Value: | | | | | |
| Land 35% | 8120 | 11450 | 11450 | 11450 | 11450 |
| Bldg 35% | 74570 | 85100 | 85100 | 85100 | 85210 |
| Totl 35% | 82690t | 96550t | 96550t | 96550t | 96660t |
| Hmstd35% | | | | | |
| Owner Oc | | | | | |
| Hmstd RB | | | | | |
| Net Tax | 3402.40 | 3652.64 | 3541.80 | 3537.34 | |
| Sp-Asmnt | 18.00 | 18.00 | 104.60 | 104.60 | |

| | | | | | | |
|----------|--------|--------|--------|------------|------------|---------|
| SHB+ 1 B | CONS B | TYPE M | FACT G | SQ-FT 2472 | VALUE 1200 | a *MAIN |
| | BAS1 | P | G | 288 | 11520 | b GRACE |
| | EFF | P | | 288 | 1200 | c PORCH |
| | BAS1 | G | | 132 | 3960 | d GRACE |
| | EFF | P | | 352 | 14080 | e PORCH |
| | CAN | P | | 84 | 670 | f PORCH |
| | PAT | P | | 264 | 790 | g PORCH |
| | F | A | | 288 | | h PORCH |
| | | | | | | i ADDTN |

| | | | | | | | |
|-----------|-----------|----------------------|------------------|-------------------|---------------|-----------|-----------|
| Sale# 553 | #p 1 | sale date 2019-12-12 | To GRATZ BLAKE A | Type/Invalid? 1FD | Sale\$ 200000 | co:land 0 | co:bldg 0 |
| Year 2021 | Land 8120 | Bldg 74570 | Total 82690 | Net Tax 3591.98 | | | |
| 2020 | 8120 | 74570 | 82690 | 4289.10 | | | |

project 500 HARDIN COUNTY LANDFILL XA/2025
902 MAIN DISTRICT CONSERVANCY XA/2025

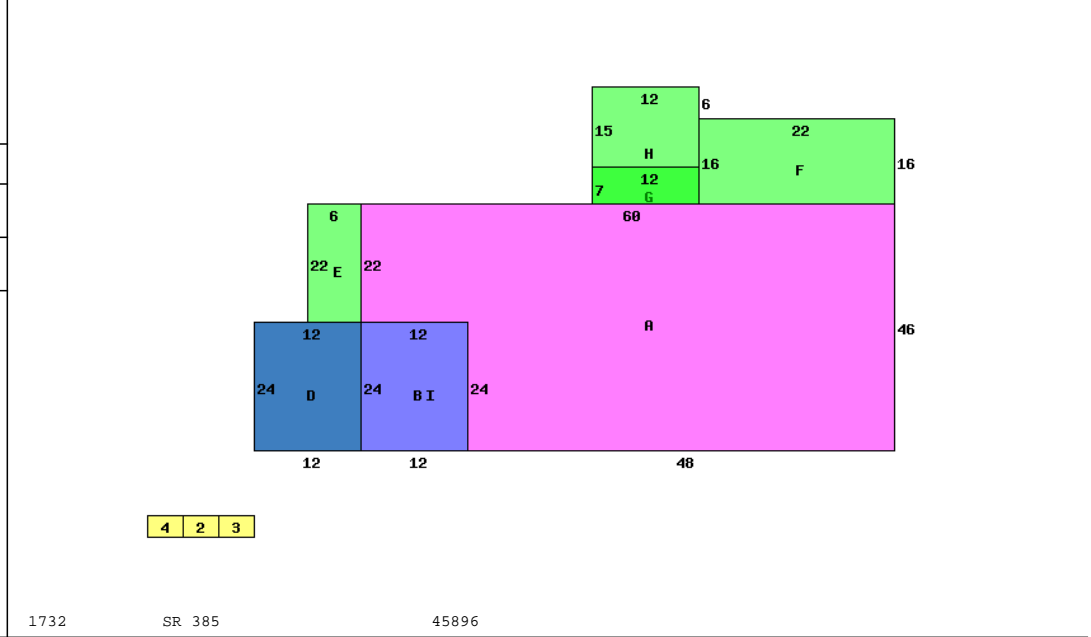

1732 SR 385 45896

| | | |
|---------------------------|------------------------|---------------------------|
| Occupancy 1 Single Family | *DWELLING COMPUTATIONS | |
| Story Height 1 | Sq-Ft | Value |
| Floor Level | | |
| | Main BRICK | 2760 194470 |
| | Basement | 2472 45440 |
| | Subtotal | 239910 |
| Shingle | Roof GABLE | |
| | B 1 2 U A | |
| Plaster/Drywall | D 600 sq ft | Basement Finish 6560 |
| Unfinished Wall | X | Fireplaces 4000 |
| Floor/Carpet | X | Air Conditioning 4750 |
| Floor/Concrete | X | Plumbing 4200 |
| Floor/Tile-Lino | L | Garages and Carports 2400 |
| Number of Rooms | 2 6 | Extra Features 31020 |
| Bedrooms | 3 | Total Value 292840 |
| Fireplace | | |
| Openings | 2 | Neighborhood: |
| Stacks | 1 | Code: 3800 |
| Central Heat | A | Dwl/Gar/NC% 1.0800 |
| HOT WATER | | |
| Central A/C | A | |
| Plumbing | | |
| Standard | 1 | |
| Extra 3 Fixture | 2 | |

| | | | | | | | | |
|---------------|----------|-----------|-------|-----------|-----------|----------|-------|--------|
| Bldg Type | SHB+Cons | DixHt | Unit | Blt/Renov | Replace | Phy | Fnc | True |
| 1 DWELLING | 1 B B | 3360 | | C+ | 1967GD | 322120 | .35 | 226130 |
| 2 Pole Build | | 44X92 | 4048 | C | 1975AV | 48580 | .65 | 17000 |
| 3 Grain Bin | *PP | 24X18 | 432 | C | 1965FR | 0 | | 0 |
| 4 P | CAN | 10X14 | 140 | D | 1980AV | 900 | .65 | 320 |
| homesite | acres/ | effective | depth | actual | effective | extended | true | |
| small acreage | frontage | frontage | depth | rate | rate | value | value | |
| | 1.0000 | | | 15000 | 15000 | 15000 | 15000 | |
| | 4.5880 | | | 5000 | 3860 | 17710 | 17710 | |