

ROUNDHEAD TWP  
UPPER SCIOTO SD

00360

Hardin County, Ohio  
Michael T. Bacon, Auditor

37-240024.0000  
H88

RES  
2025

sale

Eff Rate:- 45.43 — 41.39 — 40.07 — 40.02 — a/r

|                              |                      |
|------------------------------|----------------------|
| 2022 BRUSH JR BOBBY L & DE   | 1994-03-23           |
| 2023 BRUSH JR BOBBY L & DE   | 1994-03-23           |
| 2024 BRUSH JR BOBBY L & DE   | 1994-03-23           |
| 2025 BRUSH JR BOBBY L & DEBR | 1994-03-23           |
| 17939 HIGH                   | CARTERS PT W 1/2 5-6 |
|                              | LWD                  |
| ROUNDHEAD OH 43346           | \$36,000             |

|          |        |        |        |        |        |
|----------|--------|--------|--------|--------|--------|
| Tax Year | 2022   | 2023   | 2024   | 2025   | CAMA   |
| Prop Cls | 510    | 510    | 510    | 510    | 510    |
| Acres    |        |        |        |        |        |
| Land100% | 2630   | 3710   | 3710   | 3710   | 3700   |
| Bldg100% | 51740  | 61090  | 61090  | 61090  | 61080  |
| Totl100% | 54370t | 64800t | 64800t | 64800t | 64780t |
| Cauv100% |        |        |        |        |        |

|                             |            |
|-----------------------------|------------|
| 2026 SCHNEER DAVID & PAMELA | 2025-06-30 |
| 17939 HIGH                  | LWD        |
| ROUNDHEAD OH 43346          |            |

|            |        |        |        |        |                      |
|------------|--------|--------|--------|--------|----------------------|
| Tax Value: |        |        |        |        |                      |
| Land 35%   | 920    | 1300   | 1300   | 1300   | 1300                 |
| Bldg 35%   | 18110  | 21380  | 21380  | 21380  | 21380                |
| Totl 35%   | 19030t | 22680t | 22680t | 22680t | 22670t               |
| Hmstd35%   | 19030  | 22680  | 22680  | 22680  |                      |
| Owner Oc   | 20.38  | 20.18  | 19.18  | 19.20  | hmstd 1300 l 21380 b |
| Hmstd RB   |        |        |        |        |                      |
| Net Tax    | 762.62 | 837.86 | 812.82 | 811.74 |                      |
| Sp-Asmnt   | 26.78  | 26.78  | 42.73  | 42.73  |                      |

|      |      |      |      |       |       |   |       |
|------|------|------|------|-------|-------|---|-------|
| SHB+ | CONS | TYPE | FACT | SQ-FT | VALUE | a | *MAIN |
| 1    | F/C  | M    |      | 994   |       | b | PORCH |
|      | OFF  | P    |      | 170   | 5100  | c | PORCH |
|      | OFF  | P    |      | 30    | 900   |   | PORCH |

#: 25 L/W  
372400250000

| Sale# | #p | sale date  | To                       | Type/Invalid? | Sale\$ | co:land | co:bldg |
|-------|----|------------|--------------------------|---------------|--------|---------|---------|
| 272   | 1  | 2025-06-30 | SCHNEER DAVID & PAMELA   | LWD           | 142355 | 3710    | 61090   |
| 220   | 1  | 1994-03-23 | BRUSH JR BOBBY L & DEBRA | LWD           | 36000  | 0       | 30430   |
| 529   | 0  | 1988-07-15 |                          | *             | 25000  | 0       | 24830   |
| 1016  | 0  | 1987-12-07 |                          | *             | 0      | 0       | 24830   |

| Year | Land | Bldg  | Total | Net Tax |
|------|------|-------|-------|---------|
| 2021 | 920  | 18110 | 19030 | 805.10  |
| 2020 | 920  | 18110 | 19030 | 815.94  |

| Project                       | ben acres | % | factor  |
|-------------------------------|-----------|---|---------|
| 902 MAIN DISTRICT CONSERVANCY |           |   | XA/2025 |
| 500 HARDIN COUNTY LANDFILL    |           |   | XA/2025 |

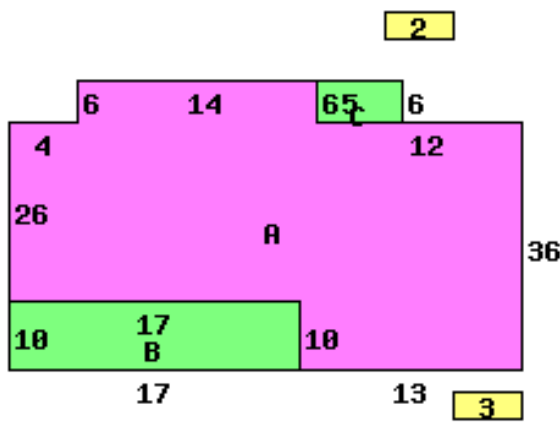

17939 HIGH ST 43346

|                           |                        |                |        |
|---------------------------|------------------------|----------------|--------|
| Occupancy 1 Single Family | *DWELLING COMPUTATIONS |                |        |
| Story Height 1            | Sq-Ft                  | Value          |        |
| Floor Level               | 994                    | 104350         |        |
| Shingle                   | Subtotal               | 104350         |        |
|                           | Roof                   |                |        |
| Plaster/Drywall           | D                      | Extra Features | 6000   |
| Floor/Carpet              | X                      | Total Value    | 110350 |
| Floor/Tile-Lino           | L                      |                |        |
| Number of Rooms           | 6                      | PUB ELECTRIC   |        |
| Bedrooms                  | 2                      | PRIV WATER     |        |
| Central Heat              | A                      | PRIV SEWER     |        |
| WALL GAS                  |                        | PUB ALLEY      |        |
| Plumbing                  |                        | Neighborhood:  |        |
| Standard                  | 1                      | Code:          | 3810   |
|                           |                        | Dwl/Gar/NC%    | .8000  |

| Bldg Type  | SHB+Cons | DixHt     | Unit  | Blt/Renov | Replace | Phy       | Fnc      | True  |
|------------|----------|-----------|-------|-----------|---------|-----------|----------|-------|
| 1 DWELLING | 1 F/C    |           |       | Grade     | Cond    | Value     | Dpr      | Value |
| 2 Shed     | *PP      | 0         | 12X12 | 144       | 1962PR  | 0         |          | 0     |
| 3 Garage   |          |           | 24X24 | 576       | 1977AV  | 13820     | .65      | 3870  |
| front lot  | acres/   | effective | depth | depth     | actual  | effective | extended | true  |
|            | frontage | frontage  | depth | factor    | rate    | rate      | value    | value |
|            |          | 66.00     | 132   | 94        | 60      | 56        | 3700     | 3700  |