

ROUNDHEAD TWP
UPPER SCIOTO SD

00360

Hardin County, Ohio
Michael T. Bacon, Auditor

37-180015.0000
B17

RES
2025

sale

Eff Rate:- 45.43 — 41.39 — 40.07 — 40.02 — a/r

| | |
|-----------------------------|-------------------------------------|
| 2022 RITTENOUR THOMAS DARYL | 2013-02-28 |
| 2023 RITTENOUR THOMAS DARYL | 2013-02-28 |
| 2024 RITTENOUR THOMAS DARYL | 2013-02-28 |
| 2025 RITTENOUR THOMAS DARYL | 2013-02-28 S 1/2 SE 1/4 PT 29 5.50A |
| 16953 SR 117 | LWD |
| ROUNDHEAD OH 43346 | \$154,000 |

| | | | | | |
|------------|---------|---------|---------|---------|---------|
| Tax Year | 2022 | 2023 | 2024 | 2025 | CAMA |
| Prop Cls | 511 | 511 | 511 | 511 | 511 |
| Acres | 5.5000 | 5.5000 | 5.5000 | 5.5000 | 32460 |
| Land100% | 23090 | 32460 | 32460 | 32460 | 150470 |
| Bldg100% | 126710 | 150460 | 150460 | 150460 | 182930t |
| Totl100% | 149800t | 182910t | 182910t | 182910t | |
| Cauv100% | | | | | |
| Tax Value: | | | | | |
| Land 35% | 8080 | 11360 | 11360 | 11360 | 11360 |
| Bldg 35% | 44350 | 52660 | 52660 | 52660 | 52660 |
| Totl 35% | 52430t | 64020t | 64020t | 64020t | 64030t |
| Hmstd35% | | | | | |
| Owner Oc | | | | | |
| Hmstd RB | | | | | |
| Net Tax | 2157.30 | 2421.98 | 2348.48 | 2345.52 | |
| Sp-Asmnt | 45.30 | 39.97 | 87.69 | 87.69 | |

| | | | | | | |
|----------|--------|--------|--------|------------|-------------|---------|
| SHB+ 1 B | CONS F | TYPE M | FACT G | SQ-FT 1200 | VALUE 16700 | a *MAIN |
| | F2 | G | | 696 | 16700 | b GRAGE |
| | DK | P | | 80 | 1200 | c PORCH |
| | STP | P | | 18 | 70 | d PORCH |
| | FFP | P | | 288 | 11520 | e PORCH |
| | DK | P | | 256 | 3840 | f PORCH |

| | | | | | | | |
|----------|------|----------------------|------------------------------|-------------------|---------------|---------------|---------------|
| Sale# 96 | #p 1 | sale date 2013-02-28 | To RITTENOUR THOMAS DARYL ET | Type/Invalid? LWD | Sale\$ 154000 | co:land 20970 | co:blgd 74970 |
| 94 | 1 | 2011-03-14 | WURST JOSEPH A & LETITIA | 1SD * | 20940 | 0 | 64570 |
| 664 | 1 | 1998-11-13 | WURST JOSEPH A | 1FD | 67500 | 11860 | 43110 |

| | | | | |
|-----------|-----------|------------|-------------|-----------------|
| Year 2021 | Land 8080 | Bldg 44350 | Total 52430 | Net Tax 2277.50 |
| 2020 | 8080 | 44350 | 52430 | 2308.14 |

| | | |
|---------------------------------------|---------|----------------------|
| Project 902 MAIN DISTRICT CONSERVANCY | XA/2025 | ben acres / % factor |
| 304 LAUTENSCHLAGER#1057 - SCIOTO | XA/2025 | |
| 500 HARDIN COUNTY LANDFILL | XA/2025 | |

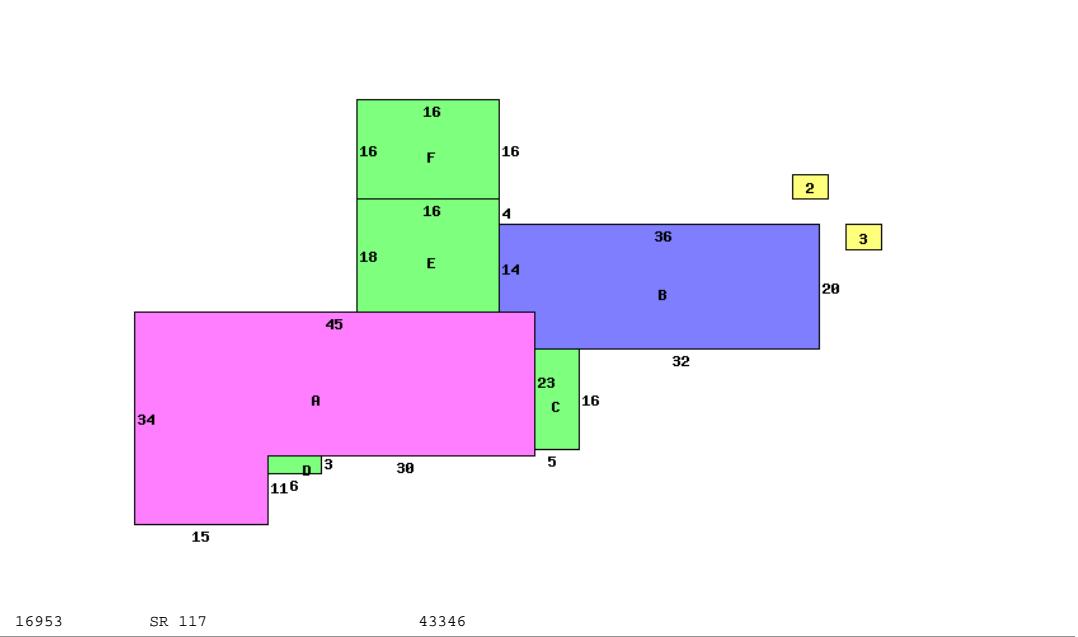

16953 SR 117 43346

| | |
|---------------------------|------------------------|
| Occupancy 1 Single Family | *DWELLING COMPUTATIONS |
| Story Height 1 | Sq-Ft Value |
| Floor Level | 1200 111640 |
| Main | FRAME |
| Basement | 1200 22360 |
| Subtotal | 134000 |
| Shingle | Roof GABLE |
| B 1 2 U A | |
| Plaster/Drywall | X |
| Unfinished Wall | X |
| Floor/Hardwood | X |
| Floor/Carpet | X |
| Number of Rooms | 5 |
| Bedrooms | 3 |
| Fireplace | 1 |
| Openings | 1 |
| Stacks | 1 |
| Central Heat | A |
| FORCED AIR | |
| Plumbing | 1 |
| Standard | |

| | | | | | | | | | | |
|-----------------|----------|-----------|-------|--------|-----------|-----------|---------|-----|-----|-----------------|
| Bldg Type | SHB+Cons | DixHt | Area | Unit | Grade | Blt/Renov | Replace | Phy | Fnc | True |
| 1 DWELLING | 1 B F | 1200 | 1200 | | C | 1954VG | 170730 | .28 | | 132760 |
| 2 Quonset | | 32X80 | 2560 | | C | 1973AV | 30720 | .65 | | 10750 |
| 3 Pole Build | | 30X40 | 1200 | | C | 1988GD | 17400 | .60 | | 6960 CONCRET FL |
| homesite | 1.0000 | effective | depth | actual | effective | extended | true | | | |
| small acreage | 4.5000 | frontage | depth | rate | rate | value | value | | | |
| Total Value | | | | 5000 | 3880 | 17460 | 17460 | | | |
| PUB ELECTRIC | | | | | | | | | | |
| PRIV WATER | | | | | | | | | | |
| PRIV SEWER | | | | | | | | | | |
| PUB PAVED ST/RD | | | | | | | | | | |
| Neighborhood: | | | | | | | | | | |
| Code: | | | | | | | | | | 3800 |
| Dwl/Gar/NC% | | | | | | | | | | 1.0800 |