

ROUNDHEAD TWP
UPPER SCIOTO SD

00360

Hardin County, Ohio
Michael T. Bacon, Auditor

37-090005.0000
F54

AGR
2025

sale

Eff Rate:- 45.43 — 41.39 — 40.07 — 40.02 — a/r

| | |
|------------------------------|---------------------------------|
| 2022 HIGH FARMS PROPERTIES | 2014-02-14 |
| 2023 HIGH FARMS PROPERTIES | 2014-02-14 |
| 2024 HIGH FARMS PROPERTIES | 2014-02-14 |
| 2025 HIGH FARMS PROPERTIES L | 2014-02-14 PT SW 1/4 10 146.54A |
| 3065 CR 150 | 4WD |
| BELLE CENTER OH 43310 | \$0 |

| | | | | | |
|------------|----------|----------|----------|----------|----------|
| Tax Year | 2022 | 2023 | 2024 | 2025 | CAMA |
| Prop Cls | 111 | 111 | 111 | 111 | 111 |
| Acres | 146.5400 | 146.5400 | 146.5400 | 146.5400 | |
| Land100% | 774060 | 847140 | 847140 | 847140 | 847130 |
| Bldg100% | 208230 | 286860 | 286860 | 286860 | 286850 |
| Totl100% | 982290t | 1134000t | 1134000t | 1134000t | 1133980t |
| Cauv100% | 176490 | 361370 | 361370 | 361370 | 361360 |
| Tax Value: | | | | | |
| Land 35% | 61770 | 126480 | 126480 | 126480 | 296500 |
| Bldg 35% | 72880 | 100400 | 100400 | 100400 | 100400 |
| Totl 35% | 134650t | 226880t | 226880t | 226880t | 396890t |
| Hmstd35% | | | | | |
| Owner Oc | | | | | |
| Hmstd RB | | | | | |
| Net Tax | 5540.38 | 8583.26 | 8322.80 | 8312.28 | |
| Cauv Sav | 8605.78 | 6432.14 | 6236.96 | 6229.06 | |
| Sp-Asmnt | 72.12 | 72.12 | 279.80 | 279.80 | |

| | | | | | | | |
|------|------|------|------|-------|-------|---|-------|
| SHB+ | CONS | TYPE | FACT | SQ-FT | VALUE | a | *MAIN |
| 2 B | F | M | | 504 | | | |
| 1H | F | A | | 1680 | | | ADDTN |
| Q | F3 | G | | 1408 | 33790 | | GRAGE |
| | OFF | P | | 992 | 29760 | | PORCH |
| | DK | P | | 292 | 4380 | | PORCH |

| | | | | | | | |
|-------|----|------------|---------------------------|---------------|--------|---------|---------|
| Sale# | #p | sale date | To | Type/Invalid? | Sale\$ | co:land | co:bldg |
| 65 | 4 | 2014-02-14 | HIGH FARMS PROPERTIES LLC | 4WD * | 0 | 413430 | 196800 |
| 541 | 1 | 1991-07-11 | | 1UN * | 327979 | 0 | 228830 |
| 264 | 1 | 1989-04-07 | | 1WD | 278500 | 0 | 228830 |

| | | | | |
|------|-------|-------|--------|---------|
| Year | Land | Bldg | Total | Net Tax |
| 2021 | 61770 | 72880 | 134650 | 5849.08 |
| 2020 | 61770 | 72880 | 134650 | 5927.70 |

Project
902 MAIN DISTRICT CONSERVANCY XA/2025
500 HARDIN COUNTY LANDFILL XA/2025

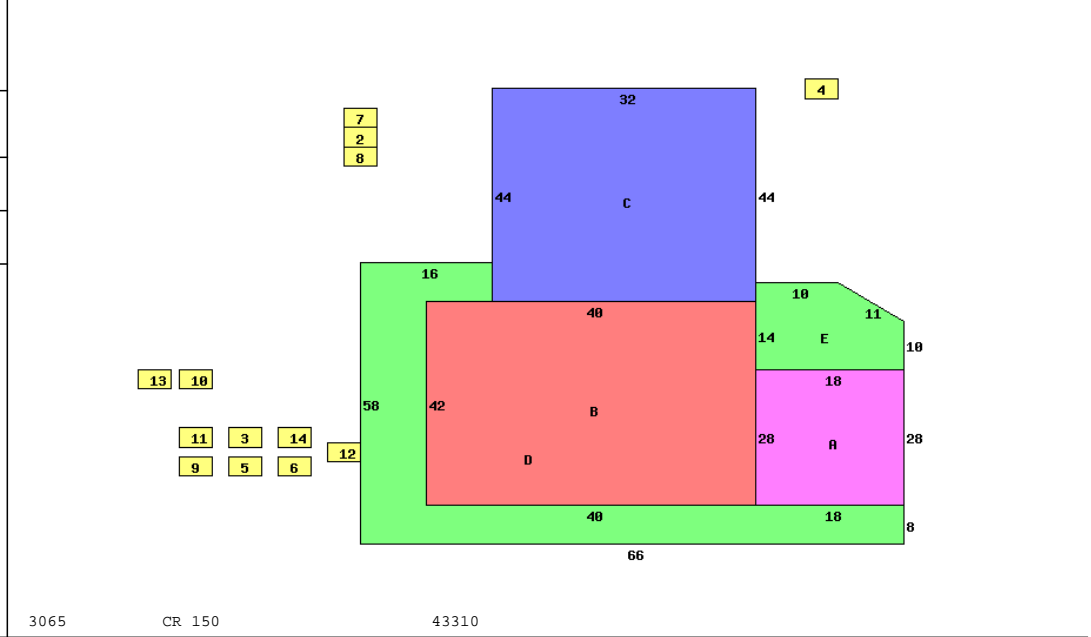

3065 CR 150 43310

| | |
|---------------------------|---------------------------------|
| Occupancy 1 Single Family | *DWELLING COMPUTATIONS |
| Story Height 1H | Sq-Ft Value |
| Floor Level | |
| Main | FRAME 2184 147460 |
| Full Upper | FRAME 504 42780 |
| Part Upper | FRAME 1680 46570 |
| Qtr Story | FRAME 1408 20640 |
| Basement | 126 2780 |
| Subtotal | 260230 |
| Shingle | Roof GABLE |
| Plaster/Drywall | P P Fireplaces 2000 |
| Panelled Wall | X X Air Conditioning 7670 |
| Unfinished Wall | X Plumbing 1400 |
| Floor/Pine | X X Garages and Carpports 33790 |
| Floor/Carpet | X Extra Features 34140 |
| Number of Rooms | 4 2 Total Value 339230 |
| Bedrooms | 1 2 |
| Fireplace | PUB ELECTRIC |
| Openings | 1 PRIV WATER |
| Stacks | 1 PRIV SEWER |
| Central Heat | A GYCED ST/RD |
| FORCED AIR | Neighborhood: |
| Central A/C | A Code: 3800 |
| Plumbing | C Dwl/Gar/NC% 1.0800 |
| Standard | 1 |
| Extra 2 Fixture | 1 |

| | | | | | | | | | |
|---------------|-------------------------|---------------|--------|--------|-----------|---------|--------|-------------|--------|
| Bldg Type | SHB+Cons | DixHt | Unit | Grade | Blt/Renov | Replace | Phy | Fnc | True |
| 1 DWELLING | 2 B F | 4368 | | | C | OLD/GD | .40 | | 219820 |
| 2 Flat Barn | | 60X50 3000 | | | D | OLD/GD | .80 | .50 | 2880 |
| 3 Grain Bin | *PP | 0 30X24 720 | | | C | 1979AV | 0 | | 0 |
| 4 Pole Build | 10 | 100X100.00000 | | | C | 1979AV | 120000 | .65 | 42000 |
| 5 Grain Bin | *PP | 0 40X24 960 | | | C | 1970AV | 0 | | 0 |
| 6 Grain Bin | *PP | 0 40X24 960 | | | C | 1970AV | 0 | | 0 |
| 7 Lean-To | | 40X74 2960 | | | C | 1990AV | 23680 | .65 | 8290 |
| 8 Lean-To | | 3660 | | | C | OLD/GD | 29280 | .60 | 11710 |
| 9 Grain Bin | *PP | 40X36 1440 | | | C | 2005AV | 0 | | 0 |
| 10 Grain Bin | *PP | 46X36 1656 | | | C | 2005AV | 0 | | 0 |
| 11 Grain Bin | *PP | 28X36 1008 | | | C | 2005AV | 0 | | 0 |
| 12 Pole Build | | 16X28 448 | | | C | 1996AV | 5380 | .60 | 2150 |
| 13 Grain Bin | *PP | 46X36 1656 | | | C | 2013AV | 0 | | 0 |
| 14 Grain Bin | *PP | 30X24 720 | | | C | 1979AV | 0 | | 0 |
| Tab # | S O I L | Acres | Mkt/Ac | Market | Au/Ac | Cauv | | | |
| C 1 | BOA BLOUNT SILT LOAM 0- | 18.2639 | 6030 | 110130 | 2660 | 48580 | | | |
| C 2 | BOB BLOUNT SILT LOAM, 2 | 51.3747 | 5770 | 296430 | 2360 | 121240 | | | |
| C 4 | CA CARLISLE MUCK | 24.2320 | 7410 | 179560 | 3140 | 76090 | | | |
| C 14 | GWB GLYNWOOD SILT LOAM | 7.2174 | 5400 | 38970 | 1750 | 12630 | | | |
| C 16 | GYC2 GLYNWOOD CLAY LOAM | 1.5136 | 4750 | 7190 | 1050 | 1590 | | | |
| C 23 | LN LINWOOD MUCK | 3.9016 | 6490 | 25320 | 2740 | 10690 | | | |
| C 39 | PM PEWAMO SILTY CLAY L | 16.3078 | 6490 | 105840 | 3560 | 58060 | | | |
| W 1 | BOA BLOUNT SILT LOAM 0- | 6.4691 | 3610 | 23350 | 770 | 4980 | | | |
| W 2 | BOB BLOUNT SILT LOAM, 2 | 2.9429 | 3130 | 9210 | 470 | 1380 | | | |
| W 4 | CA CARLISLE MUCK | .3353 | 5100 | 1710 | 1250 | 420 | | | |
| W 39 | PM PEWAMO SILTY CLAY L | 6.4097 | 5370 | 34420 | 1670 | 10700 | | | |
| 670 | HSITE HOMESITE | 1.0000 | 15000 | 15000 | 15000 | 15000 | | | |
| 980 | ROAD ROAD | 6.5720 | | | | | | | |
| | | 146.54 | | 847130 | (100%) | 361360 | | CAUV # 3894 | |
| | | | | 296500 | (35%) | 126480 | | | |