

PLEASANT TWP
KENTON CORP

00350

Hardin County, Ohio
Michael T. Bacon, Auditor

36-780019.0000
T77

RES
2025

sale

Eff Rate:- 50.59 — 44.66 — 47.03 — 46.74 — a/r

2022 SHODA JOELLA & JOEL A	2018-09-07
2023 SHODA JOELLA & JOEL A	2018-09-07
2024 SHODA JOELLA & JOEL A	2018-09-07
2025 SHODA JOELLA & JOEL A E	2018-09-07 GREEN MEADOWS S PT 19
107 CLOVER LANE DR	LWD
KENTON OH 43326	\$122,000

Tax Year	2022	2023	2024	2025	2025	CAMA
Prop Cls	510	510	510	510	510	510
Acres						
Land100%	12510	14200	14200	14200	14200	14200
Bldg100%	104030	118860	118860	118860	118860	118860
Totl100%	116540t	133060t	133060t	133060t	133060t	133060t
Cauv100%						
Tax Value:						
Land 35%	4380	4970	4970	4970	4970	4970
Bldg 35%	36410	41600	41600	41600	41600	41600
Totl 35%	40790t	46570t	46570t	46570t	46570t	46570t
Hmstd35%						
Owner Oc				41.06	41.06	
Hmstd RB						
Net Tax	1905.44	1914.78	2025.66	1971.24	1971.24	
Sp-Asmnt	21.00	25.00	21.00	24.00		

SHB+	CONS	TYPE	FACT	SQ-FT	VALUE	a	*MAIN
1 B	F	M		1200			
	F2	G		528	12670	b	GRAGE
1	F/C	A		544		c	ADDIN
	OFF	P		45	1350	d	PORCH

9-07-2018 ETAL IS KATHERINE BAUM

Sale#	#p	sale date	To	Type/Invalid?	Sale\$	co:land	co:bldg
430	1	2018-09-07	SHODA JOELLA & JOEL A ETA	LWD	122000	11910	85230
538	1	2001-10-24	TUTTLE J GREGORY	LWD	65000	9030	53570
919	1	1991-11-12		LUN *	0	0	53030
820	1	1991-10-10		LWD	49500	0	53030

Year	Land	Bldg	Total	Net Tax
2021	4380	36410	40790	1912.38
2020	4380	36410	40790	1661.06

project	ben acres	/ %	factor
131 BLANCHARD RIVER MAINT			XA/2025
500 HARDIN COUNTY LANDFILL			XA/2025
921 BLANCHARD RIVER MAINT			XA/2023
235 KELLOGG #983 - BLANCHARD			XA/2025

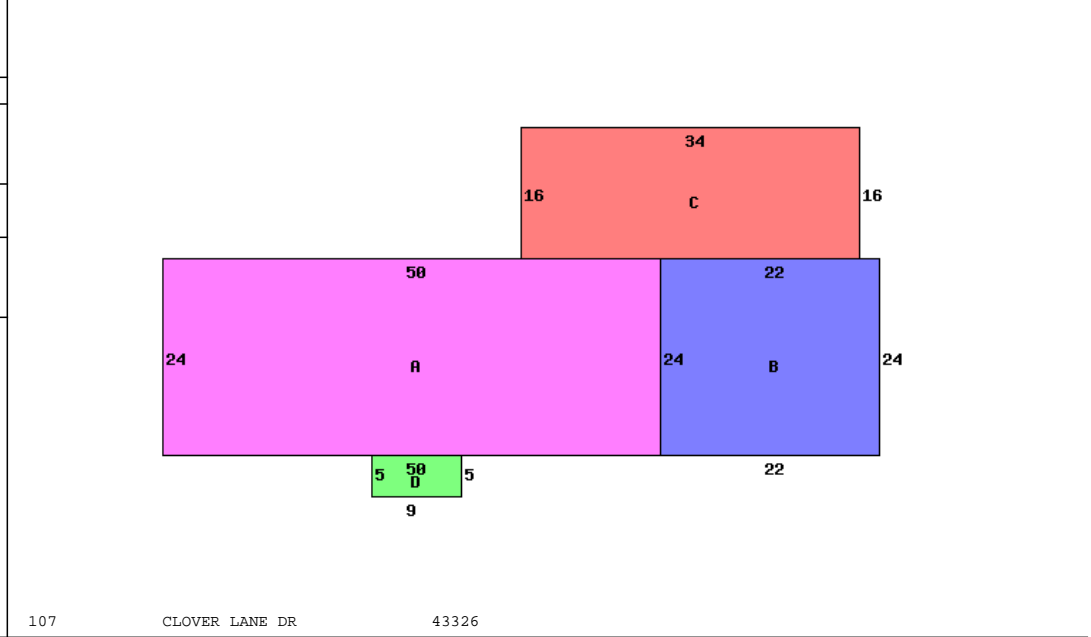

107 CLOVER LANE DR 43326

Occupancy 1 Single Family	*DWELLING COMPUTATIONS
Story Height 1	Sq-Ft Value
Floor Level	Main FRAME 1744 128850
	Basement 1200 22360
	Subtotal 151210
Shingle	Roof GABLE
	B 1 2 U A
Plaster/Drywall	X Air Conditioning 3020
Unfinished Wall	X Plumbing 1400
Floor/Carpet	X Garages and Carports 12670
Number of Rooms	1 5 Extra Features 2600
Bedrooms	3 Total Value 170900
Central Heat	A PUB PAVED ST/RD
Central A/C	A Neighborhood:
Plumbing	Code: 3660
Standard	1 Dwl/Gar/NC% 1.0700
Extra 2 Fixture	1

Bldg Type	SHB+Cons	DixHt	Area	Unit	Grade	Blt/Renov	Replace	Phy Fnc	True
1 DWELLING	1 B F	FtxFt	1744	Rate	C	1971GD	170900	.35	118860
front lot	acres/ frontage	effective frontage	depth	depth factor	actual rate	effective rate	extended value	true value	
	100.0000	100.00	95	79	180	142	14200	14200	