

PLEASANT TWP
KENTON CORP

00350

Hardin County, Ohio
Michael T. Bacon, Auditor

36-780008.0000
T73

RES
2025

sale

Eff Rate:- 50.59 — 44.66 — 47.03 — 46.74 — a/r

2022	KLINGLER MARILYN	2008-05-30	
2023	KLINGLER MARILYN	2008-05-30	
2024	KLINGLER DANIEL L	2023-06-13	
2025	KLINGLER DANIEL L	2023-06-13	GREEN MEADOWS 8
	102 CLOVER LANE DR	1CT	
	KENTON OH 43326	\$0	

Tax Year	2022	2023	2024	2025	
Prop Cls	510	510	510	510	CAMA 510
Acres	17710	20170	20170	20170	20180
Land100%	132310	153740	153740	153740	153730
Bldg100%	150030t	173910t	173910t	173910t	173910t
Totl100%					
Cauv100%					
Tax Value:					
Land 35%	6200	7060	7060	7060	7060
Bldg 35%	46310	53810	53810	53810	53810
Totl 35%	52510t	60870t	60870t	60870t	60870t
Hmstd35%					
Owner Oc	50.94	53.86	53.82	53.66	hmstd 7060 l 53810 b
Hmstd RB	400.22	368.96			
Net Tax	2001.76	2079.94	2593.86	2576.56	
Sp-Asmnt	21.00	25.00	21.00	24.00	

SHB+	CONS	TYPE	FACT	SQ-FT	VALUE	a	ADDTN
1	F/C	A		612		b	*MAIN
1	F	M		1700		c	PORCH
	EFP	P		256	10240	d	PORCH
	OPF	P		42	1260	e	GRAGE
	P2	G		576	13820	f	OTHER
	PAT	X		72			

Sale#	#p	sale date	To	Type/Invalid?	Sale\$	co:land	co:bldg
247	1	2023-06-13	KLINGLER DANIEL L	1CT *	0	17710	132310
203	1	2008-05-30	KLINGLER MARILYN	1CT *	0	14000	122140

Year	Land	Bldg	Total	Net Tax
2021	6200	54060	60260	2365.04
2020	6200	54060	60260	2047.26

p r o j e c t		ben acres	/ %	factor
131	BLANCHARD RIVER MAINT			XA/2025
500	HARDIN COUNTY LANDFILL			XA/2025
921	BLANCHARD RIVER MAINT			XA/2023
235	KELLOGG #983 - BLANCHARD			XA/2025

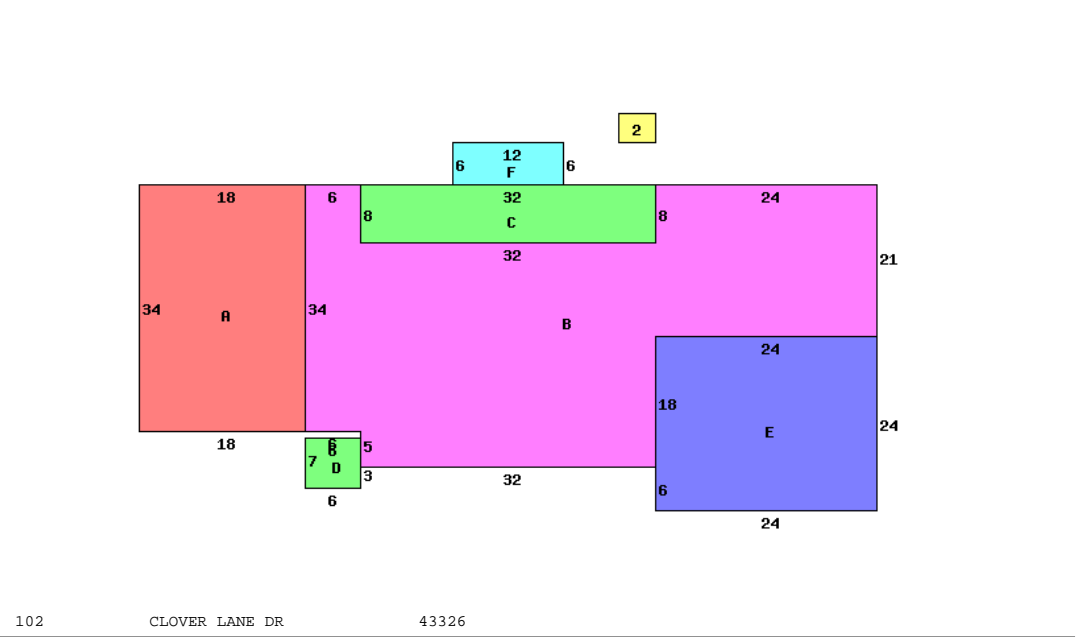

Occupancy	1 Single Family	*DWELLING COMPUTATIONS		
Story Height	1	Sq-Ft Value		
Floor Level	Main	FRAME	2312	153910
	Basement		1700	31450
	Subtotal			185360
Shingle	Roof	HIP		
	B 1 2 U A			
Plaster/Drywall	X	Air Conditioning		3980
Panelled Wall	X	Plumbing		3500
Unfinished Wall	X	Garages and Carports		13820
Floor/Hardwood	X	Extra Features		14380
Floor/Carpet	X X	Total Value		221040
Floor/Concrete	X			
Floor/Tile-Lino	X	PUB PAVED ST/RD		
Number of Rooms	2 7			
Bedrooms	1 3	Neighborhood:		
		Code:		3660
Central Heat	A	Dwl/Gar/NC%		1.0700
ELECTRIC				
Heat Pump	A			
Central A/C	A			
Plumbing				
Standard	1			
Extra 3 Fixture	1			
Extra 2 Fixture	1			

Bldg Type	SHB+Cons	DixHt	Unit	Grade	Blt/Renov	Replace	Phy	Fnc	True
1 DWELLING	1 B F	2312		C	1969GD	221040	.35	Dpr	153730
2 Shed	*PP F 0	8X10	80		1994AV	0			0
front lot	acres/	effective	depth	actual	effective	extended	true		
	frontage	frontage	depth	factor	rate	value	value		
	58.0000	118.00	135	95	180	171	20180		20180

Call Back:	Sign: PSN Date: 2015-02-23	Lister:	36-780008.0000-v082020R
------------	----------------------------	---------	-------------------------