

PLEASANT TWP
KENTON CORP

00350

Hardin County, Ohio
Michael T. Bacon, Auditor

36-730023.0000
RR32

RES
2025

sale

Eff Rate:- 46.74 a/r

2025 CONLEY PAMELA S & ALICI
824 E LICK ST
KENTON OH 43326
2018-08-14 FOREST HTS 23
1WD
\$56,200

Tax Year	2025	CAMA
Prop Cls	510	510
Acres		
Land100%	4910	4900
Bldg100%	47230	47240
Totl100%	52140t	52140t
Cauv100%		
Tax Value:		
Land 35%	1720	1720
Bldg 35%	16530	16530
Totl 35%	18250t	18250t
Hmstd35%		
Owner Oc	16.08	
Hmstd RB		
Net Tax	772.50	
Sp-Asmnt	28.89	

SHB+	CONS	TYPE	FACT	SQ-FT	VALUE	a	*MAIN
1	F/C	M		744			
	RFX	P		40	400	b	PORCH
	STP	P		25	100	c	PORCH
	STP	P		40	160	d	PORCH

Sale#	#p	sale date	To	Type/Invalid?	Sale\$	co:land	co:bldg
396	1	2018-08-14	CONLEY PAMELA S & ALICIA	1WD	56200	4090	30310
340	11	2006-08-15	CWB RENTAL PROPERTIES LL	11 *	0	4260	32260
184	1	2004-04-09	BROOKS WESLEY C & CHRIST	1WD	53500	3860	27540
308	1	2003-06-05	BUXTON DOUGLAS E & KAREN	1WD	25000	3860	27540
278	1	2003-06-05	EQUIFIRST CORPORATION	1QC *	0	3860	27540
582	1	2002-10-21	FANNIE MAE & FEDERAL NAT	1SH	20000	3890	22740
487	1	1997-08-21	REID DAVID A & SUSAN M	1WD	42500	4090	17230
364	1	1995-05-04	WINGFIELD THOMAS A	ETA WD	30000	4110	16510
119	0	1986-02-21		*	21100	0	18110

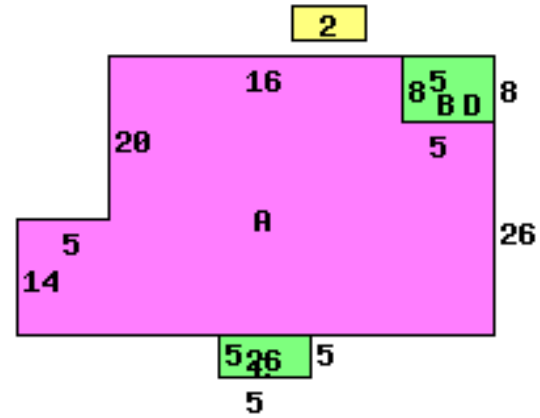

824 E LICK ST 43326

Occupancy 1 Single Family		*DWELLING COMPUTATIONS	
Story Height	1	Sq-Ft	Value
Floor Level	Main	FRAME	744 93520
Shingle	Subtotal	Roof	GABLE 93520
Plaster/Drywall	X	Extra Features	660
Panelled Wall	X	Total Value	94180
Floor/Hardwood	X		
Floor/Carpet	X		
Number of Rooms	5	Neighborhood:	
Bedrooms	2	Code:	3620
Central Heat	A	Dwl/Gar/NC%	1.1200
FORCED AIR			
Plumbing			
Standard	1		

Bldg Type	SHB+Cons	DixHt	Unit	Blt/Renov	Replace	Phy	Fnc	True
1 DWELLING	1 F/C	FtxFt	Area	Grade	Cond	Value	Dpr	Dpr
2 Garage		20X24	480	C	1920AV	84760	.55	42720
				C	OLD/AV	11520	.65	4520

front lot	acres/ frontage	effective frontage	depth	actual depth	effective rate	extended value	true value
	43.0000	43.00	135	95	120	114	4900

Call Back:

Sign: PSN Date: 2014-11-17 Lister:

36-730023.0000-v082020R