

PLEASANT TWP
KENTON CORP

00350

Hardin County, Ohio
Michael T. Bacon, Auditor

36-720021.0000
S49

RES
2025

sale

Eff Rate:- 50.59 — 44.66 — 47.03 — 46.74 — a/r

2022 JONES YOSHIKO & RICHA	2019-12-12
2023 JONES YOSHIKO & RICHA	2019-12-12
2024 JONES YOSHIKO & RICHA	2019-12-12
2025 JONES YOSHIKO & RICHARD	2019-12-12
857 SUMMIT ST	1SD
KENTON OH 43326	SEE 36-720021.0100 FOR REST OF SPECIAL ASSESSMEN
	\$180,000

Tax Year	2022	2023	2024	2025	CAMA
Prop Cls	510	510	510	510	510
Acres					
Land100%	17490	23260	23260	23260	23250
Bldg100%	135540	142770	142770	142770	142770
Totl100%	153030t	166030t	166030t	166030t	166020t
Cauvl00%					
Tax Value:					
Land 35%	6120	8140	8140	8140	8140
Bldg 35%	47440	49970	49970	49970	49970
Totl 35%	53560t	58110t	58110t	58110t	58110t
Hmstd35%					
Owner Oc				51.22	
Hmstd RB					
Net Tax	2501.96	2389.28	2527.64	2459.74	
Sp-Asmnt	44.40	51.40	60.06	63.06	

SHB+	CONS	TYPE	FACT	SQ-FT	VALUE	a	*MAIN
1	F/C	M		1640			ADDN
1	F/C	A		312			PORCH
1	PAT	P		288	860		ADDN
	F	A		380			PORCH
	STP	P		28	110		PORCH
	PAT	P		100	300		PORCH
	OFF	P		80	3000		PORCH

#: 22, L/W
367200220000

Sale#	#p	sale date	To	Type/Invalid?	Sale\$	co:land	co:blgd
555	1	2019-12-12	JONES YOSHIKO & RICHARD W	1SD	180000	16660	80490
10	1	2018-01-08	MOORE SHAWN	1	50000	16660	80490
343	1	2012-08-13	TILLMAN EDWARD JR & KARIN	1QC *	0	22740	77260
277	1	2008-08-05	TILLMAN EDWARD JR	1WD *	0	21060	88430
346	1	1999-06-23	TILLMAN EDWARD E JR	1WD	108100	18630	64770
984	1	1989-11-20		1WD	69900	0	68630
447	1	1989-06-06		1UN *	0	0	68630
446	1	1989-06-06		1UN *	0	0	68630
445	1	1989-06-06		1UN *	0	0	68630
716	0	1985-10-15		1UN *	49000	0	64400

Year	Land	Bldg	Total	Net Tax
2021	6120	47440	53560	2511.08
2020	6120	47440	53560	2181.08

p r o j e c t		ben acres	/ %	factor
902	MAIN DISTRICT CONSERVANCY			XA/2025
131	BLANCHARD RIVER MAINT			XA/2025
500	HARDIN COUNTY LANDFILL			XA/2025
235	KELLOGG #983 - BLANCHARD			XA/2025
921	BLANCHARD RIVER MAINT			XA/2023
306	BLOOM #1043 - BLANCHARD			XA/2025
349	OSBORN-BLANCHARD RIVER			XA/2025

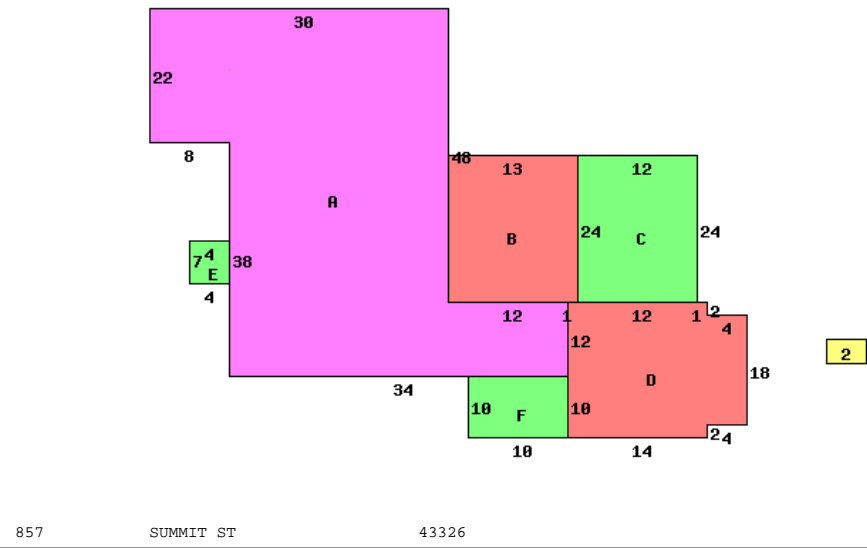

857 SUMMIT ST 43326

Occupancy 1 Single Family		*DWELLING COMPUTATIONS	
Story Height	1	Sq-Ft	Value
Floor Level	Main	FRAME	2332 155240
	Subtotal		155240
Shingle	Roof	GABLE	
Plaster/Drywall	X	Air Conditioning	4010
Floor/Carpet	X	Plumbing	3500
Floor/Tile-Lino	X	Extra Features	4270
Number of Rooms	7	Total Value	167020
Bedrooms	4		
Central Heat	A	PUB PAVED ST/RD	
FORCED AIR		PUB SIDEWALK	
Central A/C	A	Neighborhood:	
Plumbing		Code:	3630
Standard	1	Dwl/Gar/NC%	1.0500
Extra 3 Fixture	1		
Extra 2 Fixture	1		

Bldg Type	SHB+Cons	DixHt	Unit	Blt/Renov	Replace	Phy	Fnc	True
1 DWELLING	1 F	24X32	2332	C+	1952VG	.30		135030
2 Garage		768		C	1986GD	.60		7740
front lot	200.0000	200.00	188	111	140	155	31000	23250 Excess Fro