

PLEASANT TWP
KENTON CORP

00350

Hardin County, Ohio
Michael T. Bacon, Auditor

36-710005.0000
F125

RES
2025

sale

Eff Rate:- 50.59 — 44.66 — 47.03 — 46.74 — a/r

2022 LAMB NORA B & HICKS O	1992-09-16
2023 LAMB NORA B & HICKS O	1992-09-16
2024 LAMB NORA B & HICKS O	1992-09-16
2025 HICKS NORA	2024-03-27 SHANAFELTS 4TH 71
421 N OAK	8CT
KENTON OH 43326	\$0

Tax Year	2022	2023	2024	2025	CAMA
Prop Cls	510	510	510	510	510
Acres	3710	5310	5310	5310	5310
Land100%	96540	121770	121770	121770	121770
Bldg100%	100260t	127090t	127090t	127090t	127080t
Totl100%					
Cauv100%					
Tax Value:					
Land 35%	1300	1860	1860	1860	1860
Bldg 35%	33790	42620	42620	42620	42620
Totl 35%	35090t	44480t	44480t	44480t	44480t
Hmstd35%					43390
Owner Oc	34.04	39.36	39.32	38.26	hmstd 1860 l 41530 b
Hmstd RB	400.22	368.96	417.58	429.66	
Net Tax	1204.92	1420.54	1477.86	1454.10	
Sp-Asmnt	21.91	21.91	35.48	35.48	

SHB+	CONS	TYPE	FACT	SQ-FT	VALUE	a	*MAIN
1	F/C	M		2200		b	GRAGE
	F	G		720	17280	c	PORCH
	OFF	P		20	600	d	PORCH
	DK	P		672	10080		

Sale#	#p	sale date	To	Type/Invalid?	Sale\$	co:land	co:bldg
157	8	2024-03-27	HICKS NORA	8CT *	0	5310	121770
876	9	1992-09-16		9WD *	0	0	3630

Year	Land	Bldg	Total	Net Tax
2021	1300	33790	35090	1209.38
2020	1300	33790	35090	1046.88

p r o j e c t		ben acres	/ %	factor
902 MAIN DISTRICT CONSERVANCY	XA/2025			
500 HARDIN COUNTY LANDFILL	XA/2025			

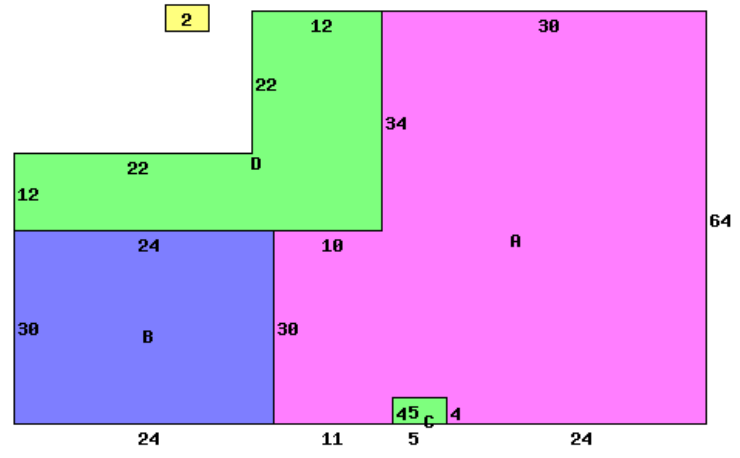

421 N OAK 43326

Occupancy 1 Single Family	*DWELLING COMPUTATIONS	
Story Height 1	Sq-Ft	Value
Floor Level	2200	148540
Metal	148540	
Plaster/Drywall	D	Air Conditioning 3830
Floor/Carpet	X	Plumbing 2100
Number of Rooms	4	Garages and Carpports 17280
Bedrooms	3	Extra Features 10680
Central Heat	A	Total Value 182430
FORCED AIR		PUB PAVED ST/RD
Central A/C	A	
Plumbing		Neighborhood:
Standard	1	Code: 3670
Extra 3 Fixture	1	Dwl/Gar/NC% 1.0900

Bldg Type	SHB+Cons	DixHt	Unit	Blt/Renov	Replace	Phy	Fnc	True
1 DWELLING	1 F	FtxFt	Area	Grade	Cond	Value	Dpr	Dpr
2 Shed			2200	C-	1999AV	164190	.22	.15
			720	D	1999AV	6910	.55	
front lot	47.0000	47.00	134	94	120	113	5310	5310