

PLEASANT TWP  
KENTON CORP

00350

Hardin County, Ohio  
Michael T. Bacon, Auditor

36-650067.0000  
W125

RES  
2025

sale

Eff Rate:- 50.59 — 44.66 — 47.03 — 46.74 — a/r

2022 WILSON KENNETH E & MI	2021-10-04
2023 WILSON KENNETH E & MI	2021-10-04
2024 WILSON KENNETH E & MI	2021-10-04
2025 WILSON KENNETH E & MIST	2021-10-04 WAYNE HTS 44-45
625 N HIGH ST	1SD
KENTON OH 43326	\$80,000

Tax Year	2022	2023	2024	2025	CAMA
Prop Cls	510	510	510	510	510
Acres	6940	7940	7940	7940	7940
Land100%	98430	83400	83400	83400	83410
Bldg100%	105370t	91340t	91340t	91340t	91350t
Totl100%					
Cauvl00%					

2026 WILSON KENNETH E	2025-10-10
625 N HIGH ST	1QC
KENTON OH 43326	

Tax Value:					
Land 35%	2430	2780	2780	2780	2780
Bldg 35%	34450	29190	29190	29190	29190
Totl 35%	36880t	31970t	31970t	31970t	31970t
Hmstd35%					
Owner Oc	35.78	28.30	28.26	28.18	
Hmstd RB					
Net Tax	1687.00	1286.20	1362.34	1353.24	
Sp-Asmnt	24.00	32.00	24.00	27.00	

SHB+	CONS	TYPE	FACT	SQ-FT	VALUE		
1	F/C	M		1390		a	*MAIN
1	F/C	A		221		b	ADDTN
1	F/C	A		320		c	ADDTN
	F2	G		560	13440	d	GRAGE
	DK	P		40	600	e	PORCH
	PAT	P		432	1300	f	PORCH
1	B/C	A		24		g	ADDTN
	EFP	P		36	1440	h	PORCH
1	B/C	A		24		i	ADDTN
	OFF	P		90	2700	j	PORCH

#: 107, L/W  
366501070000

Sale#	#p	sale date	To	Type/Invalid?	Sale\$	co:land	co:blgd
446	1	2025-10-10	WILSON KENNETH E	1QC	0	7940	83400
528	1	2021-10-04	WILSON KENNETH E & MISTY	1SD	80000	6940	98430
167	1	2019-05-01	WILSON BLAKE A & LISA A	1SD	90000	6630	80510
504	1	2015-09-30	SEILER EMILY M	1FD	83000	9140	63460
108	1	2004-03-01	MOLK EULAH M	1WD	112500	9460	73910

Year	Land	Bldg	Total	Net Tax
2021	2430	34450	36880	1729.06
2020	2430	34450	36880	1501.84

project	ben acres	%	factor
131 BLANCHARD RIVER MAINT			XA/2025
500 HARDIN COUNTY LANDFILL			XA/2025
921 BLANCHARD RIVER MAINT			XA/2023
235 KELLOGG #983 - BLANCHARD			XA/2025

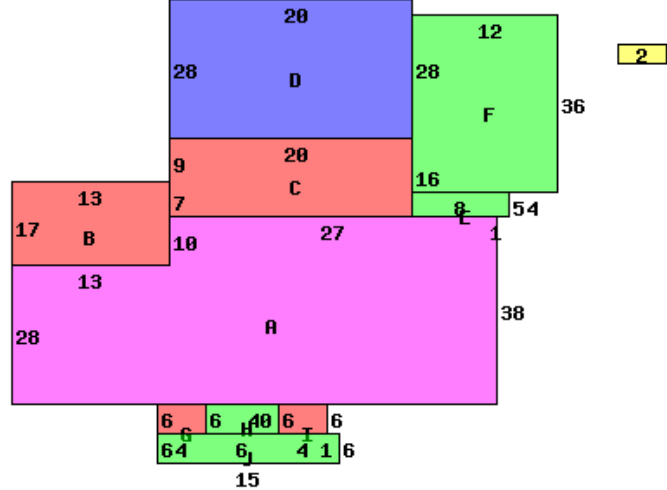

625 N HIGH ST 43326

Occupancy 1 Single Family	*DWELLING COMPUTATIONS	
Story Height 1	Sq-Ft	Value
Floor Level	1979	136410
Metal	Subtotal	136410
	B 1 2 U A	FRAME
		GABLE
Plaster/Drywall	X	Fireplaces 4000
Floor/Hardwood	X	Air Conditioning 3500
Number of Rooms	6	Plumbing 2100
Bedrooms	2	Garages and Carports 13440
Fireplace		Extra Features 6040
Openings	2	Total Value 165490
Stacks	2	
Central Heat	A	PUB PAVED ST/RD
HOT WATER		
Central A/C	A	Neighborhood:
Plumbing		Code: 3620
Standard	1	Dwl/Gar/NC% 1.1200
Extra 3 Fixture	1	

Bldg Type	SHB+Cons	DixHt	Unit	Blt/Renov	Replace	Phy	Fnc	True
1 DWELLING	1 F/C	FtxFt	Area	Grade	Cond	Dpr	Dpr	Value
2 Pool	*PP	1979	0	C	1950AV	.55		83410
					2021AV	0		0
front lot	acres/	effective	depth	actual	effective	extended	true	
	frontage	frontage	depth	factor	rate	value	value	
		69.00	140	96	120	115	7940	7940