

PLEASANT TWP
KENTON CORP

00350

Hardin County, Ohio
Michael T. Bacon, Auditor

36-630087.0000
T135

RES
2025

sale

Eff Rate:- 50.59 — 44.66 — 47.03 — 46.74 — a/r

2022	TROMBLEY ELIZABETH J	2021-07-22	
2023	TROMBLEY ELIZABETH J	2021-07-22	
2024	TROMBLEY ELIZABETH J	2021-07-22	
2025	TROMBLEY ELIZABETH J & 606 E PATTERSON AVE	2021-07-22	KENTON LANDS 33 LSD
	KENTON OH 43326	\$169,000	

Tax Year	2022	2023	2024	2025	CAMA
Prop Cls	510	510	510	510	510
Acres					
Land100%	9230	14000	14000	14000	14000
Bldg100%	103170	119370	119370	119370	119370
Totl100%	112400t	133370t	133370t	133370t	133370t
Cauv100%					
Tax Value:					
Land 35%	3230	4900	4900	4900	4900
Bldg 35%	36110	41780	41780	41780	41780
Totl 35%	39340t	46680t	46680t	46680t	46680t
Hmstd35%					
Owner Oc	38.16	41.30	41.26	41.16	
Hmstd RB					
Net Tax	1799.54	1878.02	1989.20	1975.92	
Sp-Asmnt	24.00	28.00	24.00	27.00	

SHB+	CONS	TYPE	FACT	SQ-FT	VALUE		
1	F/C	M		1364		a	*MAIN
	STP	P		24	100	b	PORCH
	F2	G		484	11620	c	GRAGE
	RFX	P		132	1320	d	PORCH
	DK	P		384	5760	e	PORCH
	RFX	P		24	240	f	PORCH
1	F	A		320		g	ADDTN

1	WOOD BURNER	Sale#	date	To	Type/Invalid?	Sale\$	co:land	co:blgd
355	1	2021-07-22	TROMBLEY ELIZABETH J & LO	LSD	169000	9230	103170	
615	1	2015-11-25	LOHRBER PAUL A & SUSAN E	LSD	116600	9370	74570	
451	1	2013-09-17	HARRIS JERROD	1AF	81000	9370	74570	
429	1	2013-09-17	PHILLIPS RONALD A ETAL	1AF *	0	9370	74570	
407	1	1992-05-07		LUN *	0	0	61110	

Year	Land	Bldg	Total	Net Tax
2021	3230	36110	39340	1806.22
2020	3230	36110	39340	1563.58

Project	ben acres	%	factor
131 BLANCHARD RIVER MAINT			XA/2025
235 KELLOGG #983 - BLANCHARD			XA/2025
500 HARDIN COUNTY LANDFILL			XA/2025
921 BLANCHARD RIVER MAINT			XA/2023
306 BLOOM #1043 - BLANCHARD			XA/2025

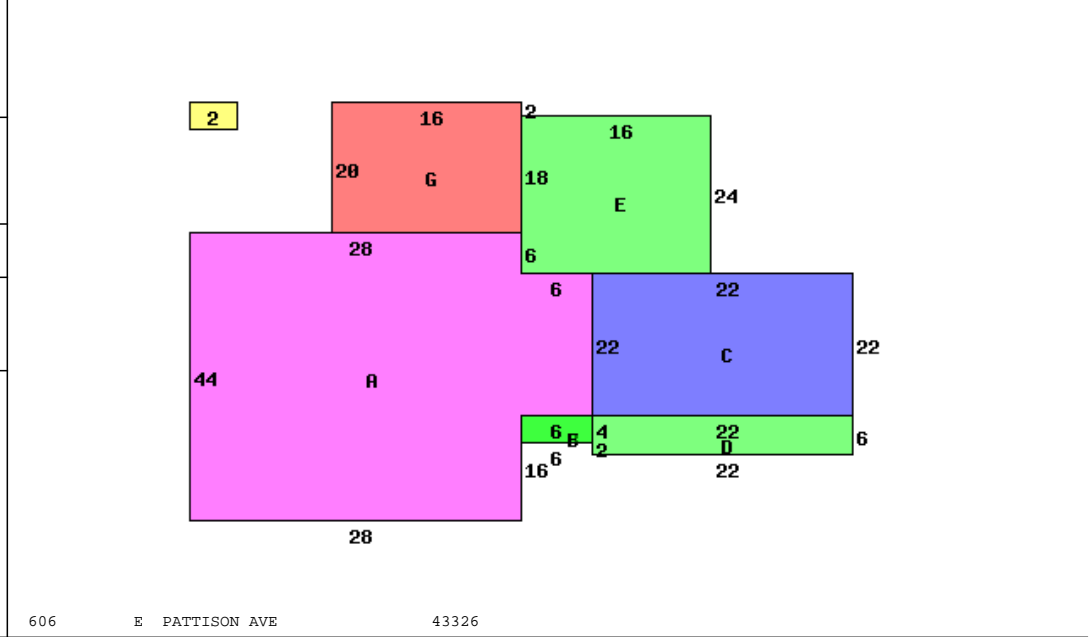

Occupancy 1 Single Family	*DWELLING COMPUTATIONS	
	Sq-Ft	Value
Story Height 1		
Floor Level	Main	FRAME
	Subtotal	1684 126150
	Roof	126150
Metal	B 1 2 U A	GABLE
Plaster/Drywall	P	Fireplaces 2000
Panelled Wall	X	Plumbing 1400
Floor/Pine	X	Garages and Carports 11620
Floor/Carpet	X	Extra Features 8980
Floor/Tile-Lino	L	Total Value 150150
Number of Rooms	6	
Bedrooms	3	
Fireplace		Neighborhood:
Openings	1	Code: 3690
Stacks	1	Dwl/Gar/NC% 1.0600
Central Heat	A	
ELECTRIC		
Plumbing		
Standard	1	
Extra 2 Fixture	1	

Bldg Type	SHB+Cons	DixHt	Unit	Blt/Renov	Replace	Phy Fnc	True
1 DWELLING	1 F/C	1684		Grade	Cond Value	Dpr Dpr	Value
2 Shed	*PP	10X14	0	C	1964VG 150150	.25	119370
					2016AV	0	0
front lot	acres/ frontage	effective frontage	depth	actual factor	effective rate	extended value	true value
	80.00	80	73	240	175	14000	14000

Call Back:

Sign: PSN Date: 2017-05-22 Lister:

36-630087.0000-v082020R