

PLEASANT TWP
KENTON CORP

00350

Hardin County, Ohio
Michael T. Bacon, Auditor

36-630073.0000
R39

RES
2025

sale

Eff Rate:- 50.59 — 44.66 — 47.03 — 46.74 — a/r

2022 RUDASILL CHAD I & NIK	2021-03-29	
2023 RUDASILL CHAD I & NIK	2021-03-29	
2024 RUDASILL CHAD I & NIK	2021-03-29	
2025 RUDASILL CHAD I & NIKIA	2021-03-29	PT W 1/2 NE 1/4 VAC LOTS
648 N GILMORE ST	ISD	33
KENTON OH 43326	\$168,200	

Tax Year	2022	2023	2024	2025	2025	CAMA
Prop Cls	510	510	510	510	510	510
Acres						
Land100%	8970	20510	20510	20510	20510	20520
Bldg100%	77740	79400	79400	79400	79400	79390
Totl100%	86710t	99910t	99910t	99910t	99910t	99910t
Cauv100%						

2026 WIRBEL ETHAN G &	2025-12-23	
648 N GILMORE ST	ISD	
KENTON OH 43326		

Tax Value:						
Land 35%	3140	7180	7180	7180	7180	7180
Bldg 35%	27210	27790	27790	27790	27790	27790
Totl 35%	30350t	34970t	34970t	34970t	34970t	34970t
Hmstd35%						
Owner Oc	29.44	30.94	30.92	30.82	30.82	
Hmstd RB						
Net Tax	1388.30	1406.92	1490.18	1480.24	1480.24	
Sp-Asmnt	27.00	32.50	28.50	31.50		

SHB+	CON	TYPE	FACT	SQ-FT	VALUE	
1	F/C	M		1227		a *MAIN
	OFF	P		36	1080	b PORCH
	RFX	P		132	1320	c PORCH
	F2	G		528	12670	d GRAGE
	PAT	P		112	340	e PORCH
	STP	P		16	60	f PORCH

Sale#	#p	sale date	To	Type/Invalid?	Sale\$	co:land	co:bldg
593	1	2025-12-23	WIRBEL ETHAN G &	ISD	170000	20510	79400
103	1	2021-03-29	RUDASILL CHAD I & NIKIA J	ISD	168200	8970	77740
332	1	2003-07-16	CLAWSON BRIAN J & LOUCRE	ISD *	0	12600	67060
740	1	2000-12-26	CLAWSON BRIAN J	LWD	87000	12570	58660
931	1	1989-11-01		LWD	67900	0	50600
854	1	1989-10-05		LWD	75000	0	50600

Year	Land	Bldg	Total	Net Tax
2021	3140	27210	30350	1393.48
2020	3140	27210	30350	1206.26

project	ben acres	/ %	factor
131 BLANCHARD RIVER MAINT			XA/2025
500 HARDIN COUNTY LANDFILL			XA/2025
921 BLANCHARD RIVER MAINT			XA/2023
235 KELLOGG #983 - BLANCHARD			XA/2025
349 OSBORN-BLANCHARD RIVER			XA/2025

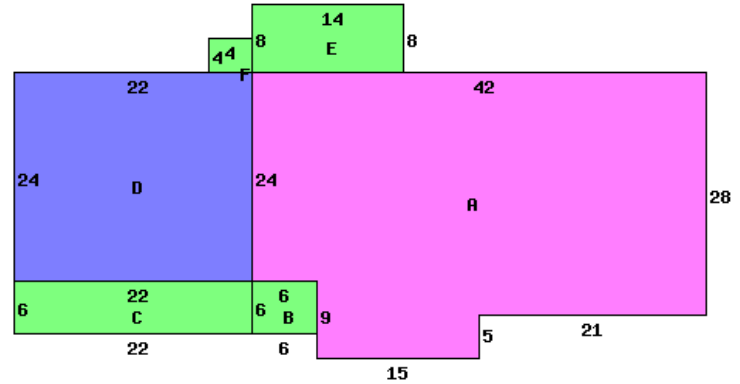

648 N GILMORE ST 43326

Occupancy 1 Single Family	*DWELLING COMPUTATIONS	Sq-Ft	Value
Story Height 1		1227	105060
Floor Level	Main	FRAME	105060
Shingle	Subtotal		
	Roof	GABLE	
Plaster/Drywall	P		Air Conditioning 2200
Panelled Wall	X		Plumbing 2100
Floor/Hardwood	X		Garages and Carports 12670
Floor/Carpet	X		Extra Features 2800
Number of Rooms	5		Total Value 124830
Bedrooms	3		
Central Heat	A		PUB PAVED ST/RD
FORCED AIR			Neighborhood:
Central A/C	A		Code: 3690
Plumbing			Dwl/Gar/NC% 1.0600
Standard	1		
Extra 3 Fixture	1		

Bldg Type	SHB+Cons	DixHt	Unit	Blt/Renov	Replace	Phy Fnc	True
1 DWELLING	1 F/C			C	1967AV	.40	79390
	acres/	effective	depth	actual	effective	extended	true
front lot	frontage	frontage	factor	rate	rate	value	value
	90.0000	90.00	136	95	240	228	20520

Call Back:	Sign: PSN Date: 2015-01-12	Lister:	36-630073.0000-v082020R
------------	----------------------------	---------	-------------------------