

PLEASANT TWP
KENTON CORP

00350

Hardin County, Ohio
Michael T. Bacon, Auditor

36-610099.0000
W116

RES
2025

sale

Eff Rate:- 50.59 — 44.66 — 47.03 — 46.74 — a/r

2022 REFFNER KIM A & KATHY	2013-05-23
2023 REFFNER KIM A & KATHY	2013-05-23
2024 REFFNER KIM A & KATHY	2013-05-23
2025 REFFNER KIM A & KATHY E	2013-05-23 E JENNINGS E PT PT 81-82
511 N HIGH ST	1SD
KENTON OH 43326	\$86,000

Tax Year	2022	2023	2024	2025	2025	CAMA
Prop Cls	510	510	510	510	510	510
Acres						
Land100%	5260	7030	7030	7030	7030	7020
Bldg100%	91940	103600	103600	103600	103600	103590
Totl100%	97200t	110630t	110630t	110630t	110630t	110610t
Cauv100%						

2027 REFFNER JOSHUA A	2026-05-07
511 N HIGH ST	1WD
KENTON OH 43326	

Tax Value:						
Land 35%	1840	2460	2460	2460	2460	2460
Bldg 35%	32180	36260	36260	36260	36260	36260
Totl 35%	34020t	38720t	38720t	38720t	38720t	38710t
Hmstd35%						
Owner Oc	33.00	34.26	34.24	34.14	34.14	
Hmstd RB		368.96	417.58	429.66	859.34	
Net Tax	1556.18	1188.80	1232.40	1209.30	779.62	
Sp-Asmnt	21.00	25.00	21.00	24.00		

SHB+	CONS	TYPE	FACT	SQ-FT	VALUE	a	*MAIN
1	F/C	M		1120			
	OFF	P		60	1800	b	PORCH
	F	G		528	12670	c	GRAGE
	EFF	P		216	8640	d	PORCH

Sale#	#p	sale date	To	Type/Invalid?	Sale\$	co:land	co:blgd
210	1	2026-05-07	REFFNER JOSHUA A	1WD *	0	7030	103600
254	1	2013-05-23	REFFNER KIM A & KATHY E	1SD	86000	7090	73140
445	1	2012-09-28	RICHARDSON SHAUN A & JESS	1WD	38500	7090	73140
385	1	2012-09-13	JOSEPH BESSIE E	1CT *	0	7090	73140
464	1	2006-07-24	JOSEPH GAIL B & BESSIE E	1WD	95000	7290	87510
242	2	1997-06-17	SCHLINGLOF DORIS C	2CT *	0	7030	47510

Year	Land	Bldg	Total	Net Tax
2021	1840	32180	34020	1561.96
2020	1840	32180	34020	1352.12

project	ben acres	%	factor
131 BLANCHARD RIVER MAINT			XA/2025
500 HARDIN COUNTY LANDFILL			XA/2025
921 BLANCHARD RIVER MAINT			XA/2023
235 KELLOGG #983 - BLANCHARD			XA/2025

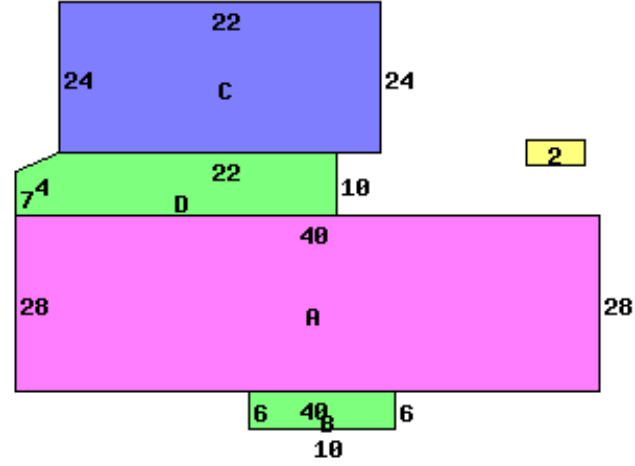

511 N HIGH ST 43326

Occupancy 1 Single Family	*DWELLING COMPUTATIONS	
Story Height 1	Sq-Ft	Value
Floor Level	1120	103370
Shingle	Main Subtotal	103370
	Roof	
Plaster/Drywall	D	Garages and Carports 12670
Floor/Carpet	X	Extra Features 10440
Number of Rooms	5	Total Value 126480
Bedrooms	3	
Central Heat	A	PUB SIDEWALK
ELECTRIC		Neighborhood:
Plumbing		Code: 3630
Standard	1	Dwl/Gar/NC% 1.0500

Bldg Type	SHB+Cons	DixHt	Unit	Blt/Renov	Replace	Phy	Fnc	True
1 DWELLING	1 F/C	1120		Grade	Value	Dpr	Dpr	Value
2 Shed	*PP	8X12	96	COND	126480	.22		103590
				OLD/	0			0
front lot	acres/	effective	depth	actual	effective	extended	true	
	frontage	frontage	depth	rate	rate	value	value	
	65.0000	65.00	90	77	140	108	7020	7020