

PLEASANT TWP
KENTON CORP

00350

Hardin County, Ohio
Michael T. Bacon, Auditor

36-610084.0000
W92

RES
2025

sale

Eff Rate:- 50.59 — 44.66 — 47.03 — 46.74 — a/r

| | |
|----------------------|-------------------------------------|
| 2022 MCCLISH GEORGIE | 2017-07-27 |
| 2023 MCCLISH GEORGIE | 2017-07-27 |
| 2024 MCCLISH GEORGIE | 2017-07-27 |
| 2025 MCCLISH GEORGIE | 2017-07-27 E JENNINGS S PT69 PT VAC |
| 602 N CHERRY ST | LAF SEE PCL 36-610084.01 FOR |
| KENTON OH 43326 | \$0 REST OF SPECIAL ASSESSMEN |

| | | | | | | |
|------------|--------|--------|--------|--------|--------|----------------------|
| Tax Year | 2022 | 2023 | 2024 | 2025 | 2025 | CAMA |
| Prop Cls | 510 | 510 | 510 | 510 | 510 | 510 |
| Acres | 4430 | 5060 | 5060 | 5060 | 5060 | 5060 |
| Land100% | 64570 | 85140 | 85140 | 85140 | 85140 | 85150 |
| Bldg100% | 69000t | 90200t | 90200t | 90200t | 90200t | 90210t |
| Totl100% | | | | | | |
| Cauv100% | | | | | | |
| Tax Value: | | | | | | |
| Land 35% | 1550 | 1770 | 1770 | 1770 | 1770 | 1770 |
| Bldg 35% | 22600 | 29800 | 29800 | 29800 | 29800 | 29800 |
| Totl 35% | 24150t | 31570t | 31570t | 31570t | 31570t | 31570t |
| Hmstd35% | 23820 | 31150 | 31150 | 31150 | 31150 | |
| Owner Oc | 23.10 | 27.56 | 27.54 | 27.46 | 27.46 | hmstd 1770 l 29380 b |
| Hmstd RB | 400.22 | 368.96 | 417.58 | 429.66 | 429.66 | |
| Net Tax | 704.80 | 901.52 | 928.08 | 907.04 | 907.04 | |
| Sp-Asmnt | 21.00 | 25.00 | 21.00 | 24.00 | | |

| | | | | | | | |
|------|------|------|------|-------|-------|---|-------|
| SHB+ | CONS | TYPE | FACT | SQ-FT | VALUE | a | *MAIN |
| 1 | F/C | M | | 360 | | b | ADDN |
| 1T | F | A | | 548 | | c | ADDN |
| 1 | F/C | A | | 44 | | d | PORCH |
| | OFF | P | | 69 | 2070 | e | PORCH |
| | DK | P | | 322 | 4830 | | |

| Sale# | #p | sale date | To | Type/Invalid? | Sale\$ | co:land | co:bldg |
|-------|----|------------|--------------------------|---------------|--------|---------|---------|
| 328 | 1 | 2017-07-27 | MCCLISH GEORGIE | LAF * | 0 | 5830 | 65260 |
| 66 | 1 | 2009-03-03 | MCCLISH GEORGIE & JOHN V | LSL * | 0 | 7030 | 75940 |
| 24 | 1 | 2004-01-22 | CROUCH GEORGIE | LAF * | 0 | 6030 | 62460 |
| 178 | 1 | 1998-04-13 | CROUCH GEORGIE & RUSSELL | LSL * | 62000 | 6970 | 49860 |
| 779 | 1 | 1990-09-28 | | LUN * | 57500 | 0 | 43510 |
| 880 | 0 | 1986-10-21 | | * | 47490 | 0 | 52710 |

| Year | Land | Bldg | Total | Net Tax |
|------|------|-------|-------|---------|
| 2021 | 1550 | 22600 | 24150 | 707.42 |
| 2020 | 1550 | 22600 | 24150 | 612.40 |

| project | ben acres | % | factor |
|------------------------------|-----------|---|---------|
| 131 BLANCHARD RIVER MAINT | | | XA/2025 |
| 500 HARDIN COUNTY LANDFILL | | | XA/2025 |
| 921 BLANCHARD RIVER MAINT | | | XA/2023 |
| 235 KELLOGG #983 - BLANCHARD | | | XA/2025 |

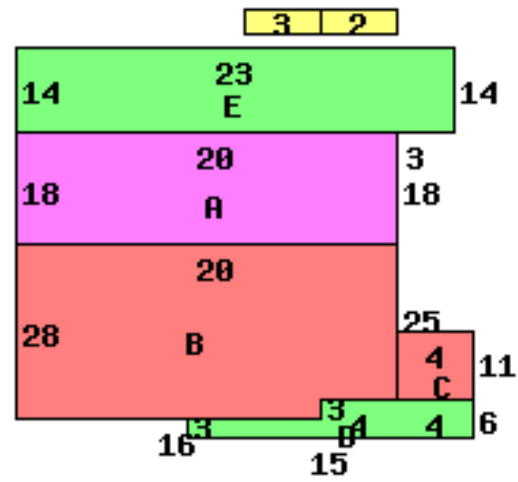

602 N CHERRY ST 43326

| | |
|---------------------------|----------------------------|
| Occupancy 1 Single Family | *DWELLING COMPUTATIONS |
| Story Height 1T | Sq-Ft Value |
| Floor Level | Main FRAME 952 99940 |
| | Part Upper FRAME 548 34350 |
| | Subtotal 134290 |
| Shingle | Roof GABLE |
| Plaster/Drywall | X X Air Conditioning 2600 |
| Unfinished Wall | X Plumbing 2100 |
| Floor/Hardwood | X X Extra Features 6900 |
| Floor/Carpet | X X Total Value 145890 |
| Number of Rooms | 3 3 |
| Bedrooms | 3 PUB ALLEY |
| Central Heat | A Neighborhood: |
| FORCED AIR | Code: 3620 |
| Central A/C | A Dwl/Gar/NC% 1.1200 |
| Plumbing | |
| Standard | 1 |
| Extra 3 Fixture | 1 |

| Bldg Type | SHB+Cons | DixHt | Unit | Blt/Renov | Replace | Phy | Fnc | True |
|------------|----------|------------|------|-----------|---------------|-----|-----|-------|
| 1 DWELLING | 1T F/C | 1500 | Rate | Cond | Value | Dpr | Dpr | Value |
| 2 Garage | | 34X38 1292 | | C | OLD/AV 145890 | .55 | | 73530 |
| 3 Lean-To | | 8X34 272 | | C | OLD/FR 31010 | .70 | | 10420 |
| | | | | C | 2008AV 2180 | .45 | | 1200 |

| front lot | acres/ frontage | effective frontage | depth | depth factor | actual rate | effective rate | extended value | true value |
|-----------|-----------------|--------------------|-------|--------------|-------------|----------------|----------------|------------|
| | 44.0000 | 44.00 | 140 | 96 | 120 | 115 | 5060 | 5060 |

| | | | |
|------------|----------------------------|---------|-------------------------|
| Call Back: | Sign: PSN Date: 2015-04-08 | Lister: | 36-610084.0000-v082020R |
|------------|----------------------------|---------|-------------------------|