

PLEASANT TWP  
KENTON CORP

00350

Hardin County, Ohio  
Michael T. Bacon, Auditor

36-590029.0000  
Z80

RES  
2025

sale

Eff Rate:- 50.59 — 44.66 — 47.03 — 46.74 — a/r

2022	HALSEY DONALD A & BAR	
2023	HALSEY DONALD A & BAR	
2024	HALSEY DONALD A & BAR	
2025	HALSEY DONALD A & BARBA	
	209 N HIGH ST	
	KENTON OH 43326	

BLOOMS N PT 3 & 4

\$0

Tax Year	2022	2023	2024	2025	
Prop Cls	510	510	510	510	CAMA 510
Acres					
Land100%	4940	6600	6600	6600	6600
Bldg100%	87860	106400	106400	106400	106390
Totl100%	92800t	113000t	113000t	113000t	112990t
Cauv100%					
Tax Value:					
Land 35%	1730	2310	2310	2310	2310
Bldg 35%	30750	37240	37240	37240	37240
Totl 35%	32480t	39550t	39550t	39550t	39550t
Hmstd35%					
Owner Oc	31.50	35.00	34.96	34.86	
Hmstd RB	400.22	368.96	417.58	429.66	
Net Tax	1085.52	1222.20	1267.78	1244.46	
Sp-Asmnt	23.05	23.05	33.45	33.45	

SHB+	CONS	TYPE	FACT	SQ-FT	VALUE		
2	F/C	M		646		a	*MAIN
1	F/C	A		140		b	ADDTN
	OFF	P		120	3600	c	PORCH
	DK	P		192	2880	d	PORCH

#: 38 L/W  
365900380000

Year	Land	Bldg	Total	Net Tax
2021	1730	30750	32480	1089.56
2020	1730	30750	32480	943.16

Project	ben acres	/ %	factor
902 MAIN DISTRICT CONSERVANCY			XA/2025
500 HARDIN COUNTY LANDFILL			XA/2025

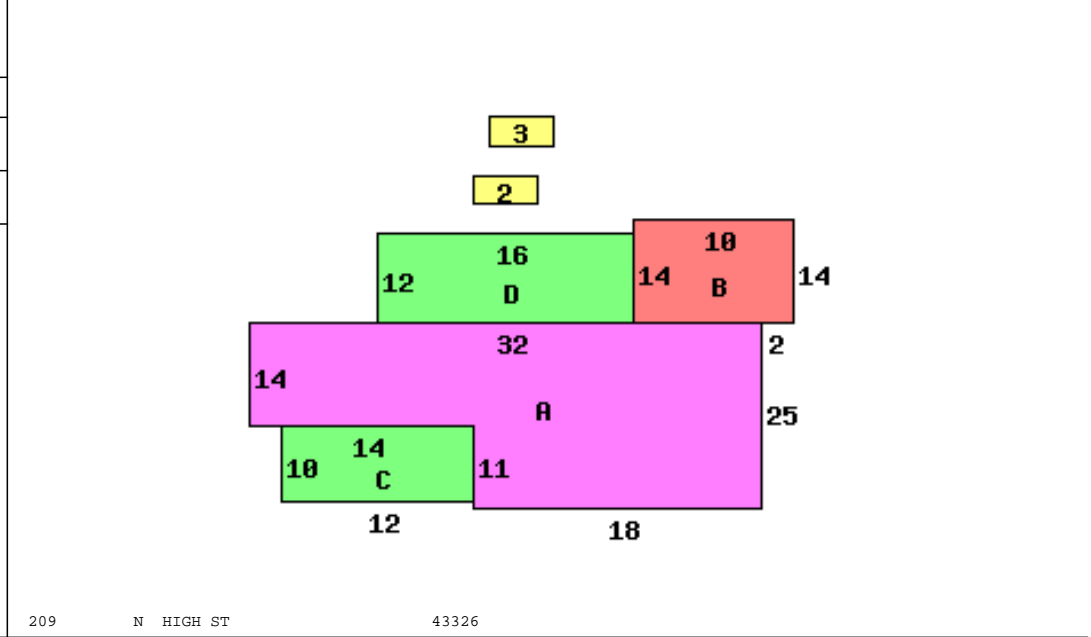

209 N HIGH ST 43326

Occupancy 1 Single Family	*DWELLING COMPUTATIONS	
Story Height 2	Sq-Ft	Value
Floor Level		
	Main	FRAME
	Full Upper	FRAME
	Subtotal	147840
Metal	Roof	HIP
Plaster/Drywall	P P	Air Conditioning
Floor/Hardwood	X	Plumbing
Floor/Pine	X	Extra Features
Floor/Carpet	X	Total Value
Floor/Tile-Lino	L L	
Number of Rooms	4 3	PUB SIDEWALK
Bedrooms	3	
Central Heat	A	Neighborhood:
FORCED AIR		Code:
Central A/C	A	Dwl/Gar/NC%
Plumbing		
Standard	1	
Extra 2 Fixture	1	

Bldg Type	SHB+Cons	DixHt	Unit	Grade	Blt/Renov	Replace	Phy	Fnc	True
1 DWELLING	2 F/C	1432	Rate	C	OLD/GD	158370	Dpr	Dpr	Value
2 Garage		30X25	750	C	1986AV	18000	.65		6620
3 Shed	*PP	8X12	96		2021AV	0			0
front lot	acres/	effective	depth	depth	actual	effective	extended	true	
	frontage	frontage	depth	factor	rate	rate	value	value	
	50.0000	50.00	132	94	140	132	6600	6600	

Call Back:

Sign: PSN Date: 2015-04-29 Lister:

36-590029.0000-v082020R