

PLEASANT TWP
KENTON CORP

00350

Hardin County, Ohio
Michael T. Bacon, Auditor

36-570031.0000
K134

RES
2025

sale

Eff Rate:- 50.59 — 44.66 — 47.03 — 46.74 — a/r

| | |
|----------------------|---------------------|
| 2022 BENSON TREVOR R | 2003-04-24 |
| 2023 BENSON TREVOR R | 2003-04-24 |
| 2024 BENSON TREVOR R | 2003-04-24 |
| 2025 BENSON TREVOR R | 2003-04-24 GARYS 13 |
| 29 GRAPE ST | LWD |
| KENTON OH 43326 | \$51,500 |

| | | | | | | |
|------------|---------|---------|---------|---------|---------|--------|
| Tax Year | 2022 | 2023 | 2024 | 2025 | 2025 | CAMA |
| Prop Cls | 510 | 510 | 510 | 510 | 510 | 510 |
| Acres | | | | | | |
| Land100% | 6310 | 8400 | 8400 | 8400 | 8400 | 8400 |
| Bldg100% | 63110 | 70000 | 70000 | 70000 | 70000 | 69990 |
| Totl100% | 69430t | 78400t | 78400t | 78400t | 78400t | 78390t |
| Cauv100% | | | | | | |
| Tax Value: | | | | | | |
| Land 35% | 2210 | 2940 | 2940 | 2940 | 2940 | 2940 |
| Bldg 35% | 22090 | 24500 | 24500 | 24500 | 24500 | 24500 |
| Totl 35% | 24300t | 27440t | 27440t | 27440t | 27440t | 27440t |
| Hmstd35% | | | | | | |
| Owner Oc | | | | | | |
| Hmstd RB | | | | | | |
| Net Tax | 1135.14 | 1128.24 | 1193.56 | 1185.70 | 1185.70 | |
| Sp-Asmnt | 21.16 | 21.16 | 30.53 | 30.53 | | |

| | | | | | | |
|---------|----------|--------|------|-----------|-------|---------|
| SHB+ 1H | CONS F/C | TYPE M | FACT | SQ-FT 448 | VALUE | a *MAIN |
| 1 BA | F/C | A | | 308 | | b ADDTN |
| 1 | F/C | A | | 184 | | c ADDTN |
| 1 | F/C | A | | 170 | | d ADDTN |
| | DK | P | | 132 | 1980 | e PORCH |
| | OFF | P | | 144 | 4320 | f PORCH |

| | | | | | | | |
|-----------|------|----------------------|--------------------|-------------------|--------------|--------------|---------------|
| Sale# 195 | #p 1 | sale date 2003-04-24 | To BENSON TREVOR R | Type/Invalid? LWD | Sale\$ 51500 | co:land 6310 | co:blgd 52370 |
| 646 | 1 | 1989-08-02 | | LWD | 38000 | 0 | 34800 |

| | | | | |
|------|------|-------|-------|---------|
| Year | Land | Bldg | Total | Net Tax |
| 2021 | 2210 | 22090 | 24300 | 1139.26 |
| 2020 | 2210 | 22090 | 24300 | 989.54 |

Project 902 MAIN DISTRICT CONSERVANCY XA/2025
500 HARDIN COUNTY LANDFILL XA/2025

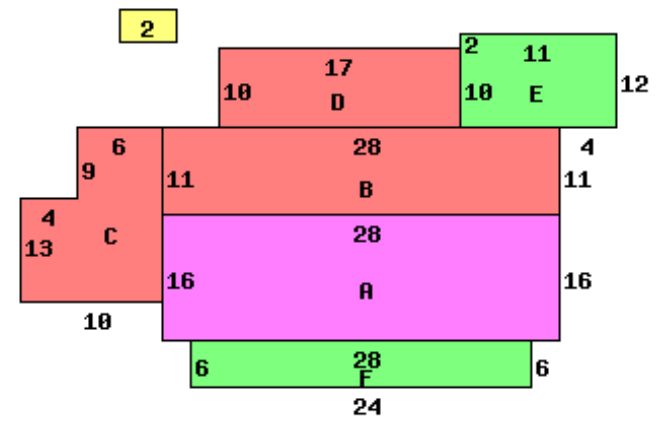

| | |
|---------------------------|-------------------------|
| Occupancy 1 Single Family | *DWELLING COMPUTATIONS |
| Story Height 1T | Sq-Ft Value |
| Floor Level | |
| Main | FRAME 1110 102440 |
| Part Upper | FRAME 448 24730 |
| Qtr Story | FRAME 308 1420 |
| Basement | 154 3240 |
| Subtotal | 131830 |
| Metal | Roof GABLE |
| Plaster/Drywall | X X Extra Features 6300 |
| Panelled Wall | X Total Value 138130 |
| Unfinished Wall | X X |
| Floor/Pine | X PUB PAVED ST/RD |
| Floor/Carpet | X PUB SIDEWALK |
| Floor/Tile-Lino | X |
| Number of Rooms | 1 6 2 1 Neighborhood: |
| Bedrooms | 1 2 Code: 3630 |
| Central Heat | A Dwl/Gar/NC% 1.0500 |
| FORCED AIR | |
| Plumbing | |
| Standard | 1 |

| | | | | | | | |
|------------|----------|------------|-------|-----------|---------------|----------|-------|
| Bldg Type | SHB+Cons | DixHt | Unit | Blt/Renov | Replace | Phy Fnc | True |
| 1 DWELLING | 1H F/C | FtxFt Area | Rate | Grade | Cond Value | Dpr Dpr | Value |
| 2 Garage | | 26X24 624 | | C | OLD/AV 138130 | .55 | 65270 |
| | | | | C | 1979FR 14980 | .70 | 4720 |
| front lot | acres/ | effective | depth | actual | effective | extended | true |
| | frontage | frontage | depth | factor | rate | value | value |
| | 60.0000 | 60.00 | 150 | 100 | 140 | 8400 | 8400 |