

PLEASANT TWP
KENTON CORP

00350

Hardin County, Ohio
Michael T. Bacon, Auditor

36-560050.0000
066

RES
2025

sale

Eff Rate:- 50.59 — 44.66 — 47.03 — 46.74 — a/r

| | | | |
|------|------------------|------------|---------------------|
| 2022 | TENEYCK SHANETTE | 2015-10-08 | |
| 2023 | TENEYCK SHANETTE | 2015-10-08 | |
| 2024 | TENEYCK SHANETTE | 2015-10-08 | |
| 2025 | TENEYCK SHANETTE | 2015-10-08 | HOUSERS E S 70 FT 7 |
| | 131 S CHERRY ST | LWD | |
| | | \$36,500 | |
| | KENTON OH 43326 | | |

| | | | | | |
|------------|---------|---------|---------|---------|--------|
| Tax Year | 2022 | 2023 | 2024 | 2025 | CAMA |
| Prop Cls | 510 | 510 | 510 | 510 | 510 |
| Acres | | | | | |
| Land100% | 5340 | 6090 | 6090 | 6090 | 6080 |
| Bldg100% | 60290 | 71030 | 71030 | 71030 | 71020 |
| Totl100% | 65630t | 77110t | 77110t | 77110t | 77100t |
| Cauvl00% | | | | | |
| Tax Value: | | | | | |
| Land 35% | 1870 | 2130 | 2130 | 2130 | 2130 |
| Bldg 35% | 21100 | 24860 | 24860 | 24860 | 24860 |
| Totl 35% | 22970t | 26990t | 26990t | 26990t | 26990t |
| Hmstd35% | | | | | |
| Owner Oc | 22.28 | 23.88 | 23.86 | 23.80 | |
| Hmstd RB | | | | | |
| Net Tax | 1050.72 | 1085.86 | 1150.14 | 1142.44 | |
| Sp-Asmnt | 21.23 | 21.23 | 31.25 | 31.25 | |

| | | | | | | | |
|------|------|------|------|-------|-------|---|-------|
| SHB+ | CONS | TYPE | FACT | SQ-FT | VALUE | | |
| 2 B | F | M | | 903 | | a | *MAIN |
| | OFF | P | | 108 | 3240 | b | PORCH |
| 1 | F/C | A | | 327 | | c | ADDIN |
| | PAT | P | | 200 | 600 | d | PORCH |

| Sale# | #p | sale date | To | Type/Invalid? | Sale\$ | co:land | co:bldg |
|-------|----|------------|--------------------------|---------------|--------|---------|---------|
| 530 | 1 | 2015-10-08 | TENEYCK SHANETTE | LWD * | 36500 | 7030 | 73830 |
| 170 | 1 | 2015-04-21 | US BANK TRUST NA TRUSTEE | LSH * | 50000 | 7030 | 73830 |
| 130 | 1 | 2008-03-17 | GOOD TIMOTHY | LWD | 92000 | 6370 | 44430 |
| 388 | 1 | 2002-07-31 | MILLER ERIC D & MELODY J | LWD | 5000 | 5770 | 14830 |
| 327 | 1 | 1997-08-19 | KINNEAR DELMORE CHARLES | LQC * | 0 | 6090 | 4230 |
| 309 | 1 | 1991-05-02 | | LUN * | 9000 | 0 | 22510 |

| Year | Land | Bldg | Total | Net Tax |
|------|------|-------|-------|---------|
| 2021 | 1870 | 21100 | 22970 | 1054.62 |
| 2020 | 1870 | 21100 | 22970 | 912.94 |

| project | ben acres | / % | factor |
|-------------------------------|-----------|-----|---------|
| 902 MAIN DISTRICT CONSERVANCY | | | XA/2025 |
| 500 HARDIN COUNTY LANDFILL | | | XA/2025 |

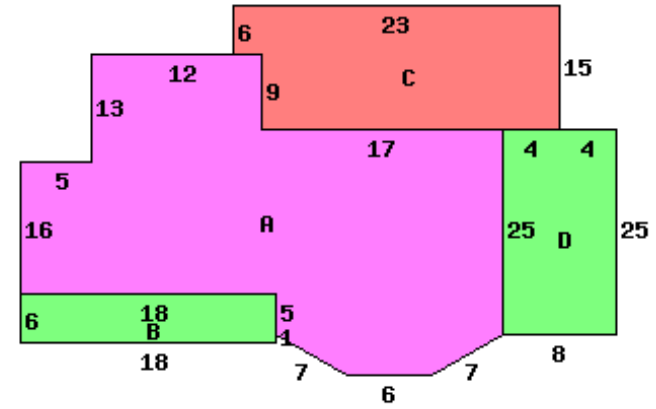

| | | | |
|---------------------------|------------|------------------------|-------------|
| Occupancy 1 Single Family | | *DWELLING COMPUTATIONS | |
| Story Height 2 | | Sq-Ft | Value |
| Floor Level | Main | FRAME | 1230 105310 |
| | Full Upper | FRAME | 903 59360 |
| | Basement | | 352 6800 |
| | Subtotal | | 171470 |
| Shingle | Roof | HIP | |
| | B 1 2 U A | | |
| Plaster/Drywall | X X | Air Conditioning | 3750 |
| Unfinished Wall | X | Plumbing | 2100 |
| Floor/Pine | X X | Extra Features | 3840 |
| Floor/Carpet | X | Total Value | 181160 |
| Floor/Tile-Lino | X | | |
| Number of Rooms | 1 6 4 | PUB SIDEWALK | |
| Bedrooms | 3 | | |
| Central Heat | A | Neighborhood: | |
| FORCED AIR | | Code: | 3620 |
| Central A/C | A | Dwl/Gar/NC% | 1.1200 |
| Plumbing | | | |
| Standard | 1 | | |
| Extra 3 Fixture | 1 | | |

| Bldg Type | SHB+Cons | DixHt | Area | Unit | Grade | Blt/Renov | Replace | Phy | Fnc | True |
|------------|----------|-----------|-----------|-------|--------|-----------|----------|-----|-----|-------|
| 1 DWELLING | 2 B F | FtxFt | 2133 | Rate | C | Cond | Value | Dpr | Dpr | Value |
| | | effective | effective | depth | actual | effective | extended | | | value |
| front lot | 76.0000 | 76.00 | 66 | 67 | 120 | 80 | 6080 | | | 6080 |

Call Back:

Sign: PSN Date: 2014-11-21 Lister:

36-560050.0000-v082020R