

PLEASANT TWP
KENTON CORP

00350

Hardin County, Ohio
Michael T. Bacon, Auditor

36-560027.0000
N76

RES
2025

sale

| | | | | | |
|------|-------------------------|--|--|--|--|
| 2022 | HARDIN COUNTY PUBLISH | | | | |
| 2023 | HARDIN COUNTY PUBLISH | | | | |
| 2024 | HARDIN COUNTY PUBLISH | | | | |
| 2025 | HARDIN COUNTY PUBLISHIN | | | | |
| | 211 E COLUMBUS ST | | | | |
| | KENTON OH 43326 | | | | |

HOUSERS E W 31 FT 21

\$0

| | | | | | |
|------------|---------|--------|--------|--------|--------|
| Eff Rate:- | 50.59 | 44.66 | 47.03 | 46.74 | a/r |
| Tax Year | 2022 | 2023 | 2024 | 2025 | 2025 |
| Prop Cls | 510 | 510 | 510 | 510 | 510 |
| Acres | | | | | |
| Land100% | 3430 | 4570 | 4570 | 4570 | 4570 |
| Bldg100% | 62060 | 42310 | 42310 | 42310 | 42310 |
| Totl100% | 65490t | 46890t | 46890t | 46890t | 46890t |
| Cauv100% | | | | | |
| Tax Value: | | | | | |
| Land 35% | 1200 | 1600 | 1600 | 1600 | 1600 |
| Bldg 35% | 21720 | 14810 | 14810 | 14810 | 14810 |
| Totl 35% | 22920t | 16410t | 16410t | 16410t | 16410t |
| Hmstd35% | | | | | |
| Owner Oc | | | | | |
| Hmstd RB | | | | | |
| Net Tax | 1070.68 | 674.74 | 713.80 | 709.10 | 709.10 |
| Sp-Asmnt | 21.19 | 21.19 | 28.41 | 28.41 | |

| | | | | | | | |
|------|------|------|------|-------|-------|---|-------|
| SHB+ | CONS | TYPE | FACT | SQ-FT | VALUE | | |
| 2 B | F | M | | 574 | | a | *MAIN |
| 1 | F/C | A | | 150 | | b | ADDTN |
| | EFF | P | | 80 | 3200 | c | PORCH |
| | PAT | P | | 138 | 410 | d | PORCH |
| | OFF | P | | 156 | 4680 | e | PORCH |

| | | | | |
|------|------|-------|-------|---------|
| Year | Land | Bldg | Total | Net Tax |
| 2021 | 1200 | 21720 | 22920 | 1074.56 |
| 2020 | 1200 | 21720 | 22920 | 933.34 |

| | | | | |
|-------------------------------|--|-----------|-----|---------|
| Project | | ben acres | / % | factor |
| 902 MAIN DISTRICT CONSERVANCY | | | | XA/2025 |
| 500 HARDIN COUNTY LANDFILL | | | | XA/2025 |

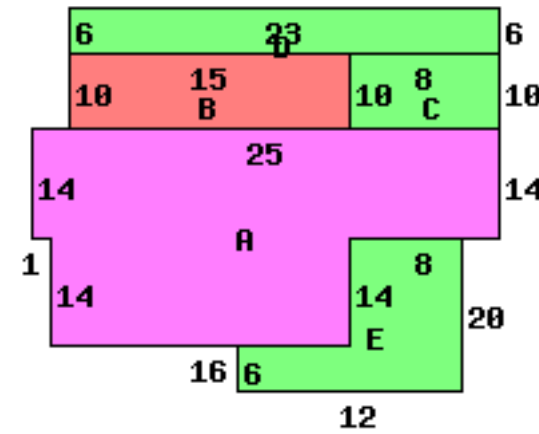

211 E COLUMBUS ST 43326

| | | |
|---------------------------|------------------------|-----------------------|
| Occupancy 1 Single Family | *DWELLING COMPUTATIONS | |
| Story Height 2 | Sq-Ft | Value |
| Floor Level | | |
| Main | FRAME | 724 91010 |
| Full Upper | FRAME | 574 47260 |
| Basement | | 574 10920 |
| Subtotal | | 149190 |
| Metal Roof | GABLE | |
| Plaster/Drywall | X X | Air Conditioning 2290 |
| Unfinished Wall | X | Plumbing 1400 |
| Floor/Pine | X X | Extra Features 8290 |
| Number of Rooms | 1 4 2 | Total Value 161170 |
| Bedrooms | 2 | |
| Central Heat | A | PUB SIDEWALK |
| FORCED AIR | | |
| Central A/C | A | Neighborhood: 3630 |
| Plumbing | | Dwl/Gar/NC% 1.0500 |
| Standard | 1 | |
| Extra 2 Fixture | 1 | |

| | | | | | | | |
|------------|----------|-----------|-------|-----------|-----------|----------|-------|
| Bldg Type | SHB+Cons | DixHt | Unit | Blt/Renov | Replace | Phy Fnc | True |
| 1 DWELLING | 2 B F | FtxFt | Area | Grade | Value | Dpr Dpr | Value |
| | | | 1298 | C | 161170 | .75 | 42310 |
| front lot | acres/ | effective | depth | depth | effective | extended | true |
| | frontage | frontage | depth | factor | rate | value | value |
| | 31.0000 | 31.00 | 165 | 105 | 140 | 147 | 4560 |

Call Back:

Sign: PSN Date: 2014-12-17 Lister:

36-560027.0000-v082020R