

PLEASANT TWP
KENTON CORP

00350

Hardin County, Ohio
Michael T. Bacon, Auditor

36-560017.0000
Z87

RES
2025

sale

Eff Rate:- 50.59 — 44.66 — 47.03 — 46.74 — a/r

| | | |
|------------------|------------|--------------------|
| 2022 JESKI SARAH | 2021-11-12 | |
| 2023 JESKI SARAH | 2021-11-12 | |
| 2024 JESKI SARAH | 2021-11-12 | |
| 2025 JESKI SARAH | 2021-11-12 | HOUSERS E PT OL 10 |
| 301 N HIGH ST | | LWD |
| KENTON OH 43326 | | \$125,000 |

| | | | | | |
|------------|---------|---------|---------|---------|---------|
| Tax Year | 2022 | 2023 | 2024 | 2025 | CAMA |
| Prop Cls | 510 | 510 | 510 | 510 | 510 |
| Acres | 4540 | 6060 | 6060 | 6060 | 6070 |
| Land100% | 67510 | 94710 | 94710 | 94710 | 94710 |
| Bldg100% | 72060t | 100770t | 100770t | 100770t | 100780t |
| Totl100% | | | | | |
| Cauvl00% | | | | | |
| Tax Value: | | | | | |
| Land 35% | 1590 | 2120 | 2120 | 2120 | 2120 |
| Bldg 35% | 23630 | 33150 | 33150 | 33150 | 33150 |
| Totl 35% | 25220t | 35270t | 35270t | 35270t | 35270t |
| Hmstd35% | | | | | |
| Owner Oc | 24.46 | 31.22 | 31.18 | 31.10 | |
| Hmstd RB | | | | | |
| Net Tax | 1153.66 | 1418.96 | 1502.98 | 1492.94 | |
| Sp-Asmnt | 21.19 | 21.19 | 32.42 | 32.42 | |

| | | | | | | | |
|------|------|------|------|-------|-------|---|-------|
| SHB+ | CONS | TYPE | FACT | SQ-FT | VALUE | | |
| 2 B | F | M | | 735 | | a | *MAIN |
| 1 BQ | F | A | | 432 | | b | ADDTN |
| 1 B | F | A | | 108 | | c | ADDTN |
| | FFP | P | | 108 | 4320 | d | PORCH |
| | OP | P | | 134 | 4020 | e | PORCH |

| Sale# | #p | sale date | To | Type/Invalid? | Sale\$ | co:land | co:bldg |
|-------|----|------------|--------------------------|---------------|--------|---------|---------|
| 618 | 1 | 2021-11-12 | JESKI SARAH | LWD | 125000 | 5540 | 67510 |
| 250 | 1 | 2012-06-07 | STRADTMAN CAROLE LYNN | LWD | 17525 | 5830 | 56060 |
| 96 | 1 | 2012-03-16 | WELLS FARGO BANK NA | LSH | 16000 | 5830 | 56060 |
| 989 | 1 | 1994-10-27 | MENARD JEROME R & SHARON | LWD | 48200 | 0 | 29510 |
| 483 | 1 | 1992-05-26 | | LWD | 30000 | 0 | 28430 |
| 343 | 1 | 1992-04-16 | | LQC | 0 | 0 | 28430 |
| 415 | 1 | 1990-05-25 | | LWD | 35000 | 0 | 28430 |
| 949 | 1 | 1988-11-18 | | LWD | 16500 | 0 | 28430 |

| Year | Land | Bldg | Total | Net Tax |
|------|------|-------|-------|---------|
| 2021 | 1550 | 23630 | 25180 | 1180.52 |
| 2020 | 1940 | 23630 | 25570 | 1041.26 |

| Project | ben acres | % | factor |
|-------------------------------|-----------|---|---------|
| 902 MAIN DISTRICT CONSERVANCY | | | XA/2025 |
| 500 HARDIN COUNTY LANDFILL | | | XA/2025 |

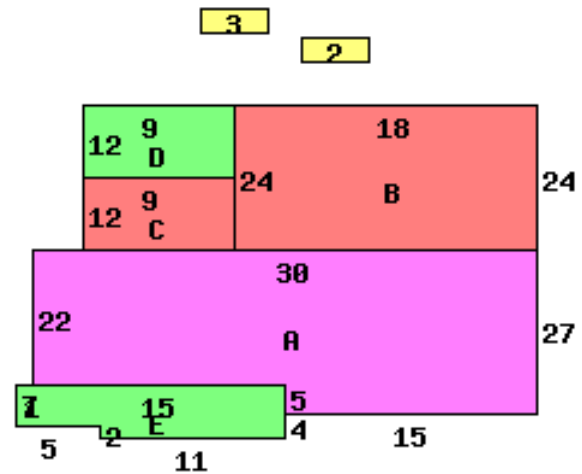

301 N HIGH ST 43326

| | | |
|---------------------------|------------------------|--------------------------|
| Occupancy 1 Single Family | *DWELLING COMPUTATIONS | |
| Story Height 2 | Sq-Ft | Value |
| Floor Level | | |
| Main | FRAME | 1275 105400 |
| Full Upper | FRAME | 735 55490 |
| Qtr Story | FRAME | 432 7610 |
| Basement | | 1275 23600 |
| Subtotal | | 192100 |
| Shingle | Roof GABLE | |
| Plaster/Drywall | X X | Extra Features 8340 |
| Unfinished Wall | X | Total Value 200440 |
| Floor/Hardwood | X X | |
| Floor/Pine | X | PUB SIDEWALK |
| Number of Rooms | 1 5 4 1 | |
| Bedrooms | 4 | Neighborhood: Code: 3630 |
| Central Heat | A | Dwl/Gar/NC% 1.0500 |
| FORCED AIR | | |
| Plumbing | | |
| Standard | 1 | |

| Bldg Type | SHB+Cons | DixHt | Area | Unit Rate | Grade | Blt/Renov | Replace | Phy Dpr | Fnc Dpr | True Value |
|------------|-----------------|--------------------|-------|--------------|-------------|----------------|----------------|------------|---------|------------|
| 1 DWELLING | 2 BAF | | 2010 | | C | OLD/AV | 200440 | .55 | | 94710 |
| 2 Shed | *PP | 10X10 | 100 | | | 1999AV | 0 | | | 0 |
| 3 Shed | *PP | 8X8 | 64 | | | OLD/ | 0 | | | 0 |
| front lot | acres/ frontage | effective frontage | depth | depth factor | actual rate | effective rate | extended value | true value | | |
| front lot | 37.0000 | 37.00 | 95 | 79 | 140 | 111 | 4110 | 4110 | | |
| front lot | 35.0000 | 20.00 | 72 | 70 | 140 | 98 | 1960 | 1960 | | |

Call Back: Sign: PSN Date: 2015-04-29 Lister: Sign: PSN Date: 2015-04-29 Lister: