

PLEASANT TWP  
KENTON CORP

00350

Hardin County, Ohio  
Michael T. Bacon, Auditor

36-560008.0000  
Z94

RES  
2025

sale

Eff Rate:- 50.59 — 44.66 — 47.03 — 46.74 — a/r

2022	SCOTT BARBARA J	1995-11-03	
2023	SCOTT BARBARA J	1995-11-03	
2024	SCOTT BARBARA J	1995-11-03	
2025	SCOTT BARBARA J	1995-11-03	HOUSERS E PT OL 11
	333 N HIGH ST		
	KENTON OH 43326	\$0	

Tax Year	2022	2023	2024	2025	2025	
Prop Cls	510	510	510	510	510	CAMA 510
Acres						
Land100%	4490	5970	5970	5970	5970	5980
Bldg100%	76230	92290	92290	92290	92290	92290
Totl100%	80710t	98260t	98260t	98260t	98260t	98270t
Cauv100%						
Tax Value:						
Land 35%	1570	2090	2090	2090	2090	2090
Bldg 35%	26680	32300	32300	32300	32300	32300
Totl 35%	28250t	34390t	34390t	34390t	34390t	34390t
Hmstd35%						
Owner Oc	27.40	30.44	30.40	30.32	30.32	
Hmstd RB	400.22	368.96	417.58	429.66	429.66	
Net Tax	892.04	1014.58	1047.88	1026.04	1026.04	
Sp-Asmnt	21.31	21.31	32.21	32.21		

SHB+	CONS	TYPE	FACT	SQ-FT	VALUE		
1 B	F	M		1323		a	*MAIN
1	F/C	A		200		b	ADDTN
	OP	P		100	3000	c	PORCH
	EPF	P		40	1600	d	PORCH
	STP	P		18	70	e	PORCH

gas fireplace

Sale#	#p	sale date	To	Type/Invalid?	Sale\$	co:land	co:bldg
1084	1	1995-11-03	SCOTT BARBARA J	1WD	67000	5600	36510
779	1	1989-09-18		1WD	39000	0	31600
1069	0	1987-12-24		1WD *	12823	0	31600

Year	Land	Bldg	Total	Net Tax
2021	1570	26680	28250	895.32
2020	1570	26680	28250	775.04

project

902 MAIN DISTRICT CONSERVANCY	ben acres	/	%	factor
500 HARDIN COUNTY LANDFILL				
	XA/2025			
	XA/2025			

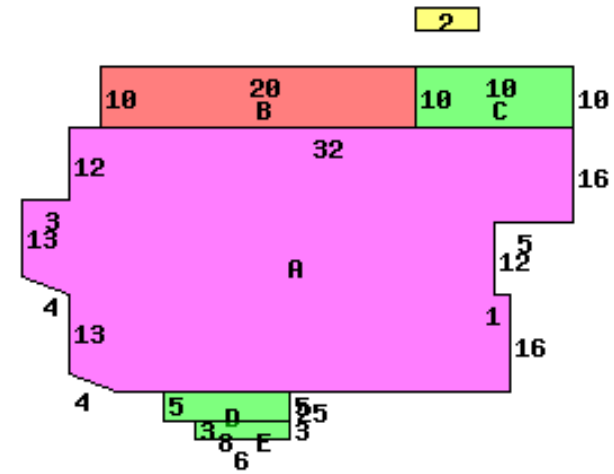

333 N HIGH ST 43326

Occupancy 1 Single Family	*DWELLING COMPUTATIONS	
Story Height 1	Sq-Ft	Value
Floor Level		
	Main	FRAME
	Basement	
	Subtotal	
	Roof	GABLE
Metal	B 1 2 U A	
Plaster/Drywall	P	Air Conditioning 2590
Panelled Wall	X	Plumbing 1400
Unfinished Wall	X	Extra Features 4670
Floor/Carpet	X	Total Value 141560
Floor/Concrete	X	
Number of Rooms	1 6	PUB SIDEWALK
Bedrooms	2	
Central Heat	A	Neighborhood:
FORCED AIR		Code: 3630
Central A/C	A	Dwl/Gar/NC% 1.0500
Plumbing		
Standard	1	
Extra 2 Fixture	1	

Bldg Type	SHB+Cons	DixHt	Unit	Blt/Renov	Replace	Phy	Fnc	True
1 DWELLING	1 B F	1523	Rate	Grade	Cond	Value	Dpr	Dpr
2 Garage		16X22	Area	C	OLD/GD	141560	.40	89180
			352	C	1982AV	8450	.65	3110
	acres/	effective	depth	actual	effective	extended	true	
front lot	45.7500	46.00	130	93	140	130	5980	5980

Call Back:	Sign: PSN Date: 2015-04-29	Lister:	36-560008.0000-v082020R
------------	----------------------------	---------	-------------------------