

PLEASANT TWP
KENTON CORP

00350

Hardin County, Ohio
Michael T. Bacon, Auditor

36-540024.0000
Q42

RES
2023

sale

Eff Rate:- 44.63 — 50.76 — 50.59 — 44.66 — a/r

2020 MYERS ASHLEY L	2017-04-19
2021 MYERS ASHLEY L	2017-04-19
2022 MYERS ASHLEY L	2017-04-19
2023 MYERS ASHLEY L	2017-04-19
353 N SUPERIOR ST	E LAWN 24-26
	1WD
KENTON OH 43326	\$135,000
	07.1-05-54-024

Tax Year	2020	2021	2022	2023	CAMA
Prop Cls	510	510	510	510	510
Acres					
Land100%	12110	12110	12110	16110	16120
Bldg100%	117710	117710	117710	153000	152990
Totl100%	129830t	129830t	129830t	169110t	169110t
Cauvl00%					

2024 HOMMEL REX T & DANETTE	2024-02-16
353 N SUPERIOR ST	1SD
KENTON OH 43326	

Tax Value:					
Land 35%	4240	4240	4240	5640	5640
Bldg 35%	41200	41200	41200	53550	53550
Totl 35%	45440t	45440t	45440t	59190t	59190t
Hmstd35%					
Owner Oc	44.40	44.06	44.08	52.38	
Hmstd RB					
Net Tax	1806.00	2086.32	2078.58	2381.30	
Sp-Asmnt	26.47	26.48	26.47	26.47	

SHB+	CONS	TYPE	FACT	SQ-FT	VALUE		
1 B	B	M		1998		a	*MAIN
	B	P		180	720	b	PORCH
	B	G		352	9860	c	GRAGE
	PAT	P		390	1170	d	PORCH
	B2	G		550	15400	e	GRAGE
	RFX	P		180	1800	f	PORCH
	STP	P		36	140	g	PORCH
	PAT	P		210	630	h	PORCH

#: 25 26 L/W
365400250000
365400260000
FIREPLACE NOT USABLE.

Sale#	#p	sale date	To	Type/Invalid?	Sale\$	co:land	co:blgd
69	1	2024-02-16	HOMMEL REX T & DANETTE K	1SD	240000	16110	153000
172	1	2017-04-19	MYERS ASHLEY L	1WD	135000	16370	77940
407	2	2015-10-16	HEYDINGER CHAD & NATASHA	2QC *	0	16370	77940
489	1	2013-10-09	HEYDINGER CHAD & TICE MAR	1WD	90000	16370	106830
476	1	2008-12-31	HORD TERRY L ETAL	1QC *	0	15230	105940
17	1	2007-01-16	HORD TERRY L ETAL	1QC *	0	14460	98340
522	1	2006-12-27	HOMMEL REX T ETAL	1QC *	0	14460	98340

Year	Land	Bldg	Total	Net Tax
2019	4040	33440	37480	1437.72
2018	4040	33440	37480	1439.22

project
902 MAIN DISTRICT CONSERVANCY XA/2023
500 HARDIN COUNTY LANDFILL XA/2023
ben acres / % factor

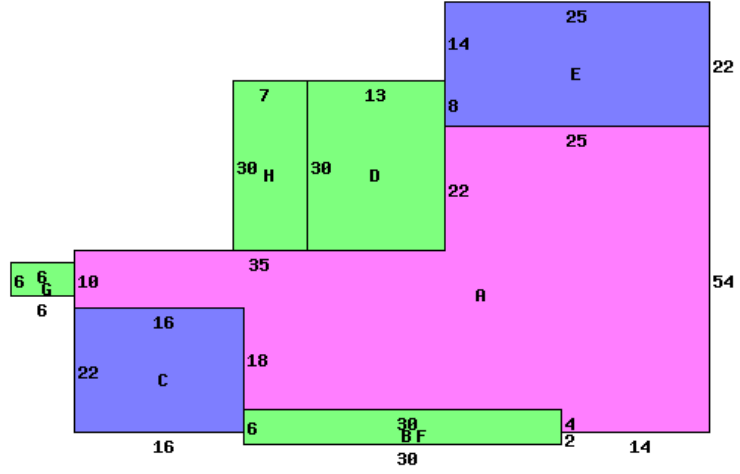

353 N SUPERIOR ST 43326

Occupancy 1 Single Family			*DWELLING COMPUTATIONS	
Story Height	1		Sq-Ft	Value
Floor Level	Main	BRICK	1998	151510
	Basement		1218	22680
	Subtotal			174190
Shingle	Roof	HIP		

Bldg Type	SHB+Cons	DixHt	Area	Unit	Grade	Blt/Renov	Replace	Phy Dpr	Fnc Dpr	True Value
1 DWELLING	1 B B	1998	1998		C+	1953GD	231280	.37		152990
front lot	effective	depth	depth	actual	effective	extended	true			
	124.00	130	93	140	130	16120	16120			

Plaster/Drywall	P	Air Conditioning	3540
Unfinished Wall	X	Plumbing	2800
Floor/Hardwood	X	Garages and Carports	25260
Floor/Carpet	X	Extra Features	4460
Floor/Tile-Lino	L	Total Value	210250
Number of Rooms	17		
Bedrooms	3		
Central Heat	A	Neighborhood:	
FORCED AIR		Code:	3630
Central A/C	A	Dwl/Gar/NC%	1.0500
Plumbing			
Standard	1		
Extra 3 Fixture	1		
Extra Fixture	1		