

PLEASANT TWP
KENTON CORP

00350

Hardin County, Ohio
Michael T. Bacon, Auditor

36-533012.0000
T107

RES
2025

sale

Eff Rate:- 50.59 — 44.66 — 47.03 — 46.74 — a/r

2022	MANN'S RHONDA L	2009-10-14
2023	MANN'S RHONDA L	2009-10-14
2024	MANN'S RHONDA L	2009-10-14
2025	MANN'S RHONDA L	2009-10-14
400 STONE GATE DR		
KENTON OH 43326		
1QC LOT 12		
\$0		

Tax Year	2022	2023	2024	2025	2025	CAMA
Prop Cls	510	510	510	510	510	510
Acres	15340	17570	17570	17570	17570	17560
Land100%	117430	134030	134030	134030	134030	134020
Bldg100%	132770t	151600t	151600t	151600t	151600t	151580t
Totl100%						
Cauv100%						

2026	GRIMM LANE M	2025-10-22
400 STONE GATE DR		
KENTON OH 43326		
1WD		
Orig Tax Year 2001		
Parent: 36-530005.0000		

Tax Value:	5370	6150	6150	6150	6150	6150
Land 35%	41100	46910	46910	46910	46910	46910
Bldg 35%	46470t	53060t	53060t	53060t	53060t	53050t
Totl 35%						
Hmstd35%	45.08	46.96	46.90	46.78	46.78	
Owner Oc						
Hmstd RB	2125.70	2134.68	2261.06	2245.98	2245.98	
Net Tax						
Sp-Asmnt	30.00	35.50	31.50	34.50		

SHB+	CONS	TYPE	FACT	SQ-FT	VALUE	a	*MAIN
1 B	F	M		1152			
1	OH	P		24	910		b PORCH
1	F/C	A		240			c ADDTN
	F	G		400	11620		d GRAGE
	OPF	P		120	3600		e PORCH
	DK	P		164	2460		f PORCH

Sale#	#p	sale date	To	Type/Invalid?	Sale\$	co:land	co:bldg
474	1	2025-10-22	GRIMM LANE M	1WD	255000	17570	134030
307	1	2009-10-14	MANN'S RHONDA L	1QC *	15060		114110
272	1	2008-06-02	MANN'S RANDY & RHONDA L	1SD	130000	14140	108970
67	1	2008-02-15	VERMILLION CAROL JEAN	1QC *	0	14140	108970
66	1	2008-02-15	VERMILLION CAROL JEAN ET	1CT *	0	14140	108970
602	1	2003-10-17	BOGARDUS JANET C	1WD	132500	12860	52800
136	1	2003-03-21	SCALZO LAWRENCE J & SKOW	1WD	123500	12860	52800

Year	Land	Bldg	Total	Net Tax
2021	5370	41100	46470	2133.60
2020	5370	41100	46470	1846.94

Project	ben acres	%	factor
131 BLANCHARD RIVER MAINT			XA/2025
235 KELLOGG #983 - BLANCHARD			XA/2025
500 HARDIN COUNTY LANDFILL			XA/2025
921 BLANCHARD RIVER MAINT			XA/2023
306 BLOOM #1043 - BLANCHARD			XA/2025
349 OSBORN-BLANCHARD RIVER			XA/2025

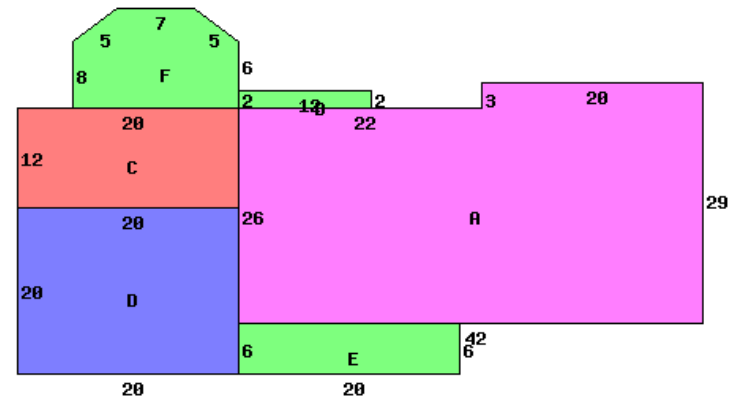

400 STONE GATE DR 43326

Occupancy 1 Single Family		*DWELLING COMPUTATIONS	
Story Height	1	Sq-Ft	Value
Floor Level	Main	FRAME	1392 110720
	Basement		1152 21460
	Subtotal		132180
Shingle	Roof	GABLE	
B 1 2 U A			
Plaster/Drywall	D	Air Conditioning	2420
Panelled Wall	X	Plumbing	2100
Unfinished Wall	X	Garages and Carports	11620
Floor/Hardwood	X	Extra Features	7770
Floor/Carpet	X	Total Value	156090
Floor/Concrete	X		
Floor/Tile-Lino	X	PUB PAVED ST/RD	
Number of Rooms	3 6		
Bedrooms	3	Neighborhood:	
		Code:	3690
Central Heat	A	Dwl/Gar/NC%	1.0600
Heat Pump	A		
Central A/C	A		
Plumbing			
Standard	1		
Extra 3 Fixture	1		

Bldg Type	SHB+Cons	DixHt	Area	Unit Rate	Grade	Blt/Renov	Replace	Phy Dpr	Fnc Dpr	True Value
1 DWELLING	1 B F		1392		C	2000GD	156090	.19		134020
2 Shed	*PP	10X12	120			OLD/	0			0

front lot

acres/ frontage	effective frontage	depth	actual factor	rate	effective rate	extended value	true value
84.00	114	87	240	209	17560	17560	

Call Back:

Sign: PSN Date: 2015-02-23 Lister:

36-533012.0000-v082020R