

PLEASANT TWP
KENTON CORP

00350

Hardin County, Ohio
Michael T. Bacon, Auditor

36-531015.0000
T133

RES
2025

sale

Eff Rate:- 50.59 — 44.66 — 47.03 — 46.74 — a/r

| | |
|---------------------|--------------------------------|
| 2022 ADAMS JOSHUA E | 2015-01-20 |
| 2023 ADAMS JOSHUA E | 2015-01-20 |
| 2024 ADAMS JOSHUA E | 2015-01-20 |
| 2025 ADAMS JOSHUA E | 2015-01-20 |
| 624 PATTISON AVE | 2015-01-20 HERITAGE ESTATES 15 |
| | 2WD |
| KENTON OH 43326 | \$98,000 |

| | | | | | |
|------------|---------|---------|---------|---------|---------|
| Tax Year | 2022 | 2023 | 2024 | 2025 | CAMA |
| Prop Cls | 510 | 510 | 510 | 510 | 510 |
| Acres | | | | | |
| Land100% | 16710 | 25400 | 25400 | 25400 | 25400 |
| Bldg100% | 145970 | 165170 | 165170 | 167910 | 167920 |
| Totl100% | 162690t | 190570t | 190570t | 193310t | 193320t |
| Cauv100% | | | | | |
| Tax Value: | | | | | |
| Land 35% | 5850 | 8890 | 8890 | 8890 | 8890 |
| Bldg 35% | 51090 | 57810 | 57810 | 58770 | 58770 |
| Totl 35% | 56940t | 66700t | 66700t | 67660t | 67660t |
| Hmstd35% | | | | | |
| Owner Oc | 55.24 | 59.02 | 58.96 | 58.80 | 58.80 |
| Hmstd RB | | | | | |
| Net Tax | 2604.60 | 2683.46 | 2842.32 | 2864.82 | |
| Sp-Asmnt | 30.00 | 35.50 | 31.50 | 34.50 | |

| | | | | | | | |
|------|------|------|------|-------|-------|---|-------|
| SHB+ | CONS | TYPE | FACT | SQ-FT | VALUE | a | *MAIN |
| 1 B | F | M | | 1728 | | b | GRAGE |
| | F3 | G | | 896 | 21500 | c | ADDTN |
| 1 | F | A | | 184 | | d | PORCH |
| | OPF | P | | 72 | 2160 | e | PORCH |
| | CAN | P | | 336 | 2690 | f | PORCH |
| | DK | P | | 336 | 5040 | | |

| | | | | | | | |
|-------|----|------------|------------------------|---------------|---------|---------|---------|
| Sale# | #p | sale date | To | Type/Invalid? | Sale\$ | co:land | co:blgd |
| 29 | 2 | 2015-01-20 | ADAMS JOSHUA E | 2WD * | 98000 | 14400 | 126260 |
| 341 | 2 | 2014-08-08 | HOME SAVINGS & LOAN CO | 2DD * | 8666668 | 14400 | 139860 |
| 511 | 1 | 1996-11-13 | PORTER JOHN E | 1AF * | 0 | 15910 | 105740 |
| 545 | 1 | 1989-07-06 | | 1WD | 124500 | 0 | 49310 |

| | | | | |
|------|------|-------|-------|---------|
| Year | Land | Bldg | Total | Net Tax |
| 2021 | 5850 | 51090 | 56940 | 2614.32 |
| 2020 | 5850 | 51090 | 56940 | 2263.08 |

| | | | | |
|------------------------------|-----------|---|---|---------|
| project | ben acres | / | % | factor |
| 131 BLANCHARD RIVER MAINT | | | | XA/2025 |
| 235 KELLOGG #983 - BLANCHARD | | | | XA/2025 |
| 500 HARDIN COUNTY LANDFILL | | | | XA/2025 |
| 921 BLANCHARD RIVER MAINT | | | | XA/2023 |
| 306 BLOOM #1043 - BLANCHARD | | | | XA/2025 |
| 349 OSBORN-BLANCHARD RIVER | | | | XA/2025 |

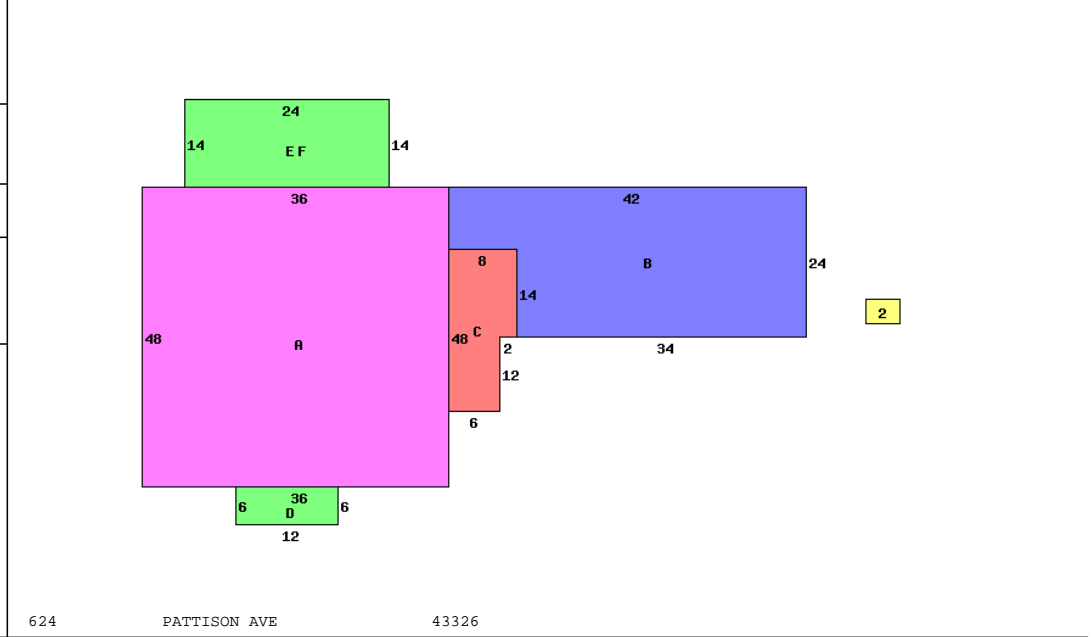

| | | |
|-----------------|-----------------|----------------------------|
| Occupancy | 1 Single Family | *DWELLING COMPUTATIONS |
| Story Height | 1 | Sq-Ft Value |
| Floor Level | Main | FRAME 1912 133670 |
| | Basement | 1728 31970 |
| | Subtotal | 165640 |
| Metal | Roof | GABLE |
| | B 1 2 U A | |
| Plaster/Drywall | X | Air Conditioning 3270 |
| Unfinished Wall | X | Plumbing 4200 |
| Floor/Carpet | X | Garages and Carports 21500 |
| Number of Rooms | 1 6 | Extra Features 10430 |
| Bedrooms | 3 | Total Value 205040 |
| Central Heat | A | PUB ELECTRIC |
| ELECTRIC | | PUB GAS |
| Central A/C | A | PUB PAVED ST/RD |
| Plumbing | | |
| Standard | 1 | Neighborhood: |
| Extra 3 Fixture | 2 | Code: 3690 |
| | | Dwl/Gar/NC% 1.0600 |

| | | | | | | | | |
|------------|----------|-----------|-------|-----------|-----------|----------|-------|--------|
| Bldg Type | SHB+Cons | DixHt | Unit | Blt/Renov | Replace | Phy | Fnc | True |
| 1 DWELLING | 1 B F | 1912 | Area | Grade | Cond | Dpr | Dpr | Value |
| 2 Shed | | 10X24 | 240 | C | 1988GD | .24 | | 165180 |
| | | | | C | 2024AV | .05 | | 2740 |
| front lot | acres/ | effective | depth | actual | effective | extended | true | |
| | frontage | frontage | depth | factor | rate | value | value | |
| | 100.0000 | 100.00 | 170 | 106 | 240 | 25400 | 25400 | |

| | | | |
|------------|----------------------------|---------|-------------------------|
| Call Back: | Sign: PSN Date: 2015-02-24 | Lister: | 36-531015.0000-v082020R |
|------------|----------------------------|---------|-------------------------|