

PLEASANT TWP  
KENTON CORP

00350

Hardin County, Ohio  
Michael T. Bacon, Auditor

36-490036.0000  
J19

RES  
2025

sale

Eff Rate:- 50.59 — 44.66 — 47.03 — 46.74 — a/r

|                    |                      |
|--------------------|----------------------|
| 2022 WILEY JERRY E | 1988-01-13           |
| 2023 WILEY JERRY E | 1988-01-13           |
| 2024 WILEY JERRY E | 1988-01-13           |
| 2025 WILEY JERRY E | 1988-01-13 BRUMMS 36 |
| 46 BROADWAY ST     | \$10,000             |
| KENTON OH 43326    |                      |

|            |         |         |         |         |         |                      |
|------------|---------|---------|---------|---------|---------|----------------------|
| Tax Year   | 2022    | 2023    | 2024    | 2025    | 2025    | CAMA                 |
| Prop Cls   | 510     | 510     | 510     | 510     | 510     | 510                  |
| Acres      | 5940    | 7910    | 7910    | 7910    | 7910    | 7900                 |
| Land100%   | 92540   | 103430  | 103430  | 103430  | 103430  | 103430               |
| Bldg100%   | 98490t  | 111340t | 111340t | 111340t | 111340t | 111330t              |
| Totl100%   |         |         |         |         |         |                      |
| Cauv100%   |         |         |         |         |         |                      |
| Tax Value: |         |         |         |         |         |                      |
| Land 35%   | 2080    | 2770    | 2770    | 2770    | 2770    | 2770                 |
| Bldg 35%   | 32390   | 36200   | 36200   | 36200   | 36200   | 36200                |
| Totl 35%   | 34470t  | 38970t  | 38970t  | 38970t  | 38970t  | 38970t               |
| Hmstd35%   | 34470   | 38970   | 38970   | 38970   | 38970   | 38970                |
| Owner Oc   | 33.44   | 34.48   | 34.48   | 34.36   | 34.36   | hmstd 2770 l 36200 b |
| Hmstd RB   | 400.22  | 368.96  | 417.58  | 429.66  | 429.66  |                      |
| Net Tax    | 1176.56 | 1198.88 | 1243.06 | 1219.88 | 1219.88 |                      |
| Sp-Asmnt   | 21.64   | 21.64   | 33.27   | 33.27   |         |                      |

|         |          |        |          |           |           |         |
|---------|----------|--------|----------|-----------|-----------|---------|
| SHB+ 1T | CONS F/C | TYPE M | FACT 640 | SQ-FT 288 | VALUE 180 | a *MAIN |
| 1 A     | F/C      | A      | 288      |           |           | b ADDTN |
| 1 B     | F        | A      | 180      |           |           | c ADDTN |
|         | PAT      | P      | 345      | 1040      |           | d PORCH |
|         | STP      | P      | 49       | 200       |           | e PORCH |
|         | OFF      | P      | 288      | 8640      |           | f PORCH |

|           |           |                      |             |                 |              |           |               |
|-----------|-----------|----------------------|-------------|-----------------|--------------|-----------|---------------|
| Sale# 25  | #p 0      | sale date 1988-01-13 | To          | Type/Invalid? * | Sale\$ 10000 | co:land 0 | co:bldg 36000 |
| Year 2021 | Land 2080 | Bldg 32390           | Total 34470 | Net Tax 1180.92 |              |           |               |
| 2020      | 2080      | 32390                | 34470       | 1022.24         |              |           |               |

|                               |           |     |        |
|-------------------------------|-----------|-----|--------|
| project                       | ben acres | / % | factor |
| 902 MAIN DISTRICT CONSERVANCY |           |     |        |
| 500 HARDIN COUNTY LANDFILL    |           |     |        |
| XA/2025                       |           |     |        |
| XA/2025                       |           |     |        |

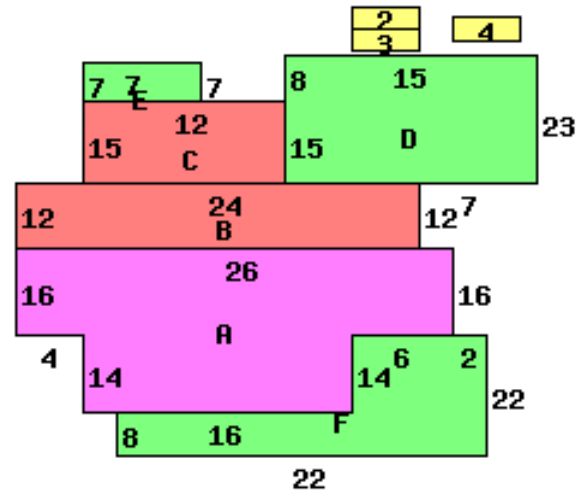

46 BROADWAY ST 43326

|                           |                         |
|---------------------------|-------------------------|
| Occupancy 1 Single Family | *DWELLING COMPUTATIONS  |
| Story Height 1T           | Sq-Ft Value             |
| Floor Level               |                         |
| Main                      | FRAME 1108 102260       |
| Part Upper                | FRAME 640 38070         |
| Qtr Story                 | FRAME 288 1360          |
| Basement                  | 180 3790                |
| Subtotal                  | 145480                  |
| Metal Roof                | GABLE                   |
| Plaster/Drywall           | X X Plumbing 2100       |
| Panelled Wall             | X X Extra Features 9880 |
| Unfinished Wall           | X X Total Value 157460  |
| Floor/Hardwood            | X X                     |
| Floor/Carpet              | X X PUB SIDEWALK        |
| Number of Rooms           | 5 2 1                   |
| Bedrooms                  | 2 Neighborhood:         |
| Central Heat              | A Code: 3630            |
| HOT WATER                 | Dwl/Gar/NC% 1.0500      |
| Plumbing                  |                         |
| Standard                  | 1                       |
| Extra 3 Fixture           | 1                       |

|            |          |           |       |        |           |          |       |      |       |
|------------|----------|-----------|-------|--------|-----------|----------|-------|------|-------|
| Bldg Type  | SHB+Cons | DixHt     | Unit  | Grade  | Blt/Renov | Replace  | Phy   | Fnc  | True  |
| 1 DWELLING | 1T F/C   | 1748      |       | C      | 1930GD    | 157460   | .40   | Dpr  | 99200 |
| 2 Garage   |          | 14X30     | 420   | C      | OLD/GD    | 10080    | .60   |      | 4230  |
| 3 Shed     | *PP 0    | 9X14      | 126   |        | OLD/      | 0        |       |      | 0     |
| 4 Shed     | *PP      | 8X10      | 80    |        | OLD/      | 0        |       |      | 0     |
| front lot  | acres/   | effective | depth | actual | effective | extended | true  |      |       |
|            | frontage | frontage  | depth | factor | rate      | value    | value |      |       |
|            | 50.0000  | 50.00     | 200   | 113    | 140       | 158      | 7900  | 7900 |       |