

PLEASANT TWP
KENTON CORP

00350

Hardin County, Ohio
Michael T. Bacon, Auditor

36-430080.0000
I11

RES
2025

sale

Eff Rate:- 50.59 — 44.66 — 47.03 — 46.74 — a/r

2022 WOOD ERIC S	2010-09-24
2023 WOOD ERIC S	2010-09-24
2024 WOOD ERIC S	2010-09-24
2025 WOOD ERIC S	2010-09-24 STEVENS & SONS PT 6
830 E FRANKLIN ST	IQC
KENTON OH 43326	\$0

Tax Year	2022	2023	2024	2025	CAMA
Prop Cls	510	510	510	510	510
Acres					
Land100%	5400	6170	6170	6170	6170
Bldg100%	73660	85460	85460	85460	85460
Totl100%	79060t	91630t	91630t	91630t	91630t
Cauv100%					
Tax Value:					
Land 35%	1890	2160	2160	2160	2160
Bldg 35%	25780	29910	29910	29910	29910
Totl 35%	27670t	32070t	32070t	32070t	32070t
Hmstd35%					
Owner Oc	26.84	28.38	28.36		
Hmstd RB					
Net Tax	1265.72	1290.24	1366.60		
Sp-Asmnt	21.31	21.31	31.73		

Orig Tax Year 2002
Parent: 36-430006.0000

SHB+	CONS	TYPE	FACT	SQ-FT	VALUE	a	*MAIN
2	F/C	M		644			
1	F/C	A		90			b ADDTN
1 B	F	A		308			c ADDTN
	OPF	P		90	2700		d PORCH
	DK	P		176	2640		e PORCH

Year	Land	Bldg	Total	Net Tax
2021	1890	25780	27670	1270.42
2020	1890	25780	27670	1099.74

Project 500 902 ben acres / % factor

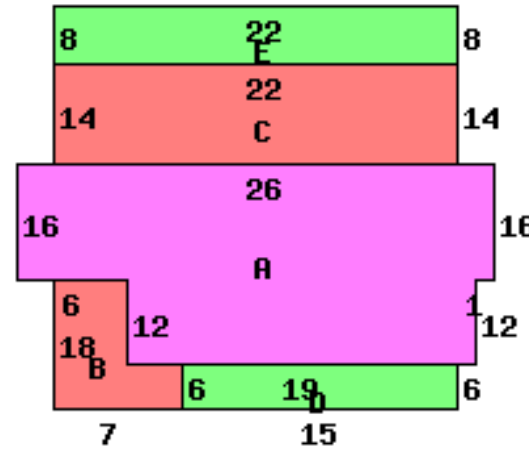

830 E FRANKLIN ST 43326

Occupancy 1 Single Family	*DWELLING COMPUTATIONS	
Story Height 2	Sq-Ft	Value
Floor Level		
Main	FRAME	1042 104880
Full Upper	FRAME	644 51640
Qtr Story	FRAME	308 1420
Basement		154 3240
Subtotal		161180
Shingle	Roof	GABLE
Panelled Wall	P P	Air Conditioning 3050
Unfinished Wall	X X	Extra Features 5340
Floor/Hardwood	X X	Total Value 169570
Floor/Concrete	X	
Floor/Tile-Lino	X	PUB PAVED ST/RD
Number of Rooms	1 5 3 1	
Bedrooms	3	Neighborhood:
		Code: 3620
Central Heat	A	Dwl/Gar/NC% 1.1200
FORCED AIR		
Central A/C	A	
Plumbing		
Standard	1	

Bldg Type	SHB+Cons	DixHt	Unit	Blt/Renov	Replace	Phy Fnc	True
1 DWELLING	2 BAF	FtxFt	Area	Grade	Value	Dpr Dpr	Value
			1686	C	169570	.55	85460
front lot	acres/	effective	depth	depth	effective	extended	true
	frontage	frontage	factor	actual	rate	value	value
		49.00	165	105	120	126	6170
				120	126	6170	6170

Call Back:

Sign: PSN Date: 2015-02-25 Lister:

36-430080.0000-v082020R