

PLEASANT TWP
KENTON CORP

00350

Hardin County, Ohio
Michael T. Bacon, Auditor

36-400041.0000
L31

RES
2023

sale

Eff Rate:- 44.63 — 50.76 — 50.59 — 44.66 — a/r

| | | |
|------|------------------------|----------------|
| 2020 | BARLOW PAUL E & JEAN | 1993-04-12 |
| 2021 | BARLOW PAUL E & JEAN | 1993-04-12 |
| 2022 | BARLOW PAUL E & JEAN | 1993-04-12 |
| 2023 | BARLOW PAUL E & JEAN M | 1993-04-12 |
| | 203 S HENRY ST | E-W 15 |
| | | LWD |
| | | \$40,500 |
| | KENTON OH 43326 | 07.1-05-40-041 |

| | | | | | |
|------------|--------|---------|---------|---------|--------|
| Tax Year | 2020 | 2021 | 2022 | 2023 | CAMA |
| Prop Cls | 510 | 510 | 510 | 510 | 510 |
| Acres | | | | | |
| Land100% | 6400 | 6400 | 6400 | 7310 | 7310 |
| Bldg100% | 58200 | 58200 | 58200 | 78540 | 78530 |
| Totl100% | 64600t | 64600t | 64600t | 85860t | 85840t |
| Cauv100% | | | | | |
| Tax Value: | | | | | |
| Land 35% | 2240 | 2240 | 2240 | 2560 | 2560 |
| Bldg 35% | 20370 | 20370 | 20370 | 27490 | 27490 |
| Totl 35% | 22610t | 22610t | 22610t | 30050t | 30040t |
| Hmstd35% | | | | | |
| Owner Oc | 22.10 | 21.92 | 21.94 | 26.60 | |
| Hmstd RB | | | | | |
| Net Tax | 898.64 | 1038.10 | 1034.26 | 1208.96 | |
| Sp-Asmnt | 21.21 | 21.22 | 21.21 | 21.21 | |

| | | | | | | | |
|------|------|------|------|-------|-------|---|-------|
| SHB+ | CONS | TYPE | FACT | SQ-FT | VALUE | a | *MAIN |
| 1HB | F | M | | 532 | | b | ADDTN |
| 1 | F/C | A | | 190 | | c | PORCH |
| | OFFP | P | | 208 | 6240 | d | ADDTN |
| 1 | F/C | A | | 591 | | e | PORCH |
| | DK | P | | 160 | 2400 | | |

| | | | | | | | |
|-------|----|------------|------------------------|---------------|--------|---------|---------|
| Sale# | #p | sale date | To | Type/Invalid? | Sale\$ | co:land | co:bldg |
| 264 | 1 | 1993-04-12 | BARLOW PAUL E & JEAN M | LWD | 40500 | 0 | 32630 |

| | | | | |
|------|------|-------|-------|---------|
| Year | Land | Bldg | Total | Net Tax |
| 2019 | 2130 | 16600 | 18730 | 718.48 |
| 2018 | 2130 | 16600 | 18730 | 719.22 |

| | | | | |
|-------------------------------|-----------|---|---|---------|
| project | ben acres | / | % | factor |
| 902 MAIN DISTRICT CONSERVANCY | | | | XA/2023 |
| 500 HARDIN COUNTY LANDFILL | | | | XA/2023 |

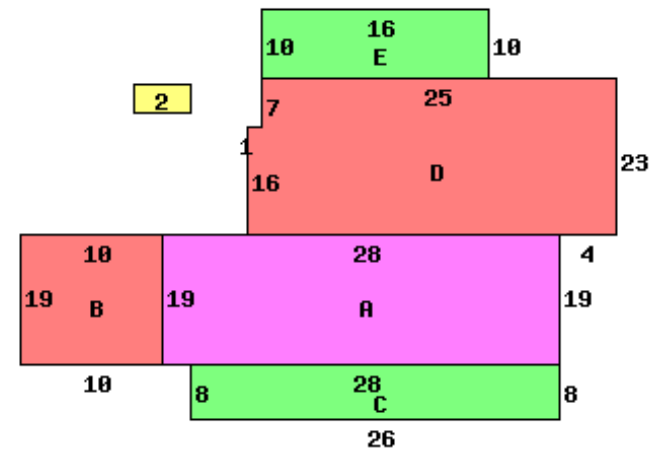

203 S HENRY ST 43326

| | | |
|-----------------|-----------------|------------------------|
| Occupancy | 1 Single Family | *DWELLING COMPUTATIONS |
| Story Height | 1H | Sq-Ft Value |
| Floor Level | Main | FRAME 1313 105240 |
| | Part Upper | FRAME 532 27790 |
| | Basement | 133 2940 |
| | Subtotal | 135970 |
| Shingle | Roof | GABLE |
| | B 1 2 U A | |
| Plaster/Drywall | D | Extra Features 8640 |
| Panelled Wall | X | Total Value 144610 |
| Unfinished Wall | X | |
| Floor/Pine | X X | PUB PAVED ST/RD |
| Floor/Carpet | X | PUB SIDEWALK |
| Number of Rooms | 1 5 2 | |
| Bedrooms | 1 2 | Neighborhood: |
| | | Code: 3620 |
| Central Heat | A | Dwl/Gar/NC% 1.1200 |
| FORCED AIR | | |
| Plumbing | | |
| Standard | 1 | |

| | | | | | | | | | |
|------------|----------|-----------|-------|-----------|-----------|----------|-------|------|-------|
| Bldg Type | SHB+Cons | DixHt | Unit | Blt/Renov | Replace | Phy | Fnc | True | |
| 1 DWELLING | 1HB F | FtxFt | Area | Grade | Cond | Value | Dpr | Dpr | Value |
| 2 Garage | | 30X20 | 1845 | C | OLD/AV | 144610 | .55 | | 72880 |
| | | | 600 | C | OLD/AV | 14400 | .65 | | 5650 |
| front lot | acres/ | effective | depth | actual | effective | extended | true | | |
| | frontage | frontage | depth | factor | rate | value | value | | |
| | 58.0000 | 58.00 | 168 | 105 | 120 | 7310 | 7310 | | |

Call Back:

Sign: PSN Date: 2015-03-25 Lister:

36-400041.0000-v082020R