

PLEASANT TWP
KENTON CORP

00350

Hardin County, Ohio
Michael T. Bacon, Auditor

36-340017.0000
G26

RES
2025

sale

2022 ADAMS DONALD R	CARYS W PT OL 4 & OL 5
2023 ADAMS DONALD R	
2024 ADAMS DONALD R	
2025 ADAMS DONALD R	
900 W CAREY ST	
KENTON OH 43326	\$0

Eff Rate:-	50.59	44.66	47.03	46.74	a/r
Tax Year	2022	2023	2024	2025	CAMA
Prop Cls	510	510	510	510	510
Acres	5910	8510	8510	8510	8520
Land100%	47800	55540	55540	55540	55550
Bldg100%	53710t	64060t	64060t	64060t	64070t
Totl100%					
Cauv100%					
Tax Value:					
Land 35%	2070	2980	2980	2980	2980
Bldg 35%	16730	19440	19440	19440	19440
Totl 35%	18800t	22420t	22420t	22420t	22420t
Hmstd35%	18800	22420	22420	22420	
Owner Oc	18.24	19.84	19.82	19.76	hmstd 2980 l 19440 b
Hmstd RB	400.22	368.96	417.58	429.66	
Net Tax	459.74	533.04	537.82	519.36	
Sp-Asmnt	20.96	20.96	29.79	29.79	

SHB+ 1	CONS F/C	TYPE M	FACT	SQ-FT 760	VALUE	a	*MAIN
Year	Land	Bldg	Total	Net Tax			
2021	2070	16730	18800	461.44			
2020	2070	16730	18800	399.44			

Project
902 MAIN DISTRICT CONSERVANCY XA/2025
500 HARDIN COUNTY LANDFILL XA/2025

ben acres / % factor

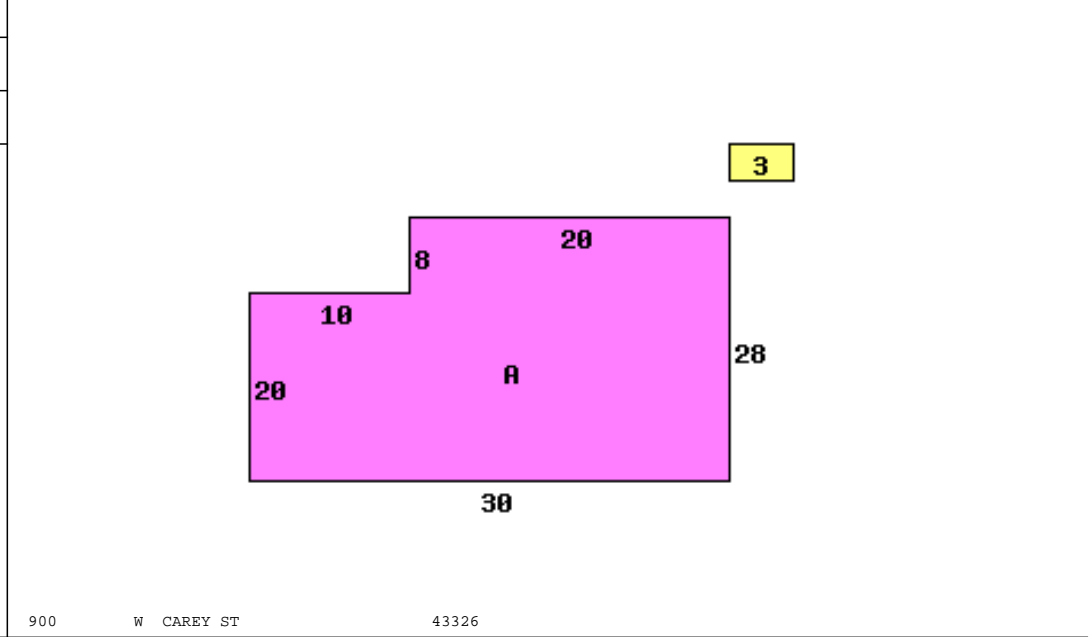

Occupancy 1 Single Family		*DWELLING COMPUTATIONS	
Story Height	1	Sq-Ft	Value
Floor Level	Main	FRAME	760 92860
Shingle	Subtotal	FRAME	92860
	Roof	GABLE	
Plaster/Drywall	X		
Floor/Hardwood	X	Heating	-880
Floor/Carpet	X	Total Value	91980
Floor/Tile-Lino	X		
Number of Rooms	5	Neighborhood:	
Bedrooms	2	Code:	3670
Plumbing		Dwl/Gar/NC%	1.0900
Standard	1		

Bldg Type	SHB+Cons	DixHt	Unit	Grade	Blt/Renov	Replace	Phy	Fnc	True
1 DWELLING	1 F/C	FtxFt	Area	Rate	Cond	Value	Dpr	Dpr	Value
3 Garage		20X24	480		D	1953GD	73580	.37	50530
					C	1993AV	11520	.60	5020
front lot	60.0000	effective	60.00	depth	actual	effective	extended	true	value
		frontage	265	factor	rate	rate	value	value	
			118		120	142	8520	8520	

Call Back: Sign: PSN Date: 2015-02-19 Lister: 36-340017.0000-v082020R