

PLEASANT TWP
KENTON CORP

00350

Hardin County, Ohio
Michael T. Bacon, Auditor

36-330020.0000
F162

RES
2025

sale

Eff Rate:- 50.59 — 44.66 — 47.03 — 46.74 — a/r

2022 DAVIS CYNTHIA E ETAL	1997-09-26
2023 DAVIS CYNTHIA E ETAL	1997-09-26
2024 DAVIS CYNTHIA E ETAL	1997-09-26
2025 DAVIS CYNTHIA E ETAL	1997-09-26
610 KOHLER ST	1CT CARYS W PT OL 30
	1CT SEE PCL 36-330020.01 FOR
	\$0 REST OF SPECIAL ASSESMEN
KENTON OH 43326	

Tax Year	2022	2023	2024	2025	CAMA
Prop Cls	510	510	510	510	510
Acres					
Land100%	7910	11200	11200	11200	11200
Bldg100%	9110	7860	7860	7860	7870
Totl100%	17030t	19060t	19060t	19060t	19070t
Cauvl00%					
Tax Value:					
Land 35%	2770	3920	3920	3920	3920
Bldg 35%	3190	2750	2750	2750	2750
Totl 35%	5960t	6670t	6670t	6670t	6670t
Hmstd35%					
Owner Oc					
Hmstd RB					
Net Tax	278.42	274.24	290.14	288.22	
Sp-Asmnt	21.00	28.00	24.00	27.00	

SHB+ 1 B	CONS F	TYPE M	FACT P	SQ-FT 984	VALUE 3840	a *MAIN
	EFP	P	P	96	3600	b PORCH
	OFF	P	P	120	3600	c PORCH
Sale# 405	#p 1	sale date 1997-09-26	To DAVIS CYNTHIA E ETAL	Type/Invalid? 1CT *	Sale\$ 0	co:land 6570
						co:bldg 20370
Year 2021	Land 2770	Bldg 3190	Total 5960	Net Tax 279.42		
2020	2770	3190	5960	242.70		

project	ben acres	/	%	factor
921 BLANCHARD RIVER MAINT				XA/2023
500 HARDIN COUNTY LANDFILL				XA/2025
131 BLANCHARD RIVER MAINT				XA/2025
235 KELLOGG #983 - BLANCHARD				XA/2025
336 DULIN #1099 - BLANCHARD MAIN				XA/2025

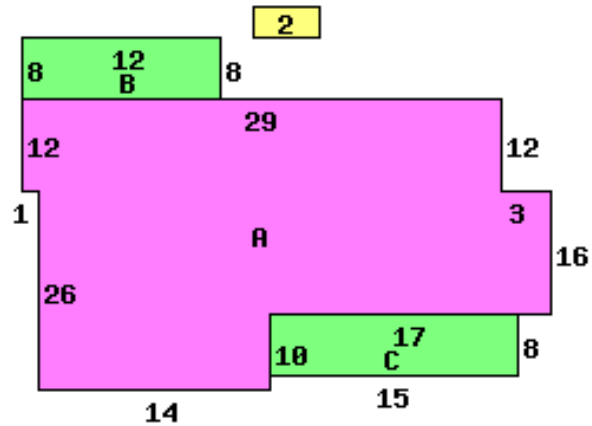

610 KOHLER ST 43326

Occupancy 1 Single Family	*DWELLING COMPUTATIONS
Story Height 1	Sq-Ft Value
Floor Level	
Main	FRAME 984 103300
Basement	492 9420
Subtotal	112720
Shingle	Roof HIP
Plaster/Drywall	X
Unfinished Wall	X
Floor/Pine	X
Number of Rooms	1 5
Bedrooms	2
Central Heat	A
FORCED AIR	
Plumbing	
Standard	1
Extra Features	7440
Total Value	120160
PUB PAVED ST/RD	
Neighborhood:	
Code:	3670
Dwl/Gar/NC%	1.0900

Bldg Type	SHB+Cons	DixHt	Unit	Blt/Renov	Replace	Phy	Fnc	True
1 DWELLING	1 B F	FtxFt	Area	Grade	Cond	Value	Dpr	Dpr
2 Garage	CB 0	30X22	984	C-	OLD/VP	108140	.85	.75
			660	C	OLD/VP	15840	.80	
front lot	acres/	effective	depth	actual	effective	extended	true	
	frontage	frontage	depth	factor	rate	value	value	
		80.00	250	117	120	140	11200	11200