

PLEASANT TWP
KENTON CORP

00350

Hardin County, Ohio
Michael T. Bacon, Auditor

36-330020.0000
F162

RES
2025

sale

Eff Rate:- 50.59 — 44.66 — 47.03 — 46.74 — a/r

2022	DAVIS CYNTHIA E ETAL	1997-09-26
2023	DAVIS CYNTHIA E ETAL	1997-09-26
2024	DAVIS CYNTHIA E ETAL	1997-09-26
2025	DAVIS CYNTHIA E ETAL	1997-09-26
610 KOHLER ST		1CT CARYS W PT OL 30
KENTON OH 43326		1CT SEE PCL 36-330020.01 FOR REST OF SPECIAL ASSESSMEN
		\$0

Tax Year	2022	2023	2024	2025	CAMA
Prop Cls	510	510	510	510	510
Acres					
Land100%	7910	11200	11200	11200	11200
Bldg100%	9110	7860	7860	7860	7870
Totl100%	17030t	19060t	19060t	19060t	19070t
Cauvl00%					
Tax Value:					
Land 35%	2770	3920	3920	3920	3920
Bldg 35%	3190	2750	2750	2750	2750
Totl 35%	5960t	6670t	6670t	6670t	6670t
Hmstd35%					
Owner Oc					
Hmstd RB					
Net Tax	278.42	274.24	290.14	288.22	
Sp-Asmnt	21.00	28.00	24.00	27.00	

SHB+	CONS	TYPE	FACT	SQ-FT	VALUE	a	*MAIN
1	B	F	M	984			
		EFP	P	96	3840	b	PORCH
		OFF	P	120	3600	c	PORCH

Sale#	#p	sale date	To	Type/Invalid?	Sale\$	co:land	co:bldg
405	1	1997-09-26	DAVIS CYNTHIA E ETAL	1CT *	0	6570	20370

Year	Land	Bldg	Total	Net Tax
2021	2770	3190	5960	279.42
2020	2770	3190	5960	242.70

project	ben acres	/	%	factor
921 BLANCHARD RIVER MAINT				XA/2023
500 HARDIN COUNTY LANDFILL				XA/2025
131 BLANCHARD RIVER MAINT				XA/2025
235 KELLOGG #983 - BLANCHARD				XA/2025
336 DULIN #1099 - BLANCHARD MAIN				XA/2025

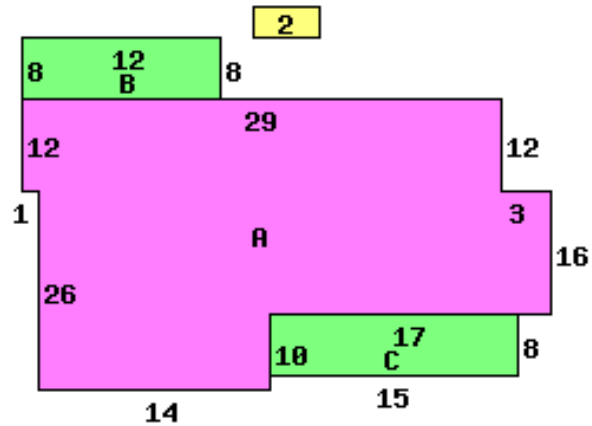

610 KOHLER ST 43326

Occupancy 1 Single Family	*DWELLING COMPUTATIONS
Story Height 1	Sq-Ft Value
Floor Level	Main FRAME 984 103300
	Basement 492 9420
Shingle	Subtotal 112720
	Roof HIP
Plaster/Drywall	X
Unfinished Wall	X
Floor/Pine	X
Number of Rooms	1 5
Bedrooms	2
Central Heat	A
FORCED AIR	
Plumbing	
Standard	1
Extra Features	7440
Total Value	120160
PUB PAVED ST/RD	
Neighborhood:	
Code:	3670
Dwl/Gar/NC%	1.0900

Bldg Type	SHB+Cons	DixHt	Unit	Blt/Renov	Replace	Phy	Fnc	True
1 DWELLING	1 B F			C-	OLD/VP	.85	.75	4420
2 Garage	CB 0	30X22	660	C	OLD/VP	.80		3450
front lot	acres/	effective	depth	actual	effective	extended	true	
	frontage	frontage	depth	factor	rate	value	value	
		80.00	250	117	120	140	11200	11200