

PLEASANT TWP  
KENTON CORP

00350

Hardin County, Ohio  
Michael T. Bacon, Auditor

36-290027.0000  
Y61

RES  
2025

sale

Eff Rate:- 50.59 — 44.66 — 47.03 — 46.74 — a/r

2022 AGEE LEANN M	2004-08-17
2023 SMITH DARIAN M & DANI	2022-02-01
2024 SMITH DARIAN M & DANI	2022-02-01
2025 SMITH DARIAN M & DANIEL	2022-02-01 DAUGHTERTYS 43
533 N MAIN ST	1SD SEE PC 36-290027.01 FOR
KENTON OH 43326	\$115,000 REST OF SPECIAL ASSESS

Tax Year	2022	2023	2024	2025	CAMA
Prop Cls	510	510	510	510	510
Acres	8740	9970	9970	9970	9970
Land100%	86090	92290	92290	92290	92290
Bldg100%	94830t	102260t	102260t	102260t	102260t
Totl100%					
Cauv100%					
Tax Value:					
Land 35%	3060	3490	3490	3490	3490
Bldg 35%	30130	32300	32300	32300	32300
Totl 35%	33190t	35790t	35790t	35790t	35790t
Hmstd35%					
Owner Oc	32.20			31.56	
Hmstd RB					
Net Tax	1518.20	1471.54	1556.76	1514.94	
Sp-Asmnt	21.00	25.00	21.00	24.00	

SHB+	CONS	TYPE	FACT	SQ-FT	VALUE	a	*MAIN
1 BA	F	M		1174			ADDTN
1	F/C	A		216			GRAGE
	F	G		391	9380		PORCH
	CAN	P		67	540		PORCH
	PAT	P		216	650		PORCH
	STP	P		67	270		PORCH

gas fireplace

Sale#	#p	sale date	To	Type/Invalid?	Sale\$	co:land	co:bldg
58	1	2022-02-01	SMITH DARIAN M & DANIELLE	1SD	115000	8740	86090
506	1	2004-08-17	AGEE LEANN M	1WD	85500	7370	55140

Year	Land	Bldg	Total	Net Tax
2021	3060	30130	33190	1523.88
2020	3060	30130	33190	1319.14

project	ben acres	%	factor
131 BLANCHARD RIVER MAINT			XA/2025
500 HARDIN COUNTY LANDFILL			XA/2025
921 BLANCHARD RIVER MAINT			XA/2023
235 KELLOGG #983 - BLANCHARD			XA/2025

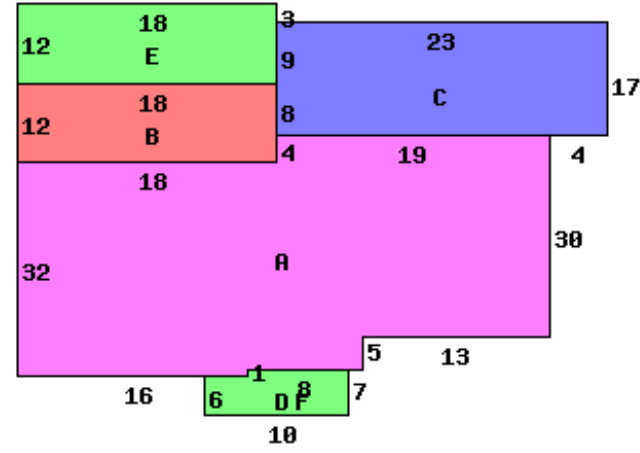

533 N MAIN ST 43326

Occupancy 1 Single Family		*DWELLING COMPUTATIONS	
Story Height	1	Sq-Ft	Value
Floor Level	Main	FRAME	1390 110560
	Qtr Story	FRAME	1174 4480
	Basement		854 15950
	Subtotal		130990
Shingle	Roof	GABLE	
	B 1 2 U A		
Plaster/Drywall	X	Air Conditioning	2420
Unfinished Wall	X	Plumbing	1400
Floor/Hardwood	X	Garages and Carports	9380
Floor/Pine	X	Extra Features	1460
Floor/Carpet	X	Total Value	145650
Number of Rooms	1 6		
Bedrooms	1	PUB SIDEWALK	
Central Heat	A	Neighborhood:	
FORCED AIR		Code:	3720
Central A/C	A	Dwl/Gar/NC%	.9600
Plumbing			
Standard	1		
Extra 2 Fixture	1		

Bldg Type	SHB+Cons	DixHt	Area	Unit	Blt/Renov	Replace	Phy	Fnc	True	
1 DWELLING	1 B F	FtxFt	1390	Rate	Grade	Cond	Value	Dpr	Dpr	Value
		effective	depth	depth	actual	effective	extended			true
front lot	58.5000	59.00	132	94	180	169	9970			9970

Call Back:

Sign: PSN Date: 2015-04-23 Lister:

36-290027.0000-v082020R