

PLEASANT TWP
KENTON CORP

00350

Hardin County, Ohio
Michael T. Bacon, Auditor

36-280131.0000
YY44

RES
2025

sale

Eff Rate:- 50.59 — 44.66 — 47.03 — 46.74 — a/r

| | | | |
|------|--------------------|------------|----------------------|
| 2022 | MARTINDALE REBECCA | 2003-02-27 | |
| 2023 | MARTINDALE REBECCA | 2003-02-27 | |
| 2024 | MARTINDALE REBECCA | 2003-02-27 | |
| 2025 | MARTINDALE REBECCA | 2003-02-27 | KENTON COURT 131-133 |
| | 390 HAYES AVE | | 1WD |
| | | \$31,000 | |
| | KENTON OH 43326 | | |

| | | | | | |
|------------|--------|--------|---------|--------|-------------|
| Tax Year | 2022 | 2023 | 2024 | 2025 | |
| Prop Cls | 510 | 510 | 510 | 510 | CAMA 510 |
| Acres | | | | | |
| Land100% | 5740 | 8170 | 8170 | 8170 | 8180 |
| Bldg100% | 57540 | 66260 | 66260 | 66260 | 66270 |
| Totl100% | 63290t | 74430t | 74430t | 74430t | 74450t |
| Cauv100% | | | | | |
| Tax Value: | | | | | |
| Land 35% | 2010 | 2860 | 2860 | 2860 | 2860 |
| Bldg 35% | 20140 | 23190 | 23190 | 23190 | 23190 |
| Totl 35% | 22150t | 26050t | 26050t | 26050t | 26060t |
| Hmstd35% | | | | | |
| Owner Oc | 21.48 | 23.06 | 23.02 | 22.96 | |
| Hmstd RB | 400.22 | 368.96 | 417.58 | 429.66 | |
| Net Tax | 613.00 | 679.06 | 692.50 | 673.00 | |
| Sp-Asmnt | 27.00 | 48.00 | 1882.82 | 36.00 | |

| SHB+ | CONS | TYPE | FACT | SQ-FT | VALUE | a | *MAIN |
|------|------|------|------|-------|-------|---|-------|
| 1 | B | F | M | 840 | | | |
| | | F | G | 448 | 10750 | b | GRAGE |
| | | OFF | P | 48 | 1440 | c | PORCH |
| 1 | | F/C | A | 48 | | d | ADDTN |
| | | PAT | P | 150 | 450 | e | PORCH |

#: 132, 133 L/W
362801320000
362801330000

| Sale# | #p | sale date | To | Type/Invalid? | Sale\$ | co:land | co:bldg |
|-------|----|------------|----------------------|---------------|--------|---------|---------|
| 92 | 1 | 2003-02-27 | MARTINDALE REBECCA | 1WD | 31000 | 4570 | 31890 |
| 601 | 9 | 1997-10-06 | JONES BRUCE M ETAL | 9QC * | 0 | 4800 | 19260 |
| 601 | 7 | 1997-10-06 | JONES NEIL H TRUSTEE | 7AF * | 0 | 4800 | 19260 |
| 750 | 7 | 1995-08-11 | JONES FAMILY TRUST | 7QC * | 0 | 4800 | 17710 |

| Year | Land | Bldg | Total | Net Tax |
|------|------|-------|-------|---------|
| 2021 | 2010 | 20140 | 22150 | 615.26 |
| 2020 | 2010 | 20140 | 22150 | 532.60 |

| Project | | ben acres | % | factor |
|---------|------------------------------|-----------|---|---------|
| 500 | HARDIN COUNTY LANDFILL | | | XA/2025 |
| 131 | BLANCHARD RIVER MAINT | | | XA/2025 |
| 921 | BLANCHARD RIVER MAINT | | | XA/2023 |
| 336 | DULIN #1099 - BLANCHARD MAIN | | | XA/2025 |

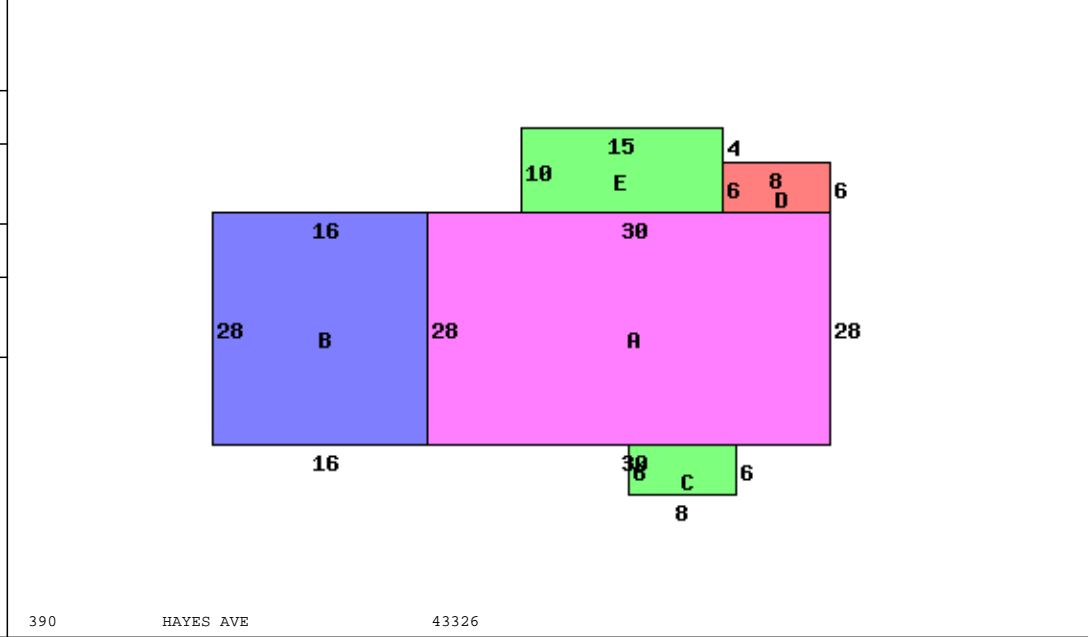

| | | |
|-----------------|-----------------|----------------------------|
| Occupancy | 1 Single Family | *DWELLING COMPUTATIONS |
| Story Height | 1 | Sq-Ft Value |
| Floor Level | Main | FRAME 888 101210 |
| | Basement | 420 8070 |
| | Subtotal | 109280 |
| Shingle | Roof | GABLE |
| | B 1 2 U A | |
| Plaster/Drywall | P | Plumbing 1400 |
| Panelled Wall | X | Garages and Carports 10750 |
| Unfinished Wall | X | Extra Features 1890 |
| Floor/Pine | X | Total Value 123320 |
| Floor/Carpet | X | |
| Floor/Concrete | X | |
| Number of Rooms | 1 4 | Neighborhood: |
| Bedrooms | 2 | Code: 3670 |
| Central Heat | A | Dwl/Gar/NC% 1.0900 |
| FORCED AIR | | |
| Plumbing | | |
| Standard | 1 | |
| Extra 2 Fixture | 1 | |

| Bldg Type | SHB+Cons | DixHt | Unit | Blt/Renov | Replace | Phy Fnc | True |
|------------|----------|-----------|-------|-----------|-----------|----------|-------|
| 1 DWELLING | 1 B F | FtxFt | Area | Grade | Cond | Dpr Dpr | Value |
| | | 888 | 888 | D+ | 1960AV | 104820 | 66270 |
| front lot | acres/ | effective | depth | actual | effective | extended | true |
| | frontage | frontage | depth | rate | rate | value | value |
| | | 75.00 | 125 | 91 | 120 | 109 | 8180 |

| | | | |
|------------|----------------------------|---------|-------------------------|
| Call Back: | Sign: PSN Date: 2015-02-06 | Lister: | 36-280131.0000-v082020R |
|------------|----------------------------|---------|-------------------------|